

# 3-DOOR STANDARD BAKERY CASE



140 Park Street • Milo, Maine 04463 • 800.332.5507 TEL • 207.943.5632 FAX • [JSISTOREFIXTURES.COM](http://JSISTOREFIXTURES.COM)  
Milo, Maine • Bangor, Maine • Suwanee, Georgia • Payson, Utah • Greenville, South Carolina • Collingwood, Ontario

# 3-DOOR STANDARD BAKERY CASE

## DESCRIPTION

Our Bakery Cases are built for presentation. The doors match standard tray widths allowing for easier merchandising and customer access. Standard LED lighting provides an energy-efficient, long-lasting lighted display. Our modular shelving design makes daily cleaning quick and easy.

## 3-DOOR STANDARD BAKERY CASE WITH OPTIONAL BUMPER

### FEATURES

- 4 Adjustable Wire Shelves with PTM
- Capacity: (12) Standard 18"W X 26"D Pastry Trays
- Package Ledge with Bag/Box Storage and 2 Adjustable Dividers
- LED Lighting on 3 Shelves & Canopy
- Black Tissue Holder and Trash Receptacle
- Mirrored Plexi on Interior Side Panels
- Available with Solid Back Panel or Sliding Rear Doors
- Variety of Materials/Finishes/Options

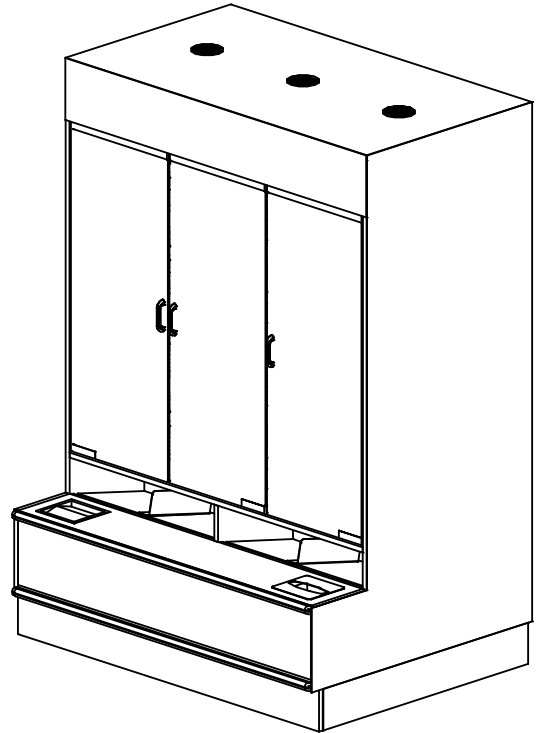

## APPLICATIONS

- Use as a Stand-Alone for Loose and Packaged items or in an Island Setting

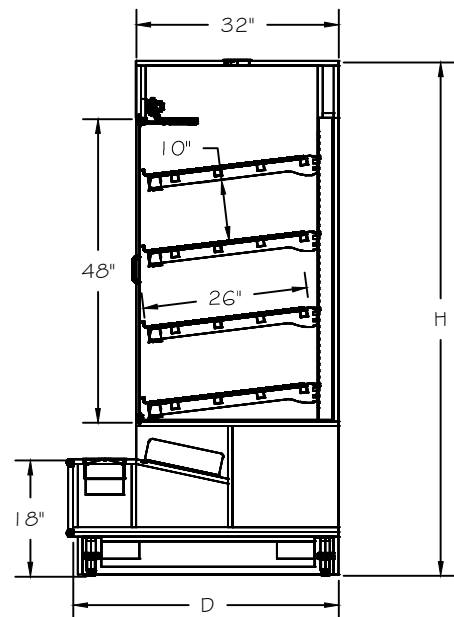
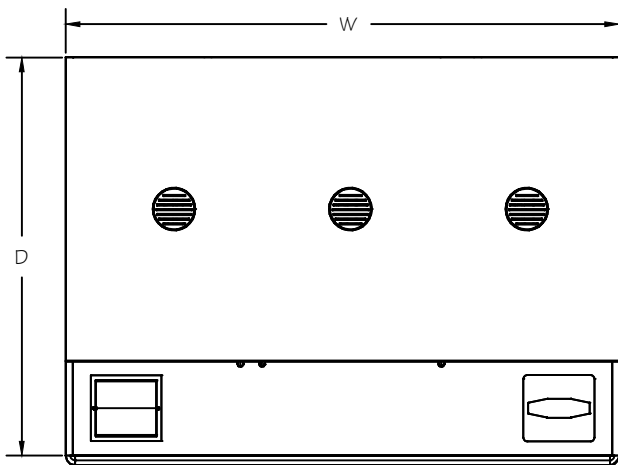

See our 2-door and 4-door specification sheets for alternate capacity needs.

STYLE	ITEM #	SIZES W x D x H
3-DOOR STANDARD BAKERY CASE	C-DC3-594281	58½" X 42" X 81"

### MATERIALS, FINISHES, FOAM, AND ACCESSORIES

Please refer to our "Styles, Groupings, Stains, and Accessories" brochure to see our wide range of materials, finishes, and accessories.