

# Canopy Style: 5 x 2 Stacked

Canopy Size: 43' x 160'

Initial Levels at grade and vertically on pumps.

## (18) SCV-LED-15L-SC-50

Fixture Lumens: 14,963

Fixture Watts: 102

Lumens/Watt: 147

Mounting Height: 15'

## Calculation Summary

Canopy Average: 26.13

Pump Average Inner: 11.44

Pump Average Outer: 18.65

Transition Average: 2.51

Total Watts: 1836

Watts/sq.ft.: 0.27

Lumens/sq.ft. : 39.1

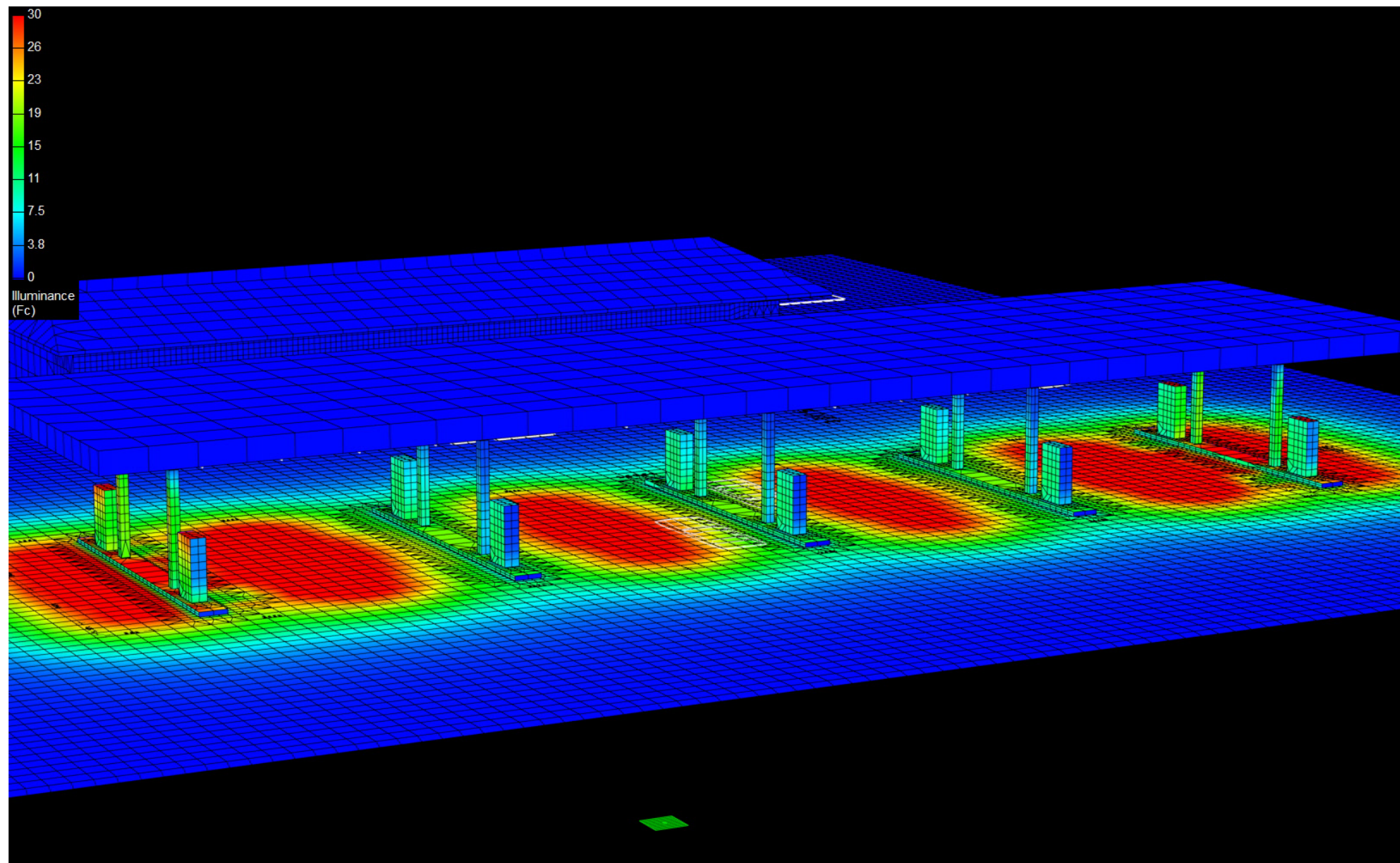

# Canopy Style: 5 x 2 Stacked

Canopy Size: 43' x 160'

Initial Levels at grade and vertically on pumps.

## (18) SCV-LED-15L-SC-50

Fixture Lumens: 14,963

Fixture Watts: 102

Lumens/Watt: 147

Mounting Height: 15'

## Calculation Summary

Canopy Average: 26.13

Pump Average Inner: 11.44

Pump Average Outer: 18.65

Transition Average: 2.51

Total Watts: 1836

Watts/sq.ft.: 0.27

Lumens/sq.ft. : 39.1

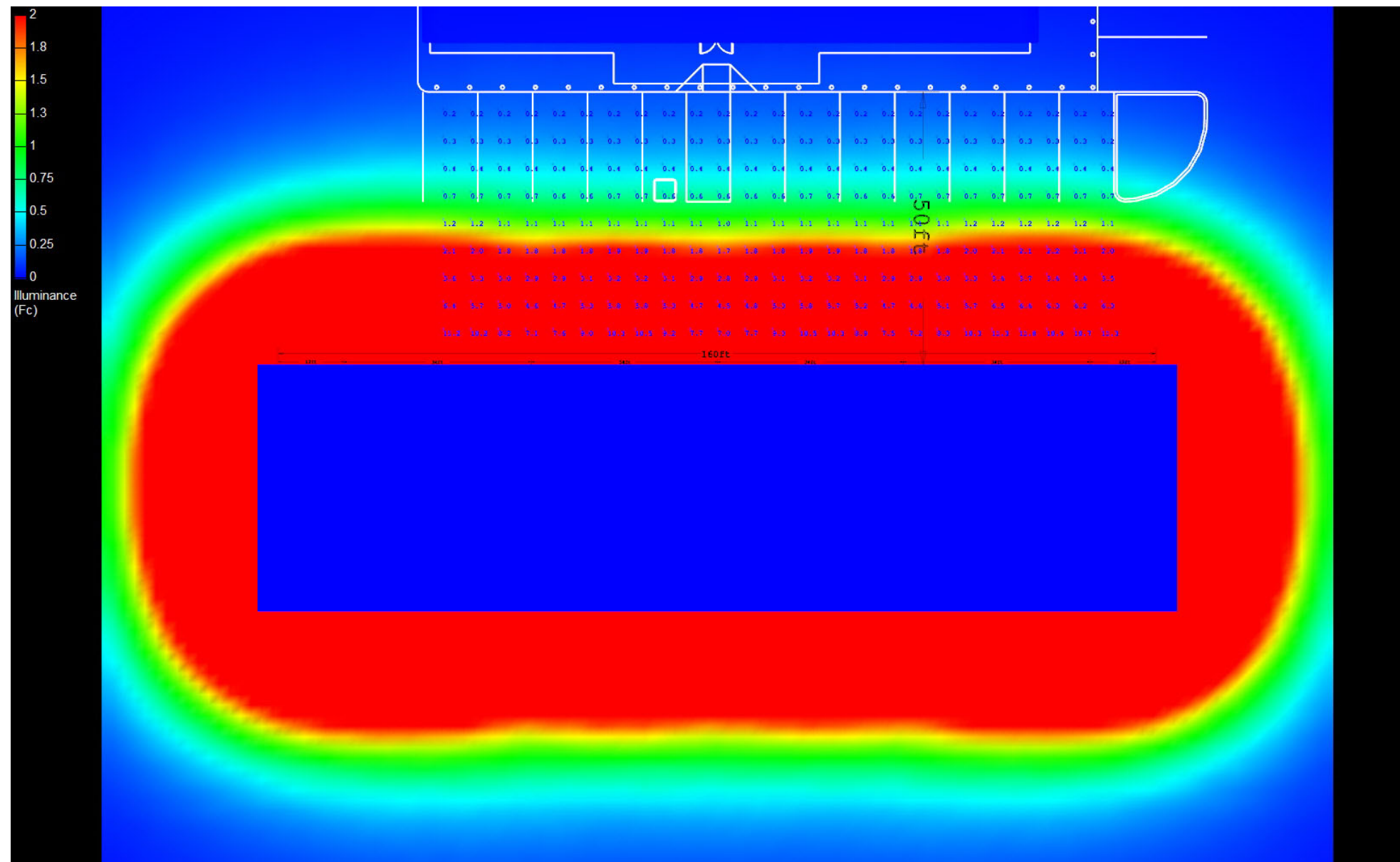

# Canopy Style: 5 x 2 Stacked

Canopy Size: 43' x 160'

Initial Levels at grade and vertically on pumps.

## (18) SCV-LED-15L-SC-50

Fixture Lumens: 14,963

Fixture Watts: 102

Lumens/Watt: 147

Mounting Height: 15'

## Calculation Summary

Canopy Average: 26.13

Pump Average Inner: 11.44

Pump Average Outer: 18.65

Transition Average: 2.51

Total Watts: 1836

Watts/sq.ft.: 0.27

Lumens/sq.ft. : 39.1

