

# Canopy Style: 5 x 2 Stacked

Canopy Size: 43' x 160'

Initial Levels at grade and vertically on pumps.

## (30) SCV-LED-15L-SC-50

Fixture Lumens: 14,963

Fixture Watts: 102

Lumens/Watt: 147

Mounting Height: 15'

## Calculation Summary

Canopy Average: 43.55

Pump Average Inner: 24.05

Pump Average Outer: 19.14

Transition Average: 4.60

Total Watts: 3060

Watts/sq.ft.: 0.45

Lumens/sq.ft. : 65.2

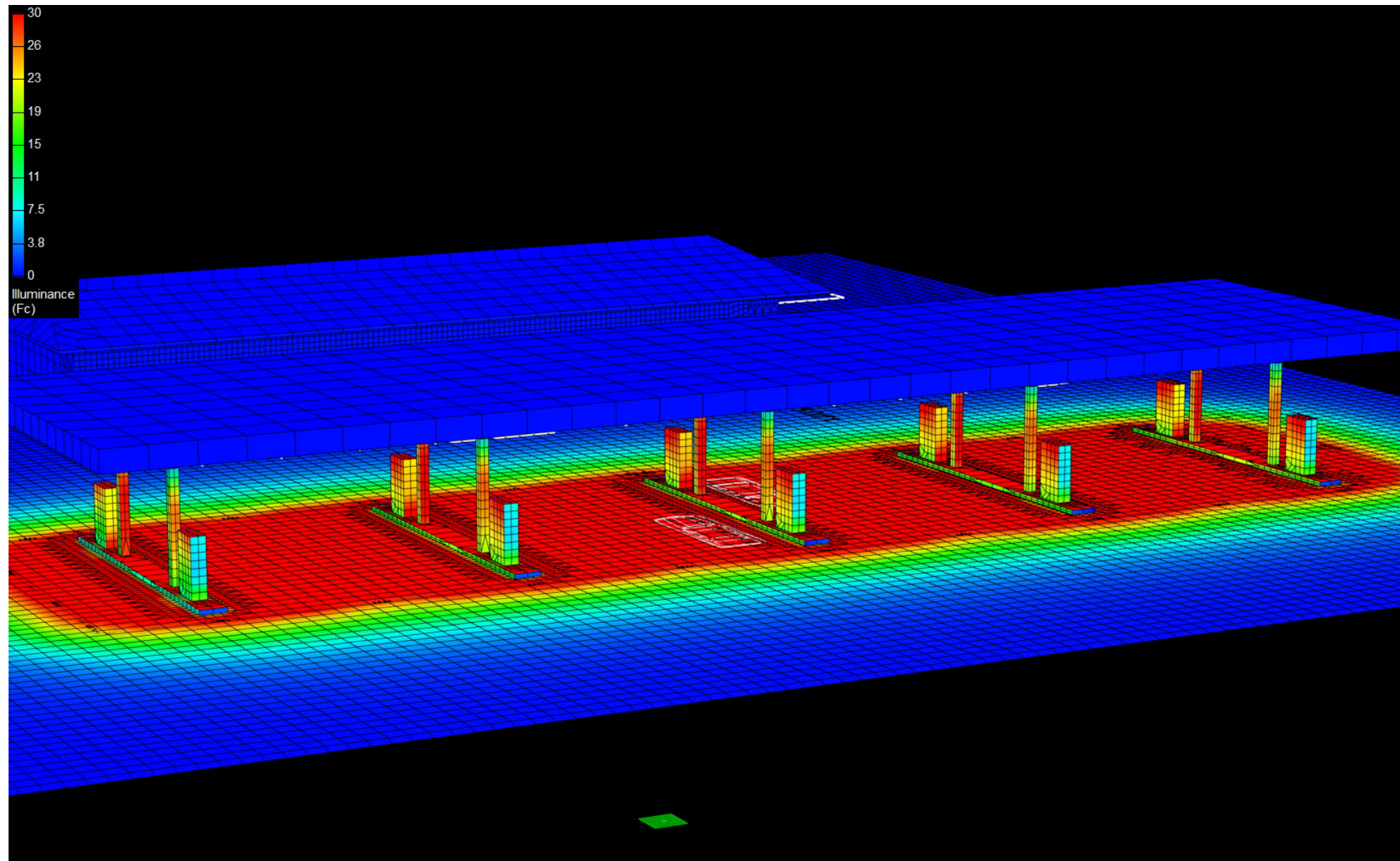

# Canopy Style: 5 x 2 Stacked

Canopy Size: 43' x 160'

Initial Levels at grade and vertically on pumps.

## (30) SCV-LED-15L-SC-50

Fixture Lumens: 14,963

Fixture Watts: 102

Lumens/Watt: 147

Mounting Height: 15'

## Calculation Summary

Canopy Average: 43.55

Pump Average Inner: 24.05

Pump Average Outer: 19.14

Transition Average: 4.60

Total Watts: 3060

Watts/sq.ft.: 0.45

Lumens/sq.ft. : 65.2

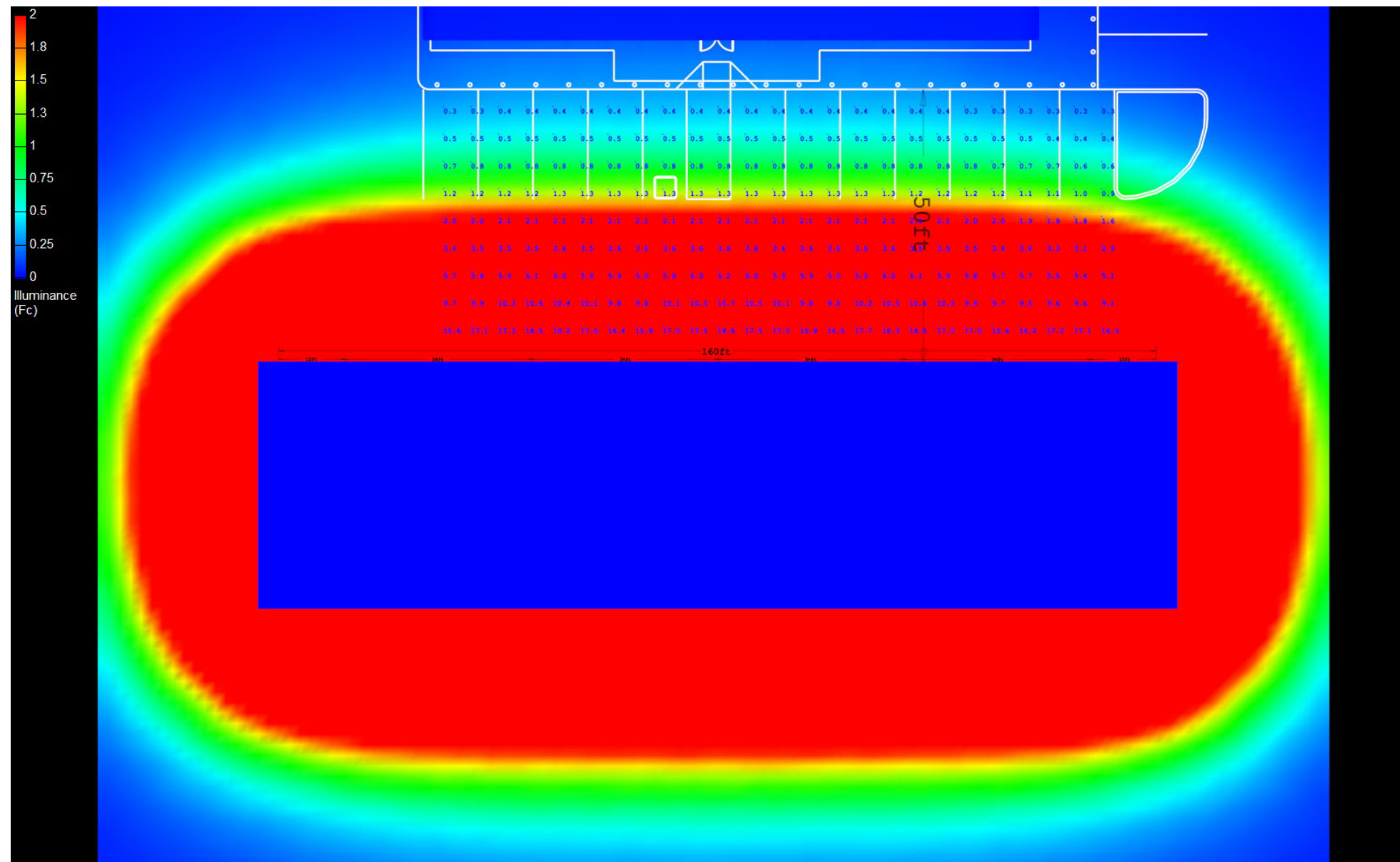



# Canopy Style: 5 x 2 Stacked

Canopy Size: 43' x 160'

Initial Levels at grade and vertically on pumps.

## (30) SCV-LED-15L-SC-50

Fixture Lumens: 14,963

Fixture Watts: 102

Lumens/Watt: 147

Mounting Height: 15'

## Calculation Summary

Canopy Average: 43.55

Pump Average Inner: 24.05

Pump Average Outer: 19.14

Transition Average: 4.60

Total Watts: 3060

Watts/sq.ft.: 0.45

Lumens/sq.ft. : 65.2

