

# Canopy Style: 4x1 Inline w/ Kiosk

Canopy Size: 24' x 120'

Initial Levels at grade and vertically on pumps.

## (12) SCV-LED-10L-SC-50

Fixture Lumens: 10,317

Fixture Watts: 67

Lumens/Watt: 154

Mounting Height: 15'

## Calculation Summary

Canopy Average: 21.94

Pump Average Inner: 11.92

Pump Average Outer: 13.19

Transition Average: N/A

Total Watts: 804

Watts/sq.ft.: 0.28

Lumens/sq.ft. : 43

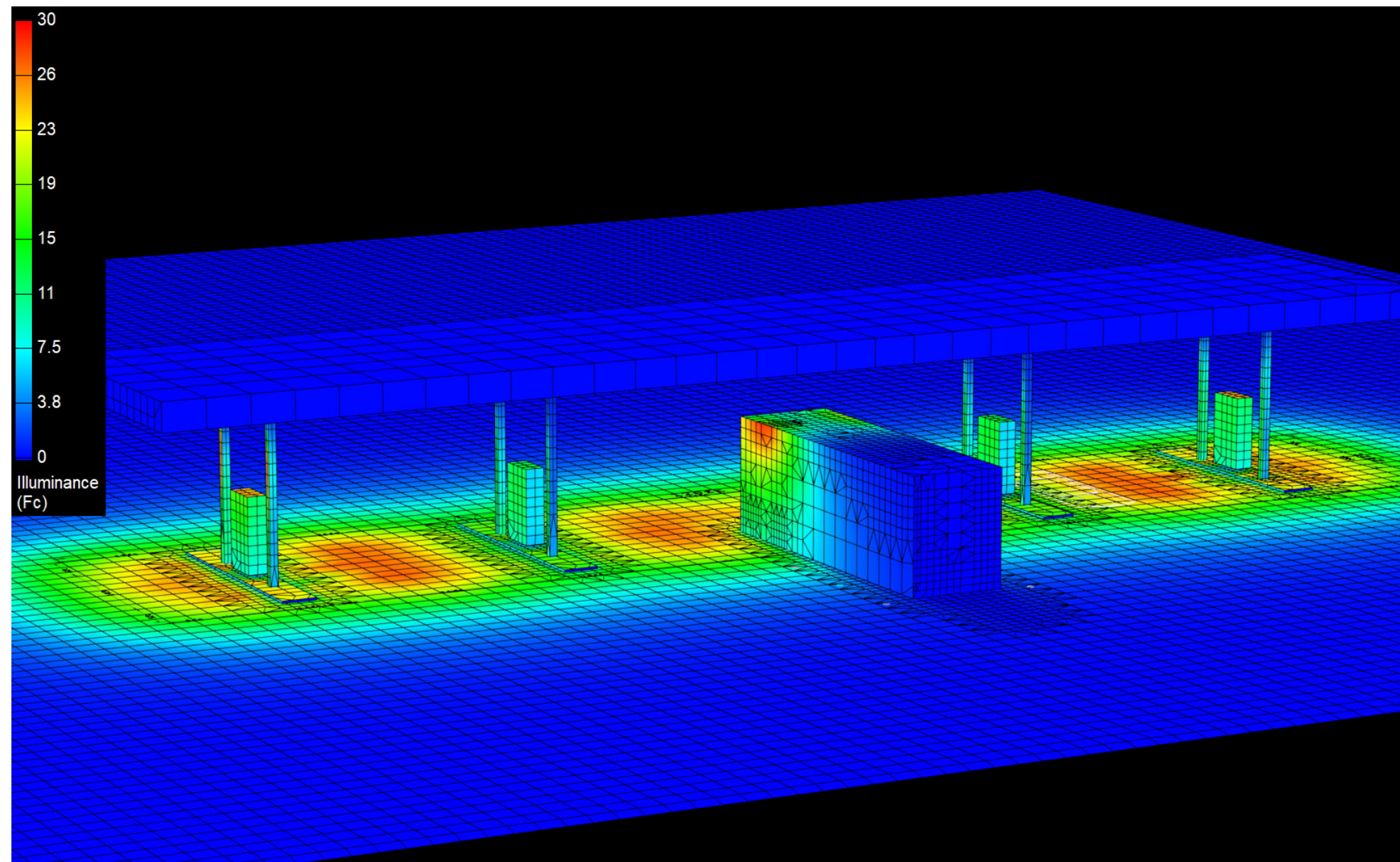

# Canopy Style: 4x1 Inline w/ Kiosk

Canopy Size: 24' x 120'

Initial Levels at grade and vertically on pumps.

## (12) SCV-LED-10L-SC-50

Fixture Lumens: 10,317

Fixture Watts: 67

Lumens/Watt: 154

Mounting Height: 15'

## Calculation Summary

Canopy Average: 21.94

Pump Average Inner: 11.92

Pump Average Outer: 13.19

Transition Average: N/A

Total Watts: 804

Watts/sq.ft.: 0.28

Lumens/sq.ft. : 43

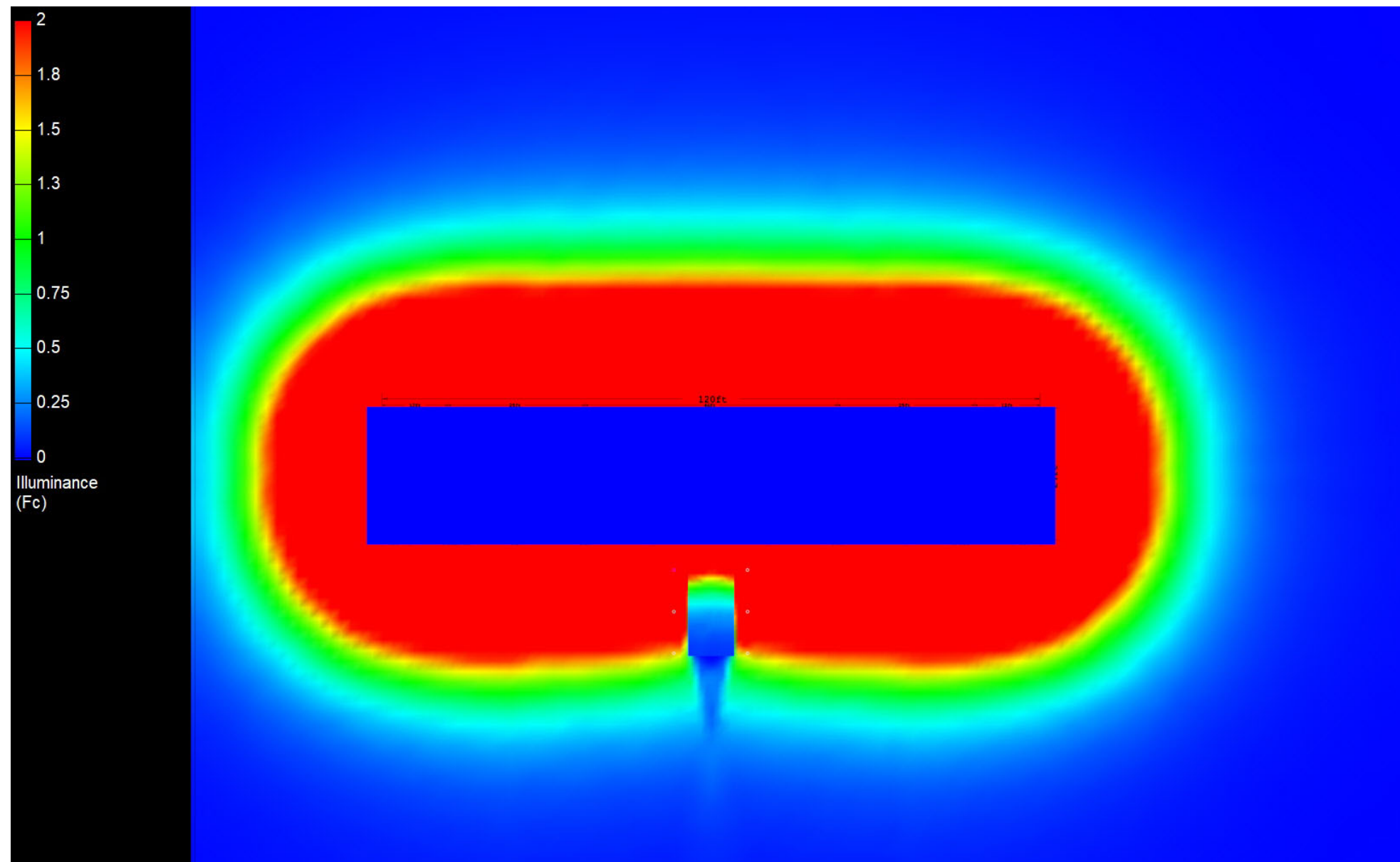

# Canopy Style: 4x1 Inline w/ Kiosk

Canopy Size: 24' x 120'

Initial Levels at grade and vertically on pumps.

## (12) SCV-LED-10L-SC-50

Fixture Lumens: 10,317

Fixture Watts: 67

Lumens/Watt: 154

Mounting Height: 15'

## Calculation Summary

Canopy Average: 21.94

Pump Average Inner: 11.92

Pump Average Outer: 13.19

Transition Average: N/A

Total Watts: 804

Watts/sq.ft.: 0.28

Lumens/sq.ft. : 43

