

Canopy Style: 3x1 Inline w/ Kiosk

Canopy Size: 24' x 95'

Initial Levels at grade and vertically on pumps.

(10) SCV-LED-15L-SC-50

Fixture Lumens: 14,963

Fixture Watts: 102

Lumens/Watt: 147

Mounting Height: 15'

Calculation Summary

Canopy Average: 32.70

Pump Average Inner: 17.56

Pump Average Outer: 19.23

Transition Average: N/A

Total Watts: 1020

Watts/sq.ft.: 0.45

Lumens/sq.ft. : 65.7

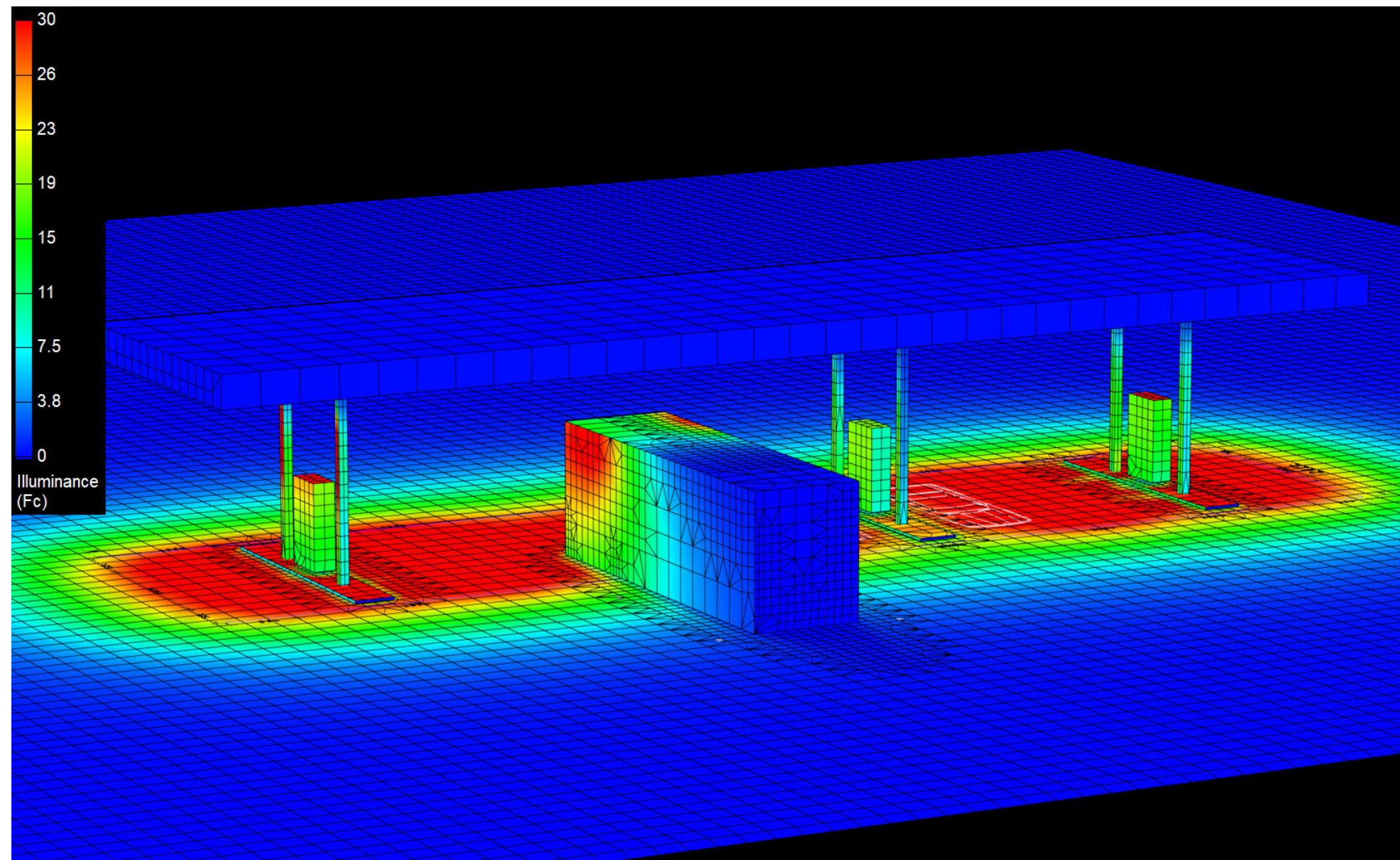

Canopy Style: 3x1 Inline w/ Kiosk

Canopy Size: 24' x 95'

Initial Levels at grade and vertically on pumps.

(10) SCV-LED-15L-SC-50

Fixture Lumens: 14,963

Fixture Watts: 102

Lumens/Watt: 147

Mounting Height: 15'

Calculation Summary

Canopy Average: 32.70

Pump Average Inner: 17.56

Pump Average Outer: 19.23

Transition Average: N/A

Total Watts: 1020

Watts/sq.ft.: 0.45

Lumens/sq.ft. : 65.7

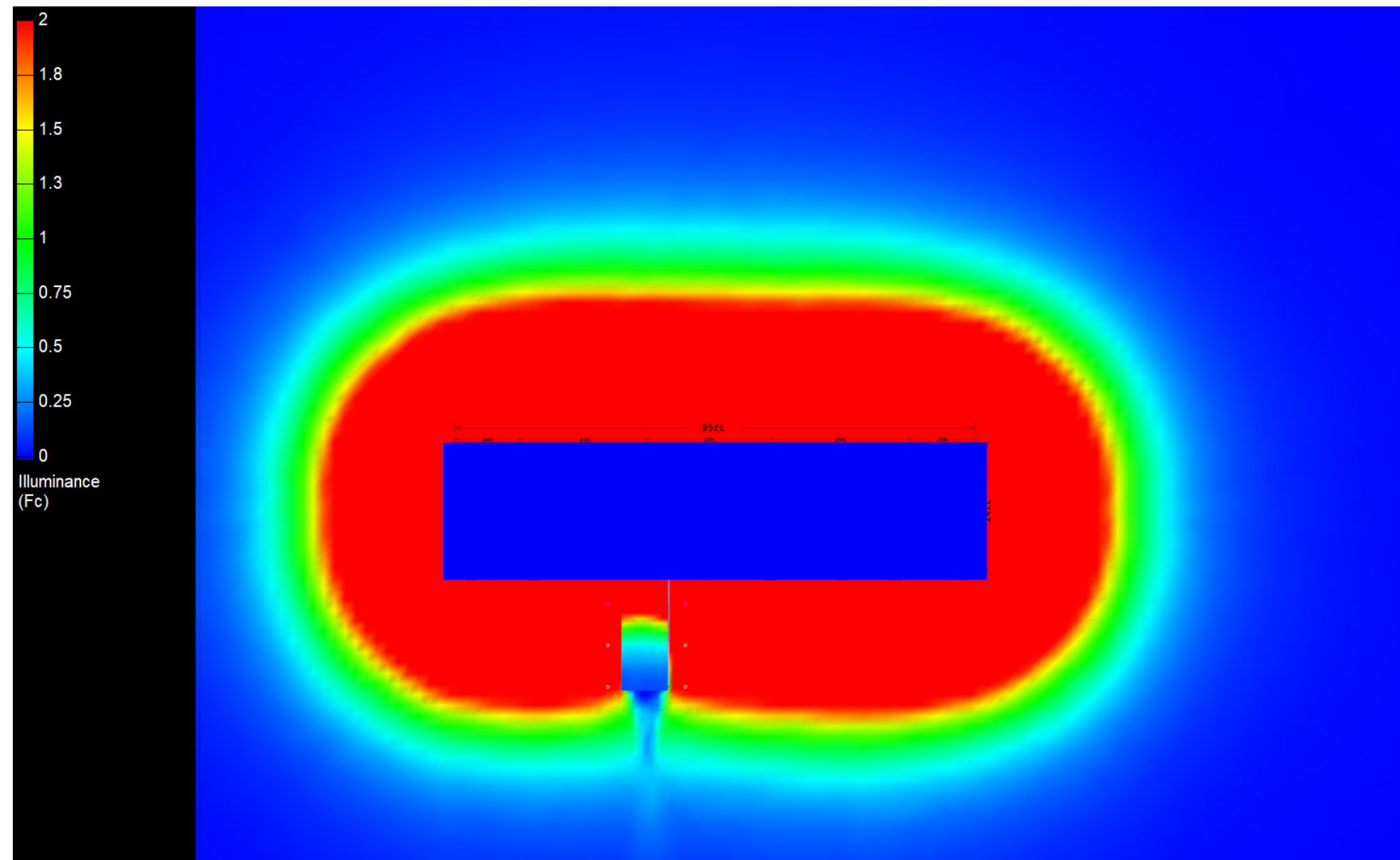

Canopy Style: 3x1 Inline w/ Kiosk

Canopy Size: 24' x 95'

Initial Levels at grade and vertically on pumps.

(10) SCV-LED-15L-SC-50

Fixture Lumens: 14,963

Fixture Watts: 102

Lumens/Watt: 147

Mounting Height: 15'

Calculation Summary

Canopy Average: 32.70

Pump Average Inner: 17.56

Pump Average Outer: 19.23

Transition Average: N/A

Total Watts: 1020

Watts/sq.ft.: 0.45

Lumens/sq.ft. : 65.7

