

# Canopy Style: 3+2+3 w/ Kiosk

Canopy Size: 78' x 92'

Initial Levels at grade and vertically on pumps.

## (20) SCV-LED-23L-SC-50

Fixture Lumens: 23,284

Fixture Watts: 155

Lumens/Watt: 150

Mounting Height: 15'

## Calculation Summary

Canopy Average: 47.08

Pump Average Inner: 21.70

Pump Average Outer: 32.78

Transition Average: N/A

Total Watts: 3100

Watts/sq.ft.: 0.43

Lumens/sq.ft. : 64.8

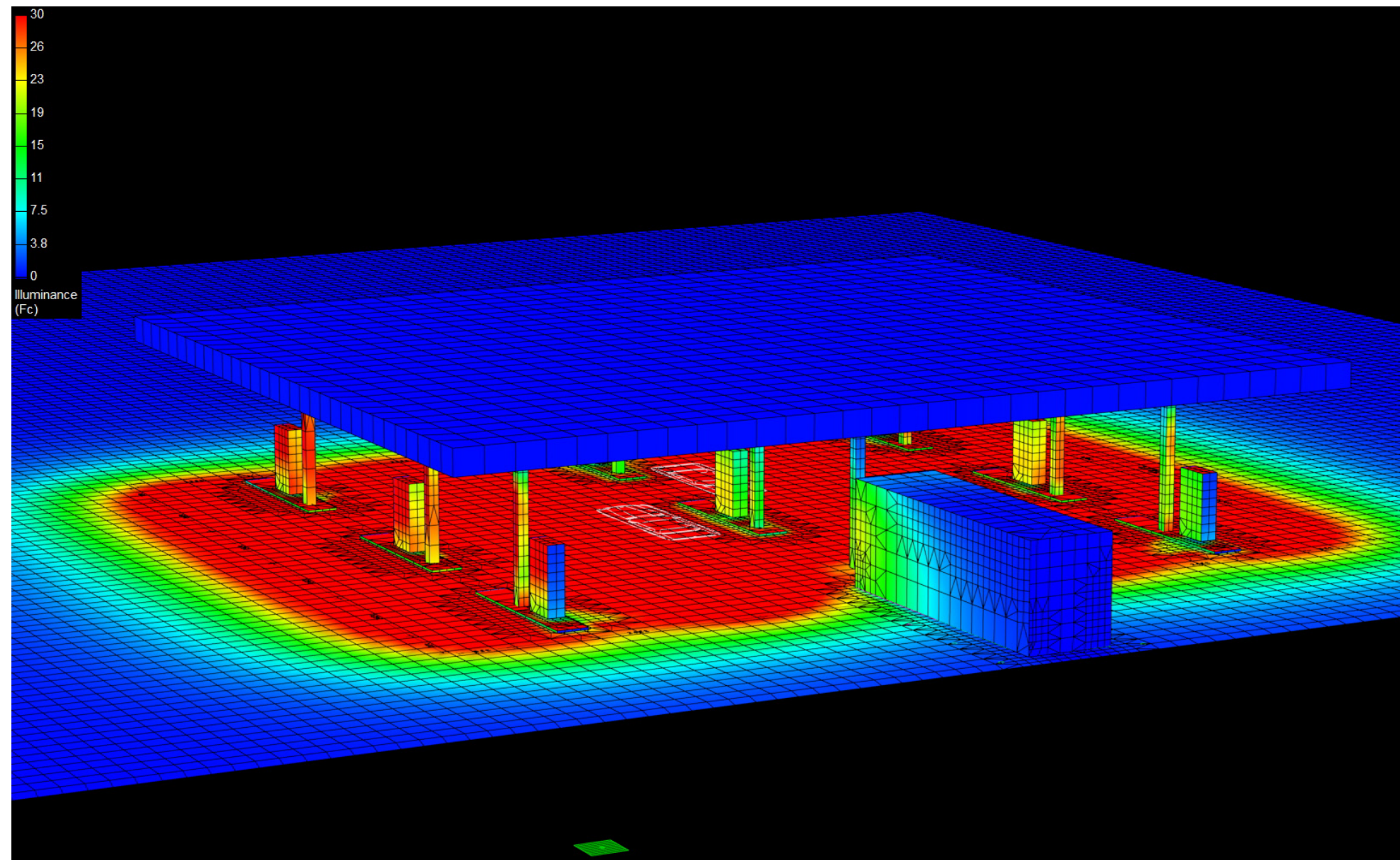

# Canopy Style: 3+2+3 w/ Kiosk

Canopy Size: 78' x 92'

Initial Levels at grade and vertically on pumps.

## (20) SCV-LED-23L-SC-50

Fixture Lumens: 23,284

Fixture Watts: 155

Lumens/Watt: 150

Mounting Height: 15'

## Calculation Summary

Canopy Average: 47.08

Pump Average Inner: 21.70

Pump Average Outer: 32.78

Transition Average: N/A

Total Watts: 3100

Watts/sq.ft.: 0.43

Lumens/sq.ft. : 64.8

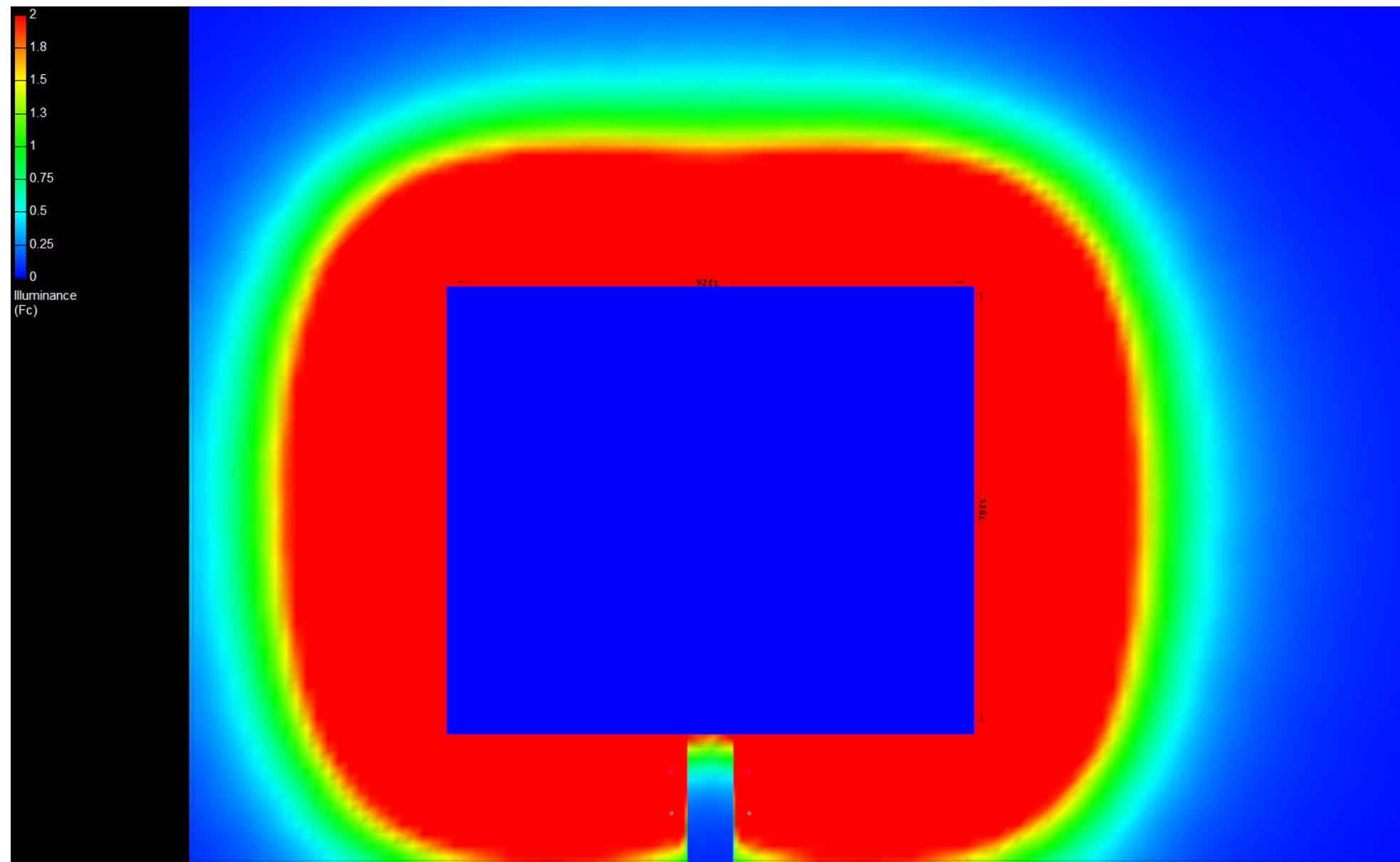

# Canopy Style: 3+2+3 w/ Kiosk

Canopy Size: 78' x 92'

Initial Levels at grade and vertically on pumps.

**(20) SCV-LED-23L-SC-50**

Fixture Lumens: 23,284

Fixture Watts: 155

Lumens/Watt: 150

Mounting Height: 15'

## Calculation Summary

Canopy Average: 47.08

Pump Average Inner: 21.70

Pump Average Outer: 32.78

Transition Average: N/A

Total Watts: 3100

Watts/sq.ft.: 0.43

Lumens/sq.ft. : 64.8



SCV

