

Canopy Style: 2+2+1+2+2 w/ Kiosk

Canopy Size: 43' x 160'

Initial Levels at grade and vertically on pumps.

(30) SCV-LED-15L-SC-50

Fixture Lumens: 14,963

Fixture Watts: 102

Lumens/Watt: 147

Mounting Height: 15'

Calculation Summary

Canopy Average: 43.64

Pump Average Inner: 23.92

Pump Average Outer: 19.11

Transition Average: N/A

Total Watts: 3060

Watts/sq.ft.: 0.45

Lumens/sq.ft. : 65.3

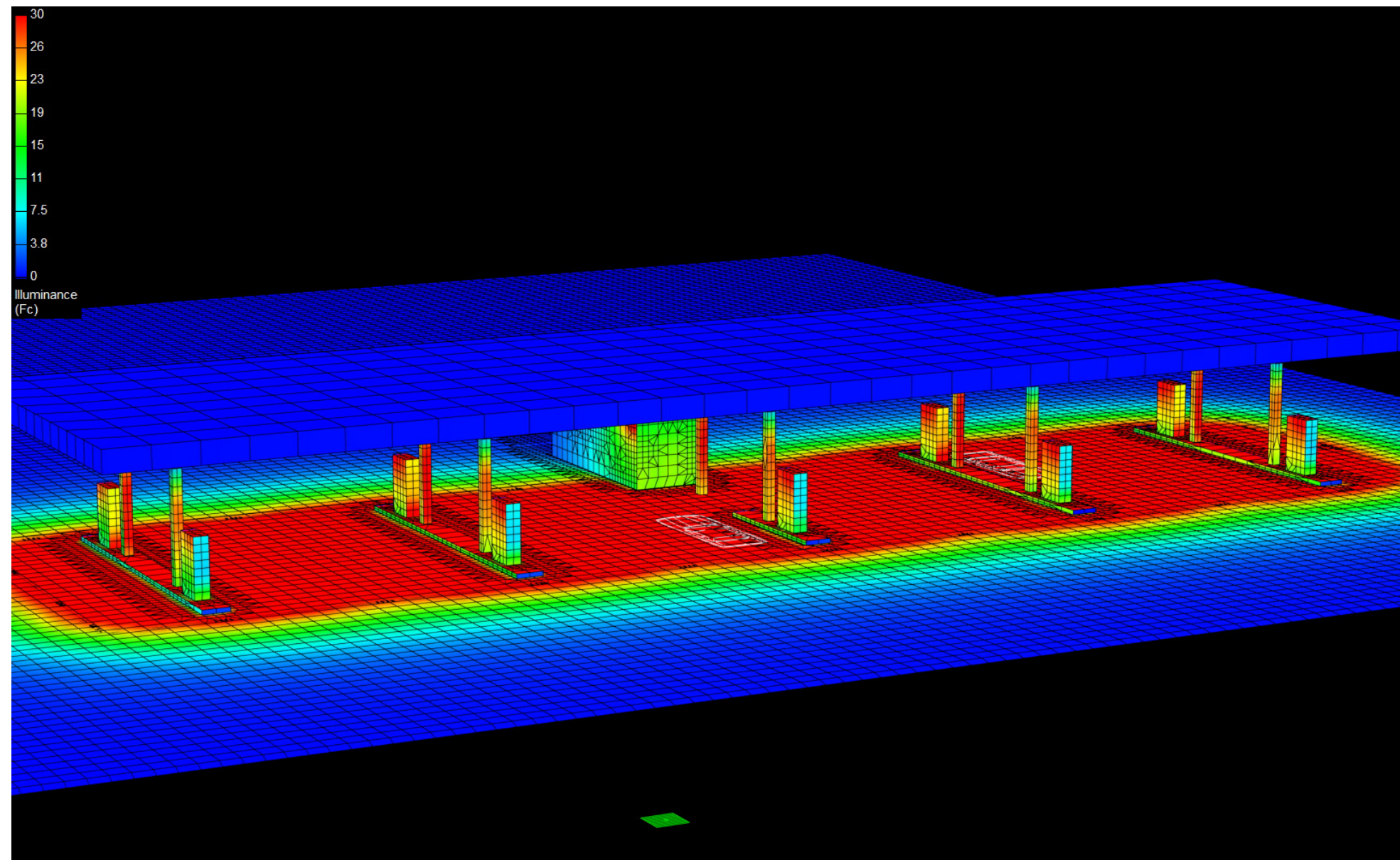

Canopy Style: 2+2+1+2+2 w/ Kiosk

Canopy Size: 43' x 160'

Initial Levels at grade and vertically on pumps.

(30) SCV-LED-15L-SC-50

Fixture Lumens: 14,963

Fixture Watts: 102

Lumens/Watt: 147

Mounting Height: 15'

Calculation Summary

Canopy Average: 43.64

Pump Average Inner: 23.92

Pump Average Outer: 19.11

Transition Average: N/A

Total Watts: 3060

Watts/sq.ft.: 0.45

Lumens/sq.ft. : 65.3

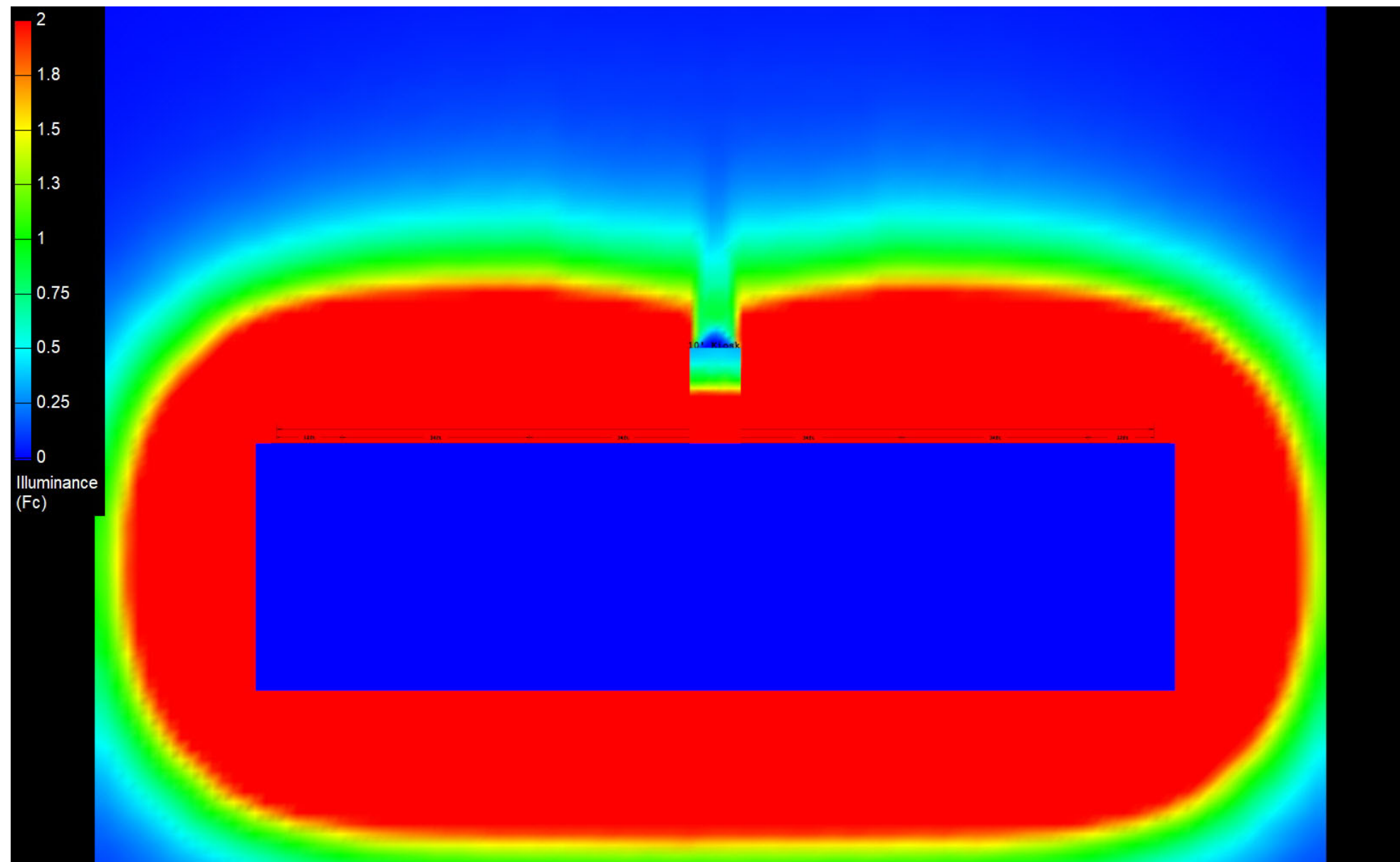

Canopy Style: 2+2+1+2+2 w/ Kiosk

Canopy Size: 43' x 160'

Initial Levels at grade and vertically on pumps.

(30) SCV-LED-15L-SC-50

Fixture Lumens: 14,963

Fixture Watts: 102

Lumens/Watt: 147

Mounting Height: 15'

Calculation Summary

Canopy Average: 43.64

Pump Average Inner: 23.92

Pump Average Outer: 19.11

Transition Average: N/A

Total Watts: 3060

Watts/sq.ft.: 0.45

Lumens/sq.ft. : 65.3

