

# Canopy Style: 2+2+1+2+2 w/ Kiosk

Canopy Size: 43' x 160'

Initial Levels at grade and vertically on pumps.

## (18) SCV-LED-13L-SC-50

Fixture Lumens: 13,444

Fixture Watts: 90

Lumens/Watt: 149

Mounting Height: 15'

## Calculation Summary

Canopy Average: 23.47

Pump Average Inner: 10.24

Pump Average Outer: 16.86

Transition Average: N/A

Total Watts: 1620

Watts/sq.ft.: 0.24

Lumens/sq.ft. : 35.2

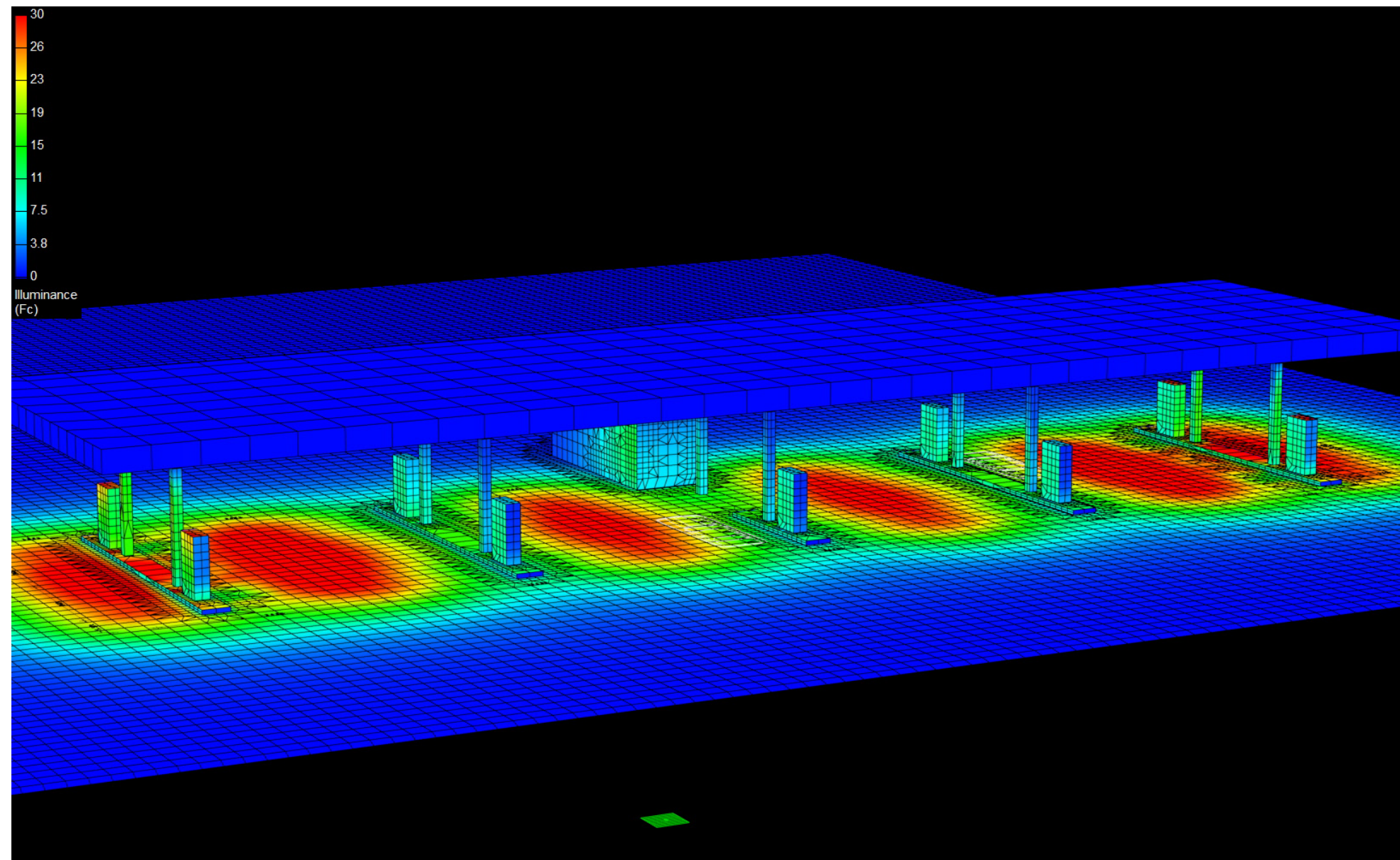

# Canopy Style: 2+2+1+2+2 w/ Kiosk

Canopy Size: 43' x 160'

Initial Levels at grade and vertically on pumps.

## (18) SCV-LED-13L-SC-50

Fixture Lumens: 13,444

Fixture Watts: 90

Lumens/Watt: 149

Mounting Height: 15'

## Calculation Summary

Canopy Average: 23.47

Pump Average Inner: 10.24

Pump Average Outer: 16.86

Transition Average: N/A

Total Watts: 1620

Watts/sq.ft.: 0.24

Lumens/sq.ft. : 35.2

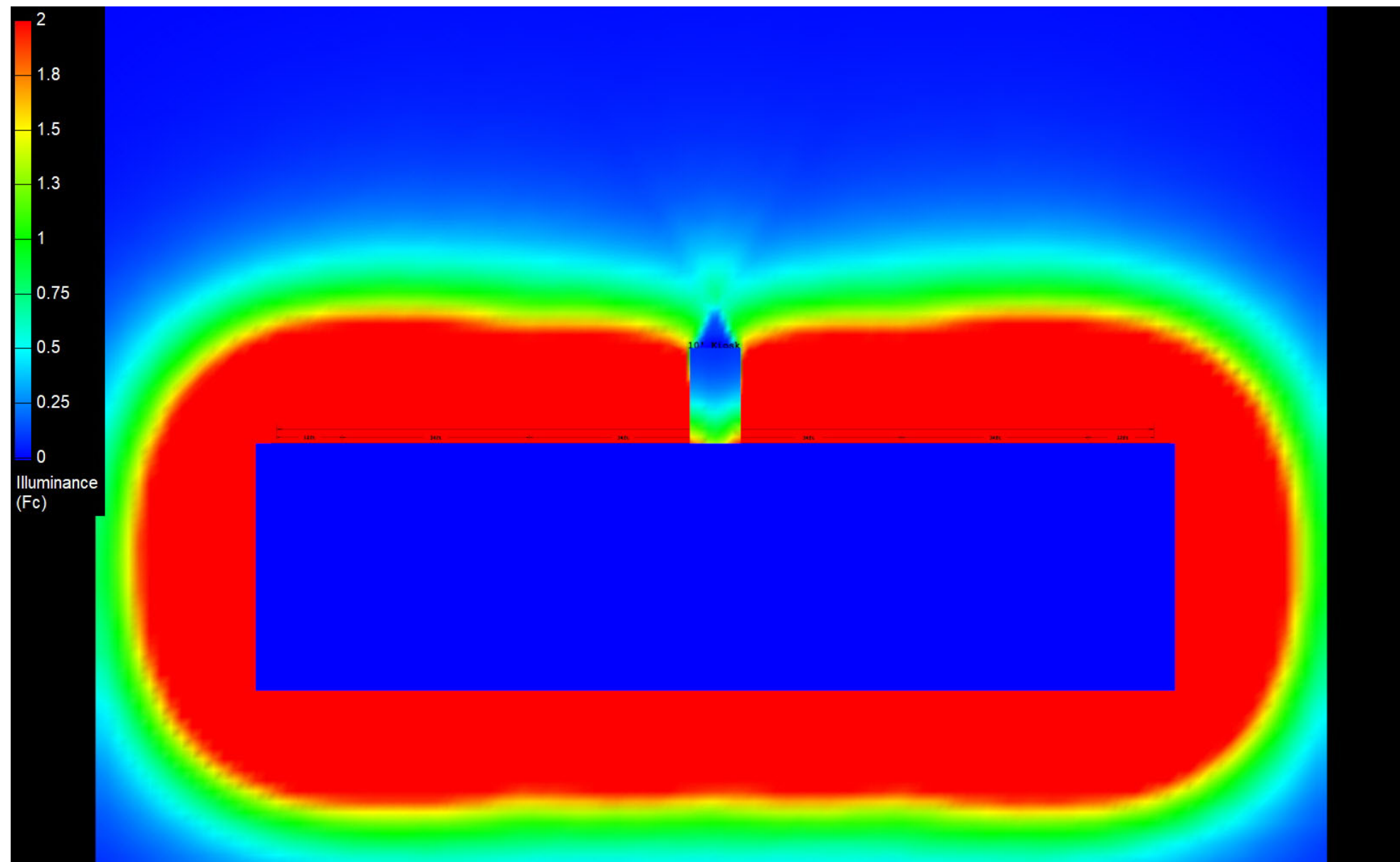

# Canopy Style: 2+2+1+2+2 w/ Kiosk

Canopy Size: 43' x 160'

Initial Levels at grade and vertically on pumps.

## (18) SCV-LED-13L-SC-50

Fixture Lumens: 13,444

Fixture Watts: 90

Lumens/Watt: 149

Mounting Height: 15'

## Calculation Summary

Canopy Average: 23.47

Pump Average Inner: 10.24

Pump Average Outer: 16.86

Transition Average: N/A

Total Watts: 1620

Watts/sq.ft.: 0.24

Lumens/sq.ft. : 35.2

