

Canopy Style: 2+2+1+2+2 w/ Kiosk

Canopy Size: 43' x 160'

Initial Levels at grade and vertically on pumps.

(30) SCV-LED-13L-SC-50

Fixture Lumens: 13,444

Fixture Watts: 90

Lumens/Watt: 149

Mounting Height: 15'

Calculation Summary

Canopy Average: 39.18

Pump Average Inner: 21.49

Pump Average Outer: 17.16

Transition Average: N/A

Total Watts: 2700

Watts/sq.ft.: 0.39

Lumens/sq.ft. : 58.6

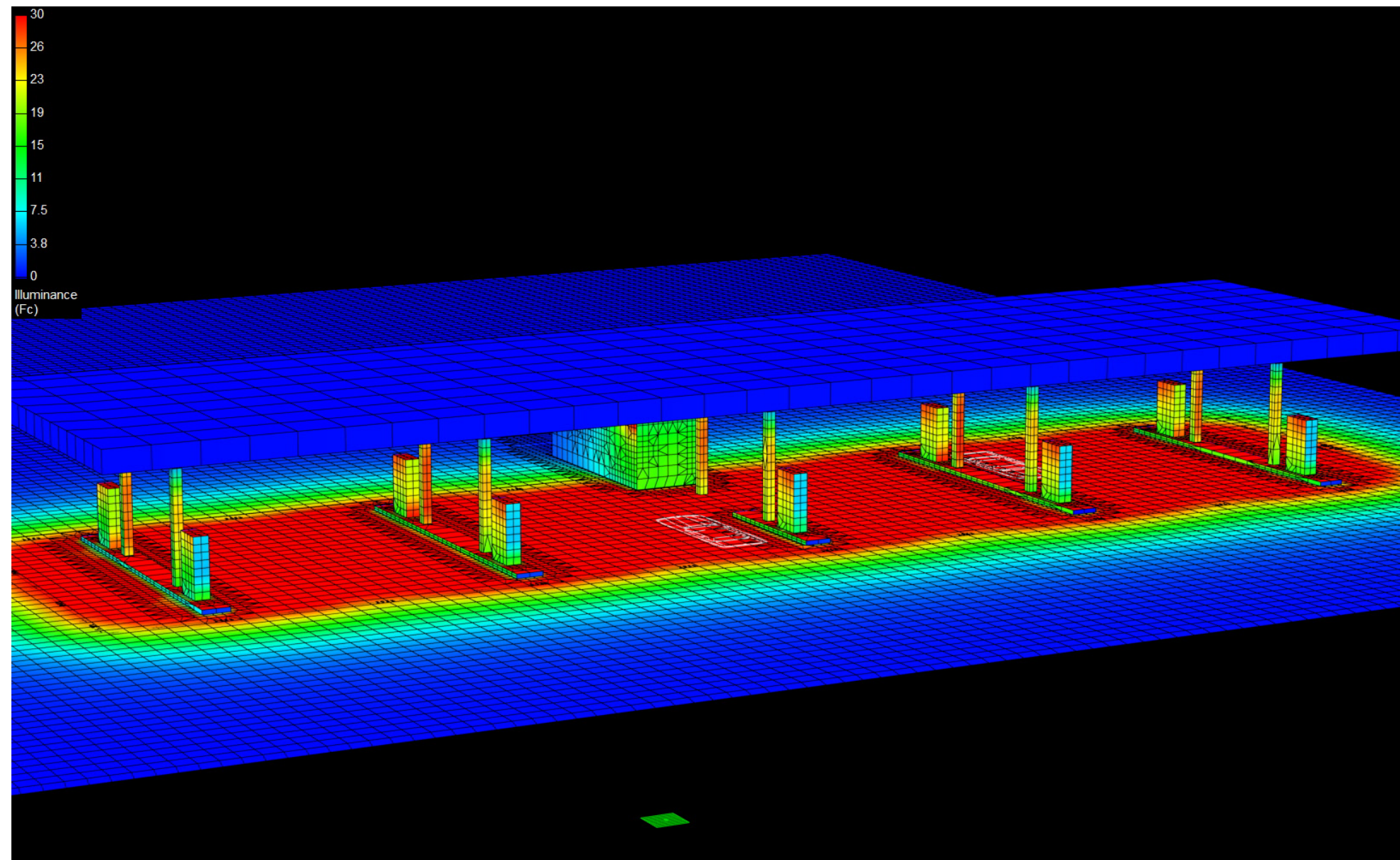

Canopy Style: 2+2+1+2+2 w/ Kiosk

Canopy Size: 43' x 160'

Initial Levels at grade and vertically on pumps.

(30) SCV-LED-13L-SC-50

Fixture Lumens: 13,444

Fixture Watts: 90

Lumens/Watt: 149

Mounting Height: 15'

Calculation Summary

Canopy Average: 39.18

Pump Average Inner: 21.49

Pump Average Outer: 17.16

Transition Average: N/A

Total Watts: 2700

Watts/sq.ft.: 0.39

Lumens/sq.ft. : 58.6

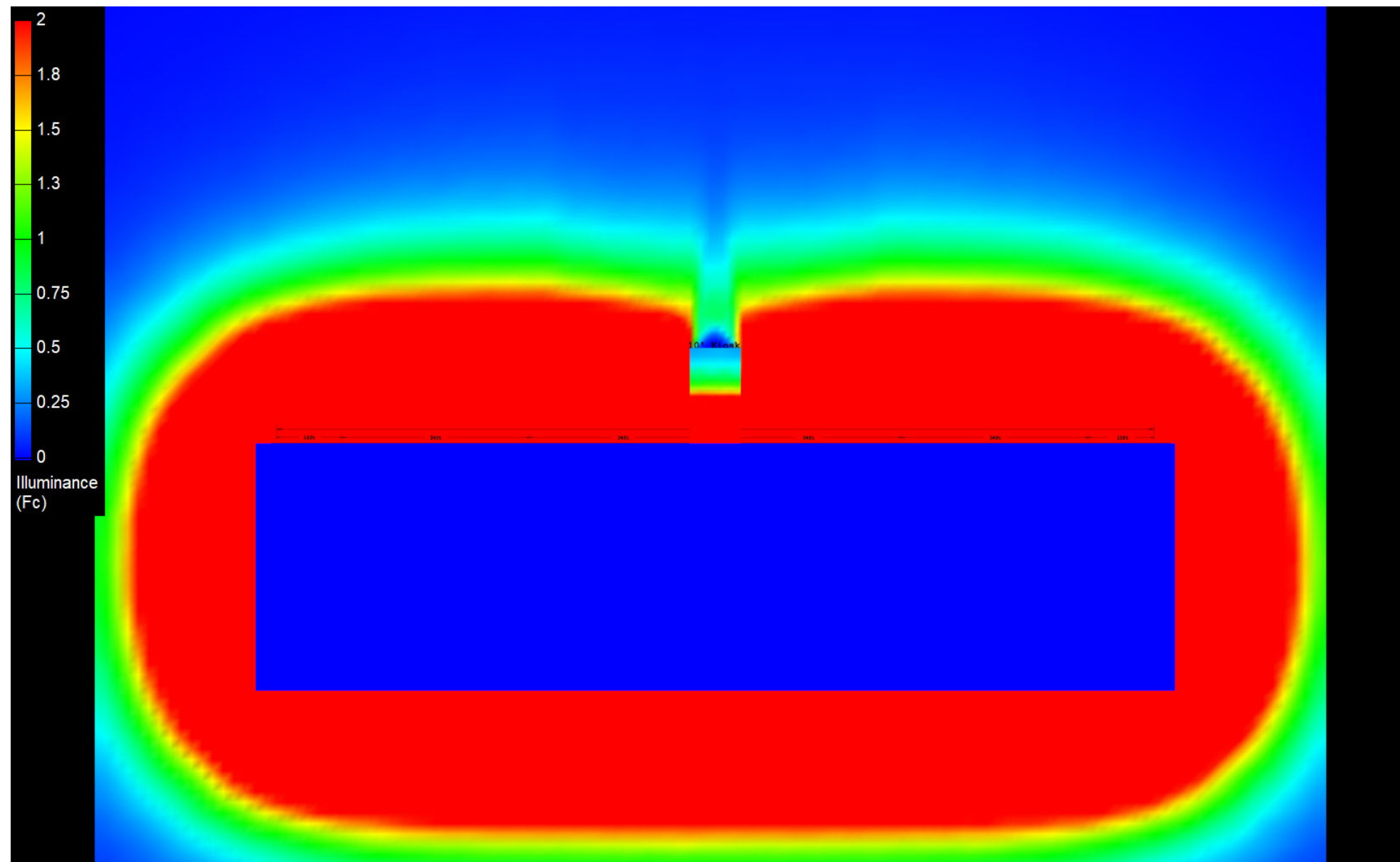

Canopy Style: 2+2+1+2+2 w/ Kiosk

Canopy Size: 43' x 160'

Initial Levels at grade and vertically on pumps.

(30) SCV-LED-13L-SC-50

Fixture Lumens: 13,444

Fixture Watts: 90

Lumens/Watt: 149

Mounting Height: 15'

Calculation Summary

Canopy Average: 39.18

Pump Average Inner: 21.49

Pump Average Outer: 17.16

Transition Average: N/A

Total Watts: 2700

Watts/sq.ft.: 0.39

Lumens/sq.ft. : 58.6

