

# Canopy Style: 2+2+1+2+2 w/ Kiosk

Canopy Size: 43' x 160'

Initial Levels at grade and vertically on pumps.

## (30) SCV-LED-10L-SC-50

Fixture Lumens: 10,317

Fixture Watts: 67

Lumens/Watt: 154

Mounting Height: 15'

## Calculation Summary

Canopy Average: 30.09

Pump Average Inner: 16.51

Pump Average Outer: 13.17

Transition Average: N/A

Total Watts: 2010

Watts/sq.ft.: 0.29

Lumens/sq.ft. : 45

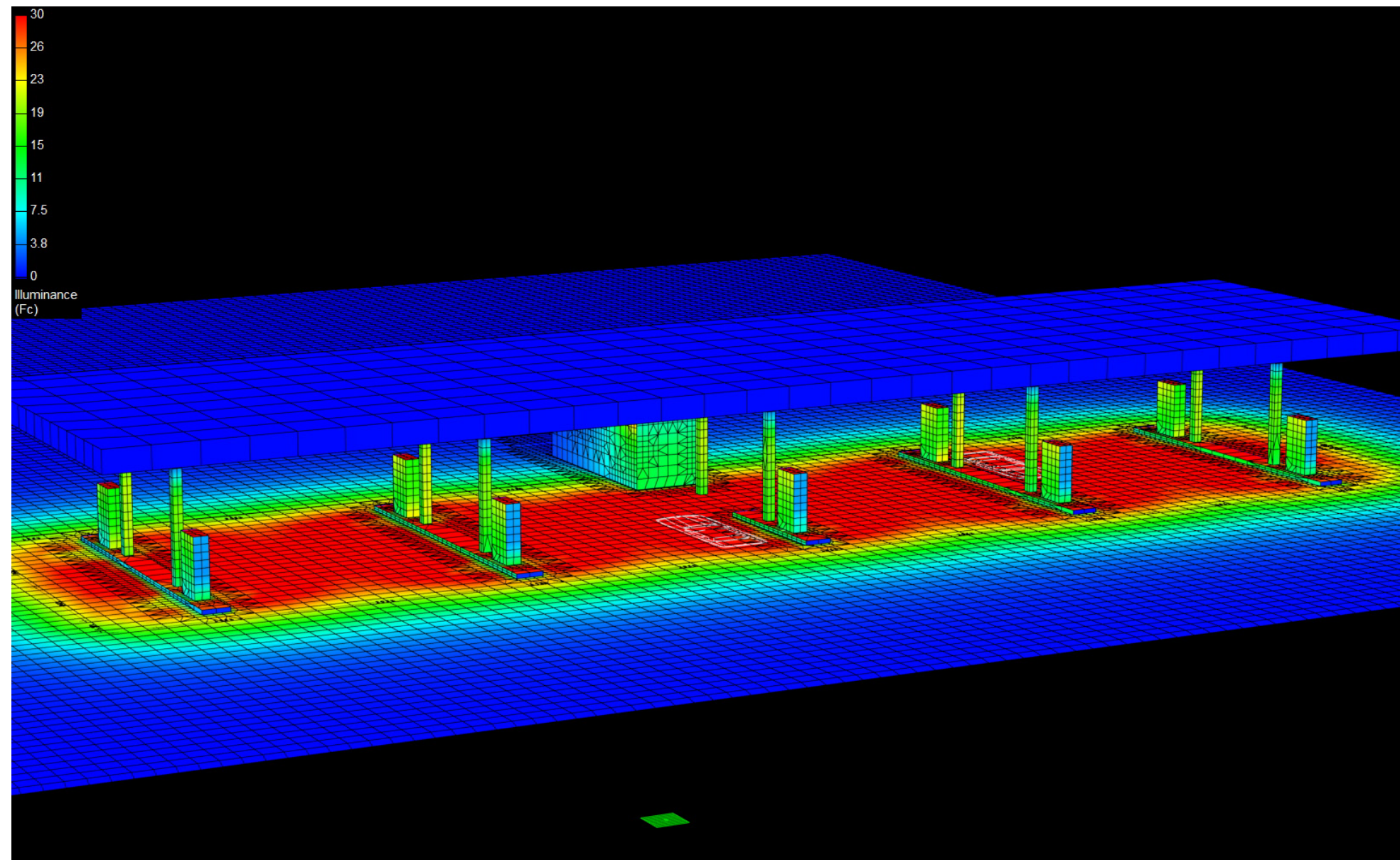

# Canopy Style: 2+2+1+2+2 w/ Kiosk

Canopy Size: 43' x 160'

Initial Levels at grade and vertically on pumps.

## (30) SCV-LED-10L-SC-50

Fixture Lumens: 10,317

Fixture Watts: 67

Lumens/Watt: 154

Mounting Height: 15'

## Calculation Summary

Canopy Average: 30.09

Pump Average Inner: 16.51

Pump Average Outer: 13.17

Transition Average: N/A

Total Watts: 2010

Watts/sq.ft.: 0.29

Lumens/sq.ft. : 45

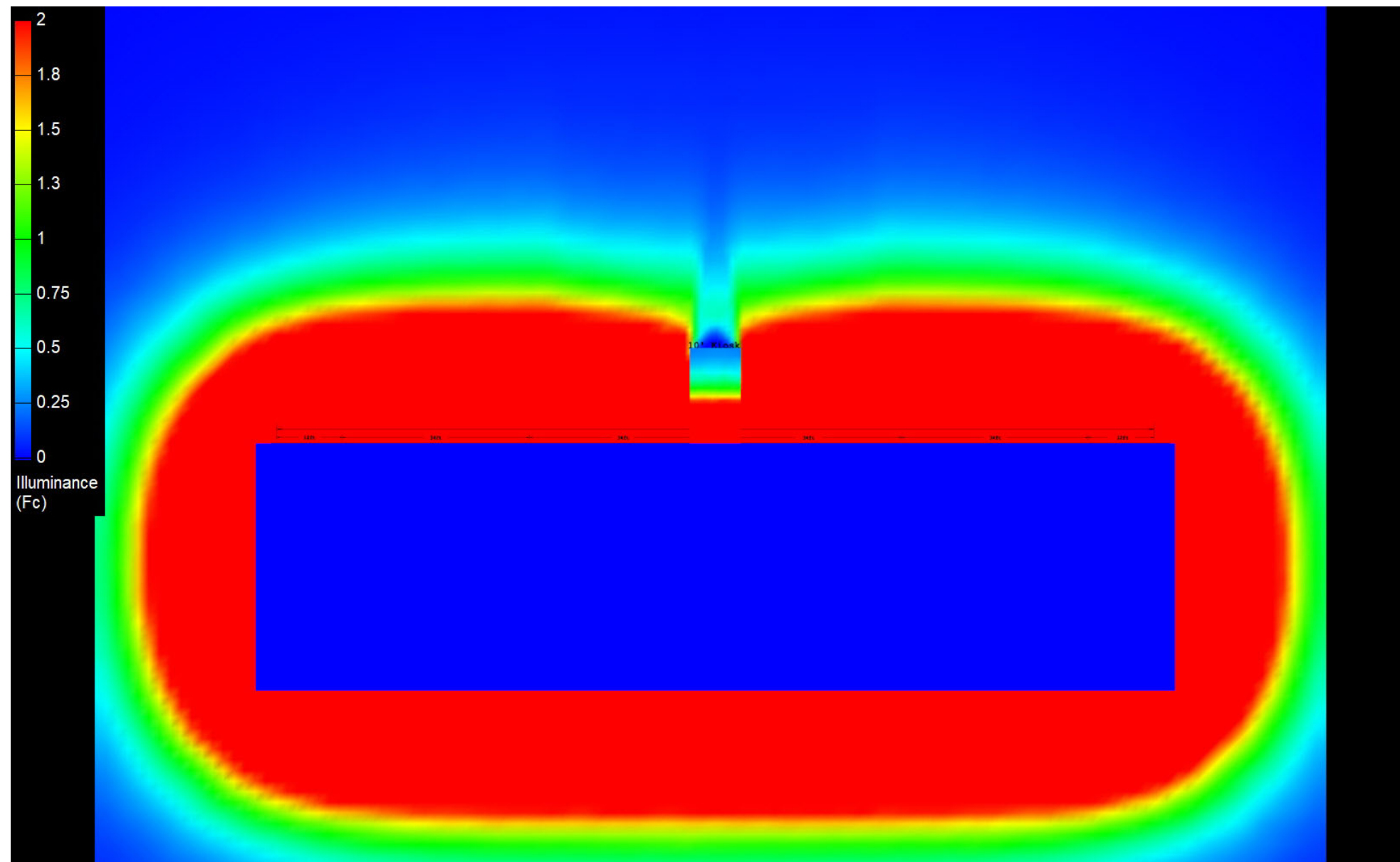

# Canopy Style: 2+2+1+2+2 w/ Kiosk

Canopy Size: 43' x 160'

Initial Levels at grade and vertically on pumps.

## (30) SCV-LED-10L-SC-50

Fixture Lumens: 10,317

Fixture Watts: 67

Lumens/Watt: 154

Mounting Height: 15'

## Calculation Summary

Canopy Average: 30.09

Pump Average Inner: 16.51

Pump Average Outer: 13.17

Transition Average: N/A

Total Watts: 2010

Watts/sq.ft.: 0.29

Lumens/sq.ft. : 45

