

# Canopy Style: 2+1+2 w/ Kiosk

Canopy Size: 43' x 92'

Initial Levels at grade and vertically on pumps.

## (12) SCV-LED-13L-SC-50

Fixture Lumens: 13,444

Fixture Watts: 90

Lumens/Watt: 149

Mounting Height: 15'

## Calculation Summary

Canopy Average: 25.42

Pump Average Inner: 10.33

Pump Average Outer: 16.70

Transition Average: N/A

Total Watts: 1080

Watts/sq.ft.: 0.27

Lumens/sq.ft. : 40.8

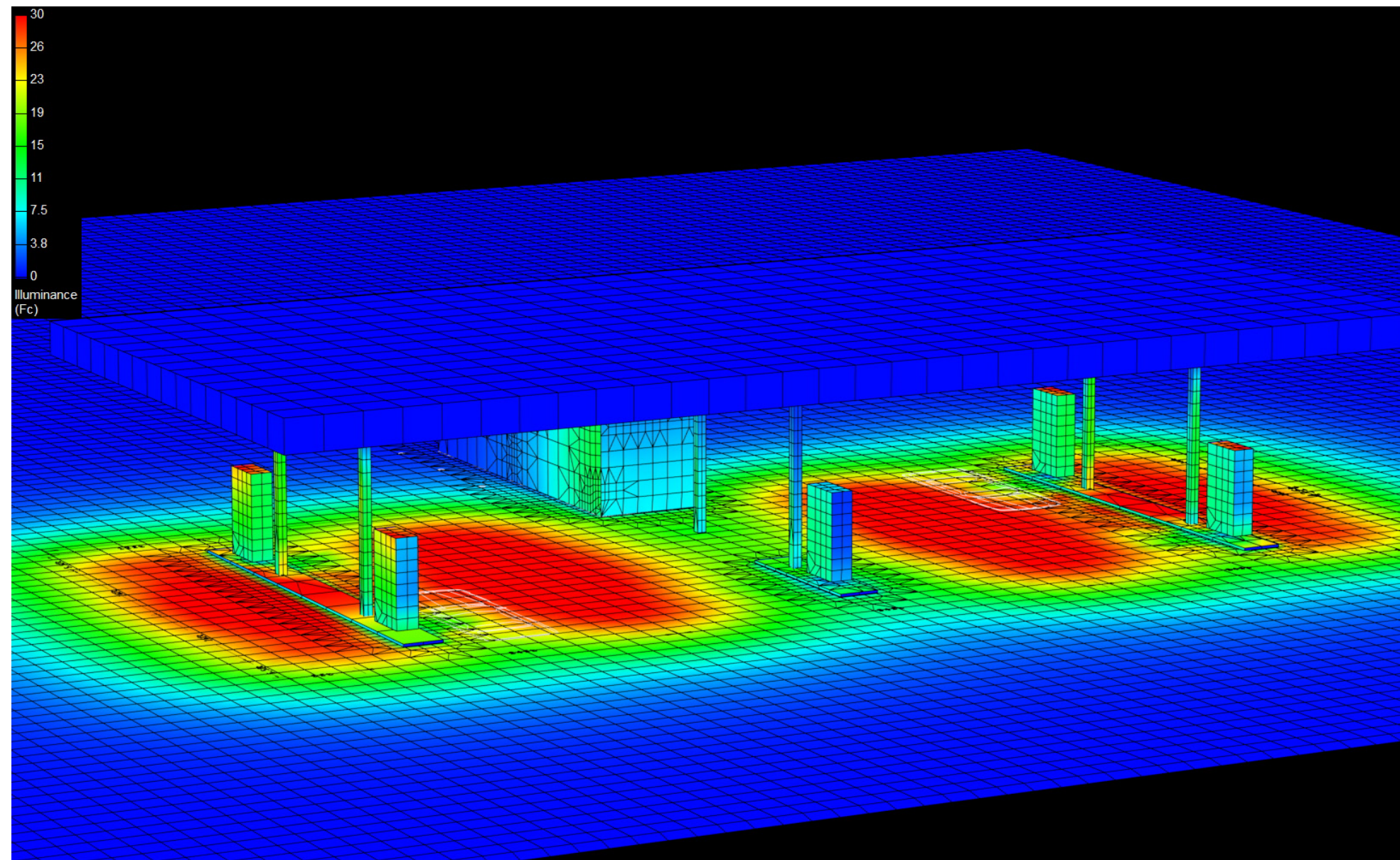

# Canopy Style: 2+1+2 w/ Kiosk

Canopy Size: 43' x 92'

Initial Levels at grade and vertically on pumps.

## (12) SCV-LED-13L-SC-50

Fixture Lumens: 13,444

Fixture Watts: 90

Lumens/Watt: 149

Mounting Height: 15'

## Calculation Summary

Canopy Average: 25.42

Pump Average Inner: 10.33

Pump Average Outer: 16.70

Transition Average: N/A

Total Watts: 1080

Watts/sq.ft.: 0.27

Lumens/sq.ft. : 40.8

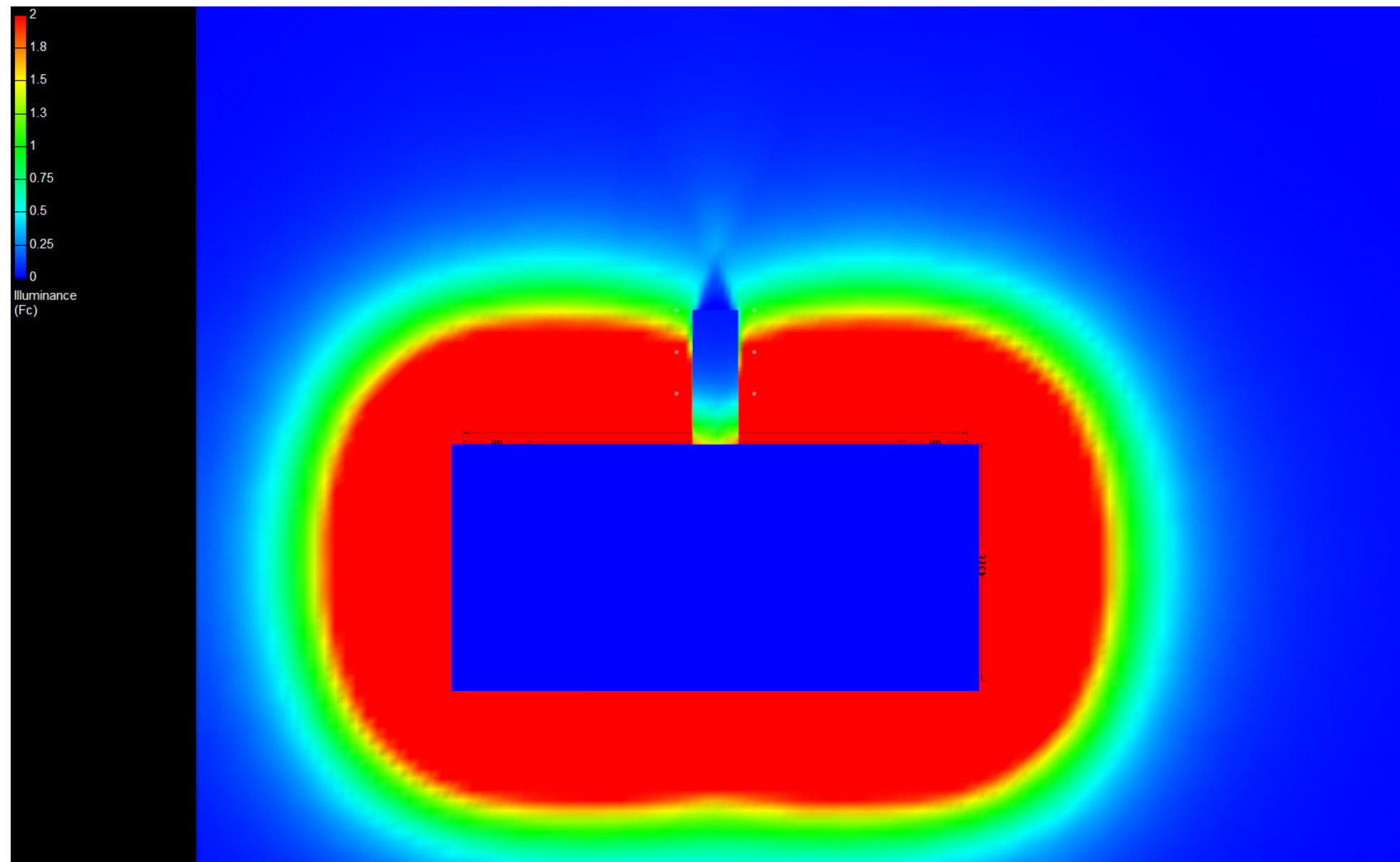

# Canopy Style: 2+1+2 w/ Kiosk

Canopy Size: 43' x 92'

Initial Levels at grade and vertically on pumps.

## (12) SCV-LED-13L-SC-50

Fixture Lumens: 13,444

Fixture Watts: 90

Lumens/Watt: 149

Mounting Height: 15'

## Calculation Summary

Canopy Average: 25.42

Pump Average Inner: 10.33

Pump Average Outer: 16.70

Transition Average: N/A

Total Watts: 1080

Watts/sq.ft.: 0.27

Lumens/sq.ft. : 40.8

