

# Canopy Style: 3x 1 Inline w/ Kiosk

Canopy Size: 24' x 95'

Initial Levels at grade and vertically on pumps.

## (10) SCM-LED-20L-SC-50

Fixture Lumens: 19,989

Fixture Watts: 145.5

Lumens/Watt: 144

Mounting Height: 15'

## Calculation Summary

Canopy Average: 42.89

Pump Average Inner: 23.02

Pump Average Outer: 24.92

Transition Average: N/A

Total Watts: 1455

Watts/sq.ft.: 0.64

Lumens/sq.ft. : 87.7

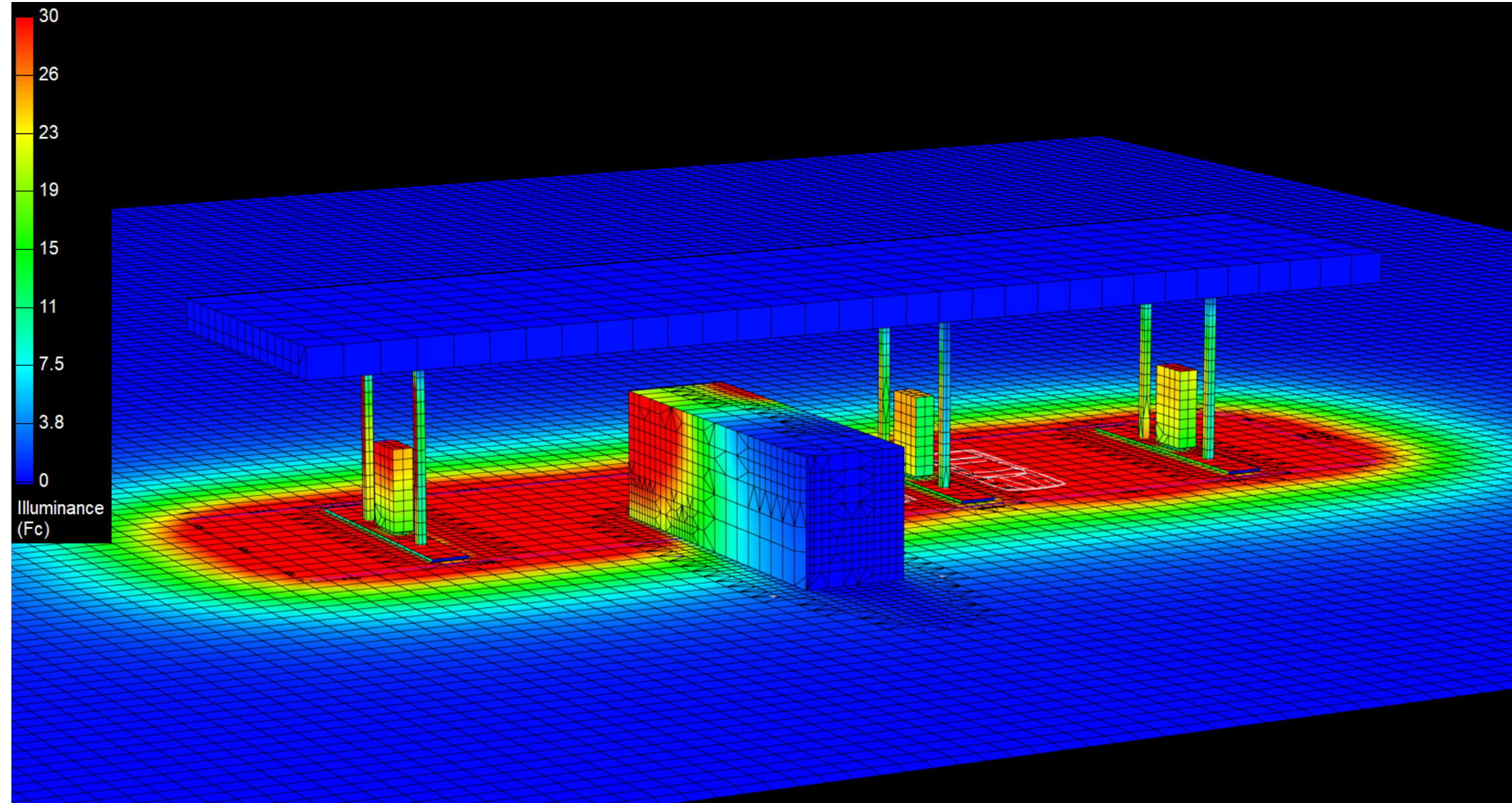



# Canopy Style: 3x 1 Inline w/ Kiosk

Canopy Size: 24' x 95'

Initial Levels at grade and vertically on pumps.

## (10) SCM-LED-20L-SC-50

Fixture Lumens: 19,989

Fixture Watts: 145.5

Lumens/Watt: 144

Mounting Height: 15'

## Calculation Summary

Canopy Average: 42.89

Pump Average Inner: 23.02

Pump Average Outer: 24.92

Transition Average: N/A

Total Watts: 1455

Watts/sq.ft.: 0.64

Lumens/sq.ft. : 87.7

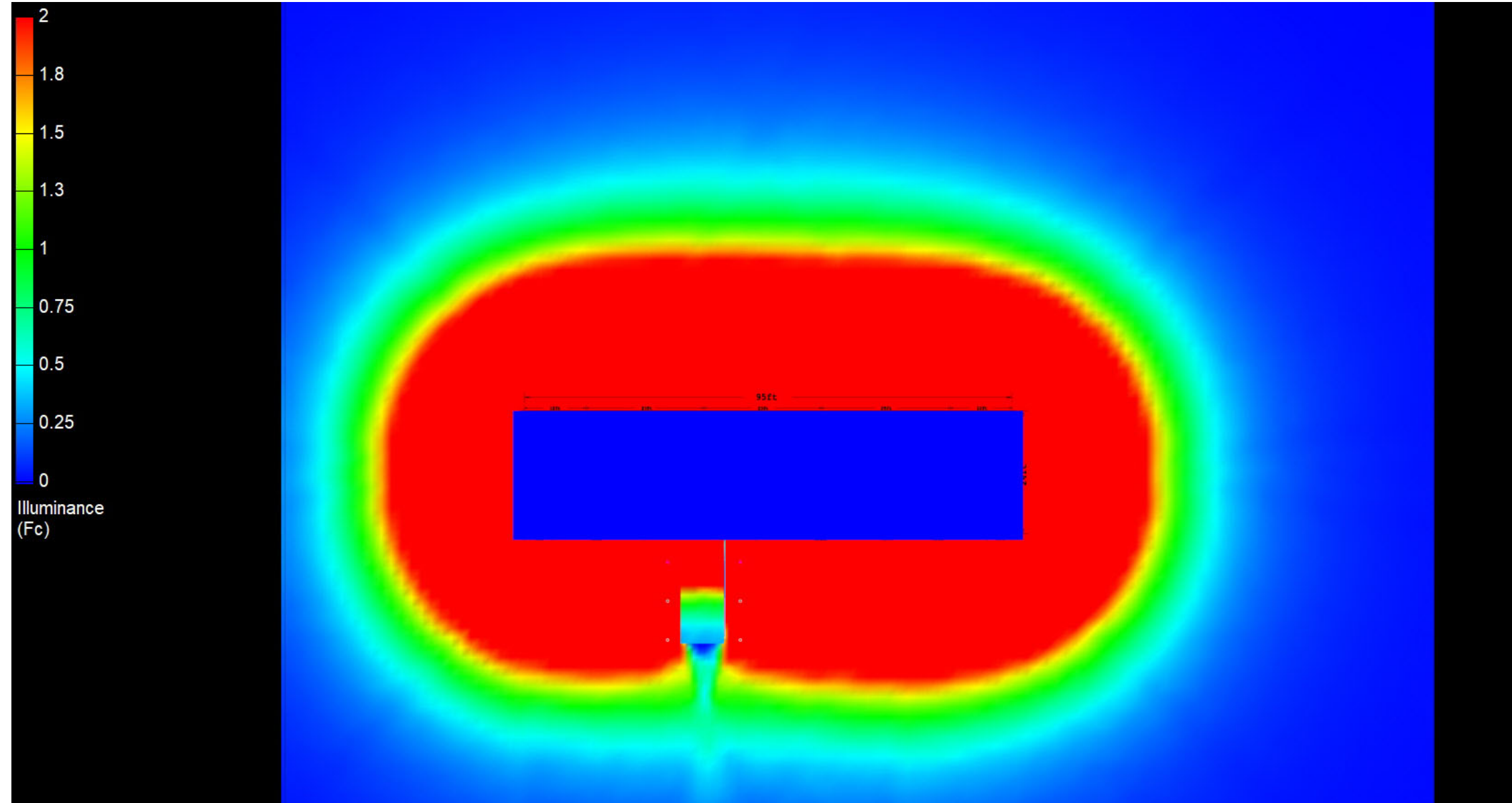

# Canopy Style: 3x 1 Inline w/ Kiosk

Canopy Size: 24' x 95'

Initial Levels at grade and vertically on pumps.

## (10) SCM-LED-20L-SC-50

Fixture Lumens: 19,989

Fixture Watts: 145.5

Lumens/Watt: 144

Mounting Height: 15'

## Calculation Summary

Canopy Average: 42.89

Pump Average Inner: 23.02

Pump Average Outer: 24.92

Transition Average: N/A

Total Watts: 1455

Watts/sq.ft.: 0.64

Lumens/sq.ft. : 87.7

