

Canopy Style: 3 x 1 Inline w/ Kiosk

Canopy Size: 24' x 95'

Initial Levels at grade and vertically on pumps.

(13) SCM-LED-20L-SC-50

Fixture Lumens: 19,989

Fixture Watts: 145.5

Lumens/Watt: 137

Mounting Height: 15'

Calculation Summary

Canopy Average: 57.30

Pump Average Inner: 40.24

Pump Average Outer: 25.49

Transition Average: N/A

Total Watts: 2278

Watts/sq.ft.: 0.83

Lumens/sq.ft. : 114

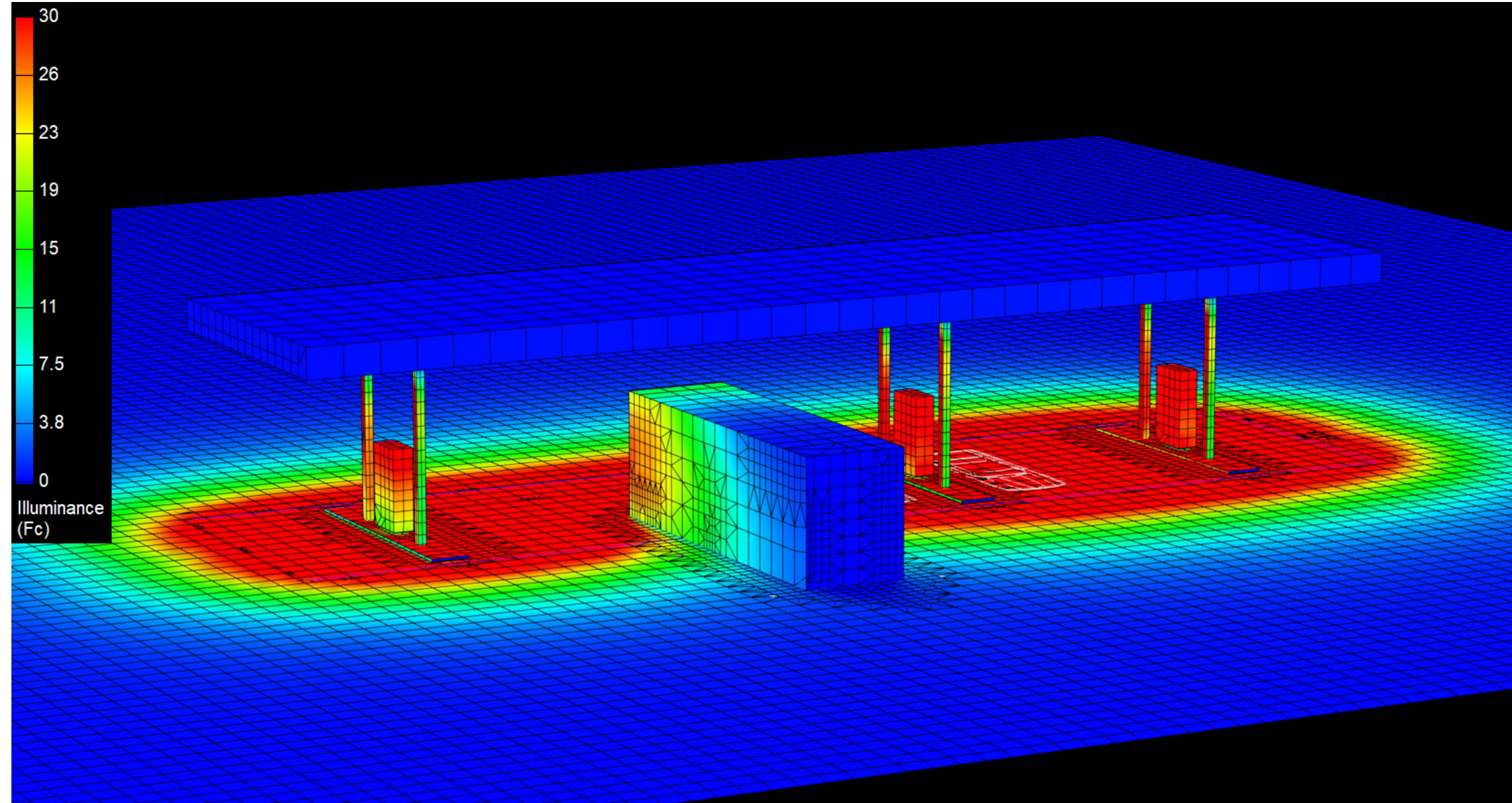

Canopy Style: 3 x 1 Inline w/ Kiosk

Canopy Size: 24' x 95'

Initial Levels at grade and vertically on pumps.

(13) SCM-LED-20L-SC-50

Fixture Lumens: 19,989

Fixture Watts: 145.5

Lumens/Watt: 137

Mounting Height: 15'

Calculation Summary

Canopy Average: 57.30

Pump Average Inner: 40.24

Pump Average Outer: 25.49

Transition Average: N/A

Total Watts: 2278

Watts/sq.ft.: 0.83

Lumens/sq.ft. : 114

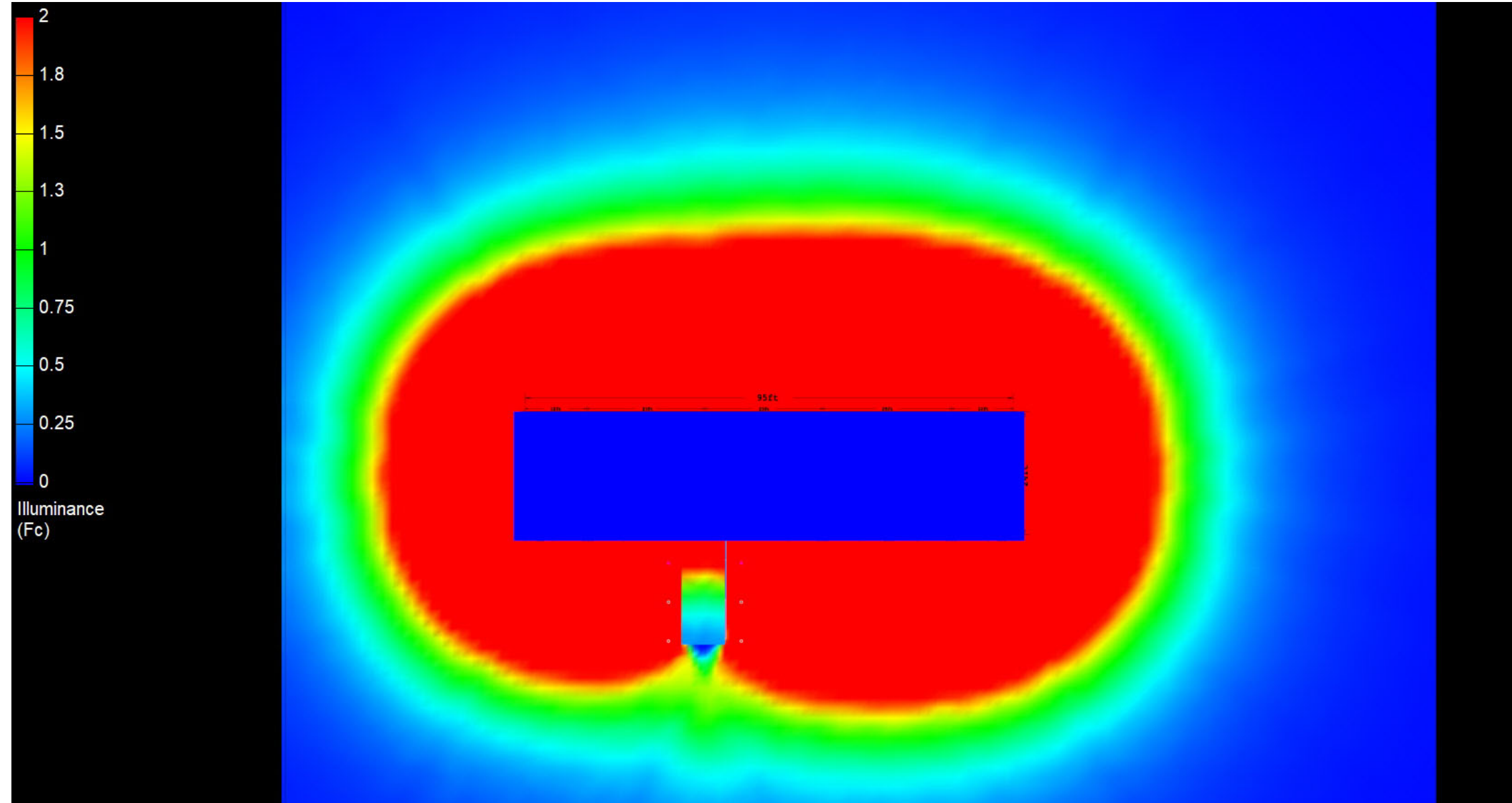

Canopy Style: 3 x 1 Inline w/ Kiosk

Canopy Size: 24' x 95'

Initial Levels at grade and vertically on pumps.

(13) SCM-LED-20L-SC-50

Fixture Lumens: 19,989

Fixture Watts: 145.5

Lumens/Watt: 137

Mounting Height: 15'

Calculation Summary

Canopy Average: 57.30

Pump Average Inner: 40.24

Pump Average Outer: 25.49

Transition Average: N/A

Total Watts: 2278

Watts/sq.ft.: 0.83

Lumens/sq.ft. : 114



SCM

