

Canopy Style: 3x 1 Inline w/ Kiosk

Canopy Size: 24' x 95'

Initial Levels at grade and vertically on pumps.

(10) SCM-LED-15L-SC-50

Fixture Lumens: 15,631

Fixture Watts: 111.1

Lumens/Watt: 141

Mounting Height: 15'

Calculation Summary

Canopy Average: 34.83

Pump Average Inner: 18.35

Pump Average Outer: 20.38

Transition Average: N/A

Total Watts: 1111

Watts/sq.ft.: 0.49

Lumens/sq.ft. : 69

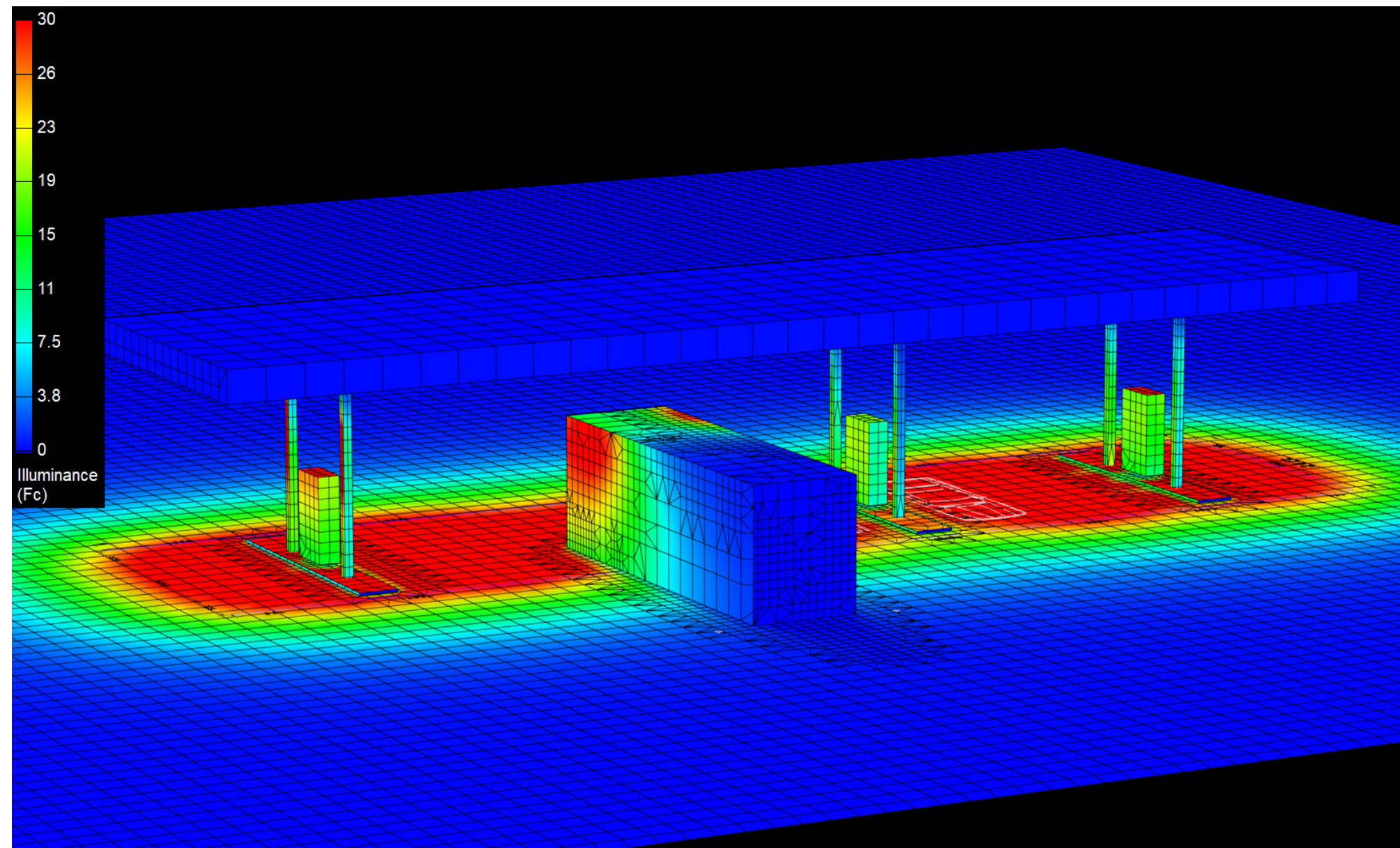

Canopy Style: 3x 1 Inline w/ Kiosk

Canopy Size: 24' x 95'

Initial Levels at grade and vertically on pumps.

(10) SCM-LED-15L-SC-50

Fixture Lumens: 15,631

Fixture Watts: 111.1

Lumens/Watt: 141

Mounting Height: 15'

Calculation Summary

Canopy Average: 34.83

Pump Average Inner: 18.35

Pump Average Outer: 20.38

Transition Average: N/A

Total Watts: 1111

Watts/sq.ft.: 0.49

Lumens/sq.ft. : 69

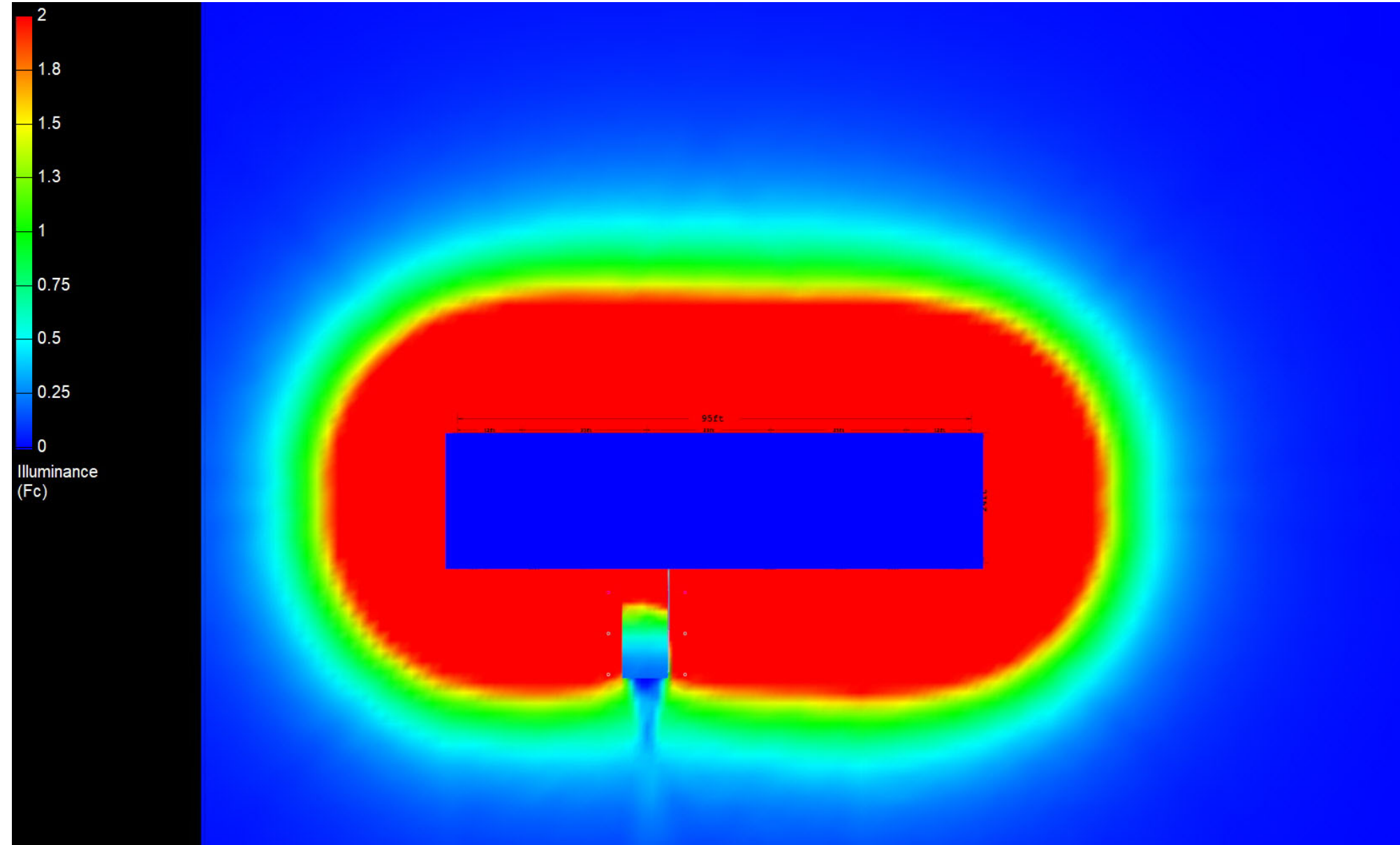

Canopy Style: 3x 1 Inline w/ Kiosk

Canopy Size: 24' x 95'

Initial Levels at grade and vertically on pumps.

(10) SCM-LED-15L-SC-50

Fixture Lumens: 15,631

Fixture Watts: 111.1

Lumens/Watt: 141

Mounting Height: 15'

Calculation Summary

Canopy Average: 34.83

Pump Average Inner: 18.35

Pump Average Outer: 20.38

Transition Average: N/A

Total Watts: 1111

Watts/sq.ft.: 0.49

Lumens/sq.ft. : 69



SCM

