

Canopy Style: 3 + 3 w/ Kiosk

Canopy Size: 64' x 94'

Initial Levels at grade and vertically on pumps.

(18) SCM-LED-15L-SC-50

Fixture Lumens: 15,631

Fixture Watts: 111.1

Lumens/Watt: 141

Mounting Height: 15'

Calculation Summary

Canopy Average: 31.67

Pump Average Inner: 15.33

Pump Average Outer: 15.92

Transition Average: N/A

Total Watts: 2000

Watts/sq.ft.: 0.33

Lumens/sq.ft. : 47

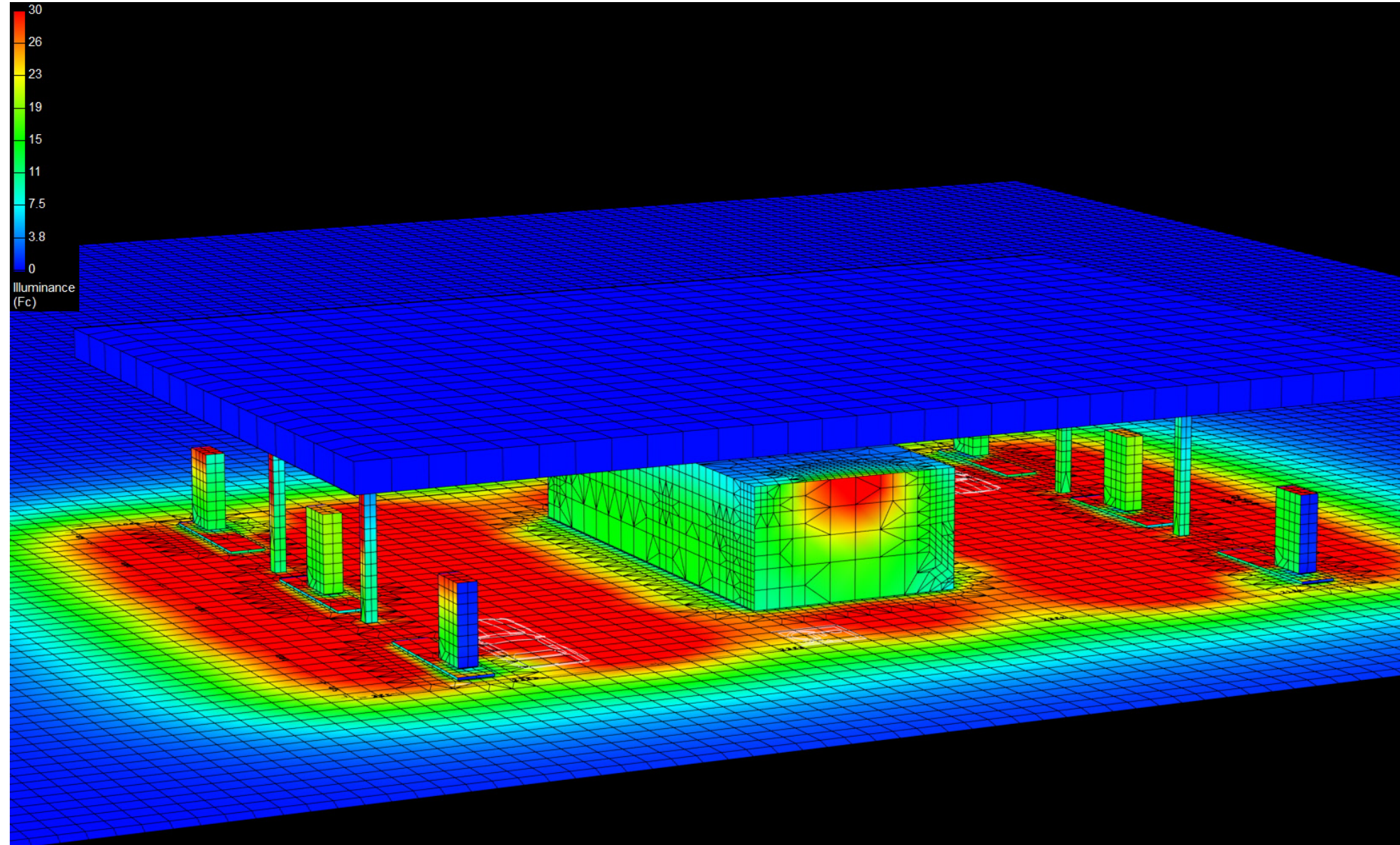

Canopy Style: 3 + 3 w/ Kiosk

Canopy Size: 64' x 94'

Initial Levels at grade and vertically on pumps.

(18) SCM-LED-15L-SC-50

Fixture Lumens: 15,631

Fixture Watts: 111.1

Lumens/Watt: 141

Mounting Height: 15'

Calculation Summary

Canopy Average: 31.67

Pump Average Inner: 15.33

Pump Average Outer: 15.92

Transition Average: N/A

Total Watts: 2000

Watts/sq.ft.: 0.33

Lumens/sq.ft. : 47

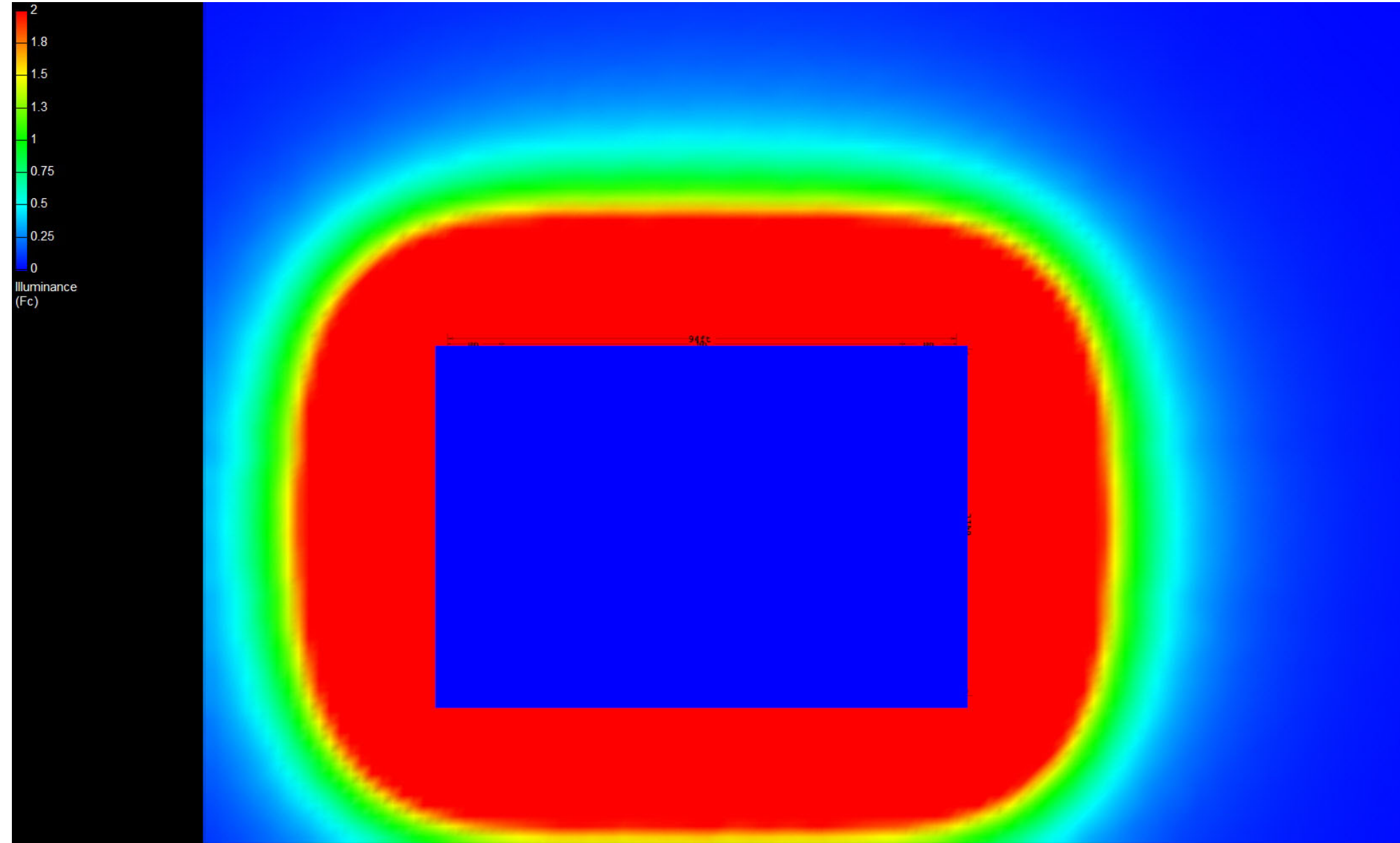

Canopy Style: 3 + 3 w/ Kiosk

Canopy Size: 64' x 94'

Initial Levels at grade and vertically on pumps.

(18) SCM-LED-15L-SC-50

Fixture Lumens: 15,631

Fixture Watts: 111.1

Lumens/Watt: 141

Mounting Height: 15'

Calculation Summary

Canopy Average: 31.67

Pump Average Inner: 15.33

Pump Average Outer: 15.92

Transition Average: N/A

Total Watts: 2000

Watts/sq.ft.: 0.33

Lumens/sq.ft. : 47



SCM

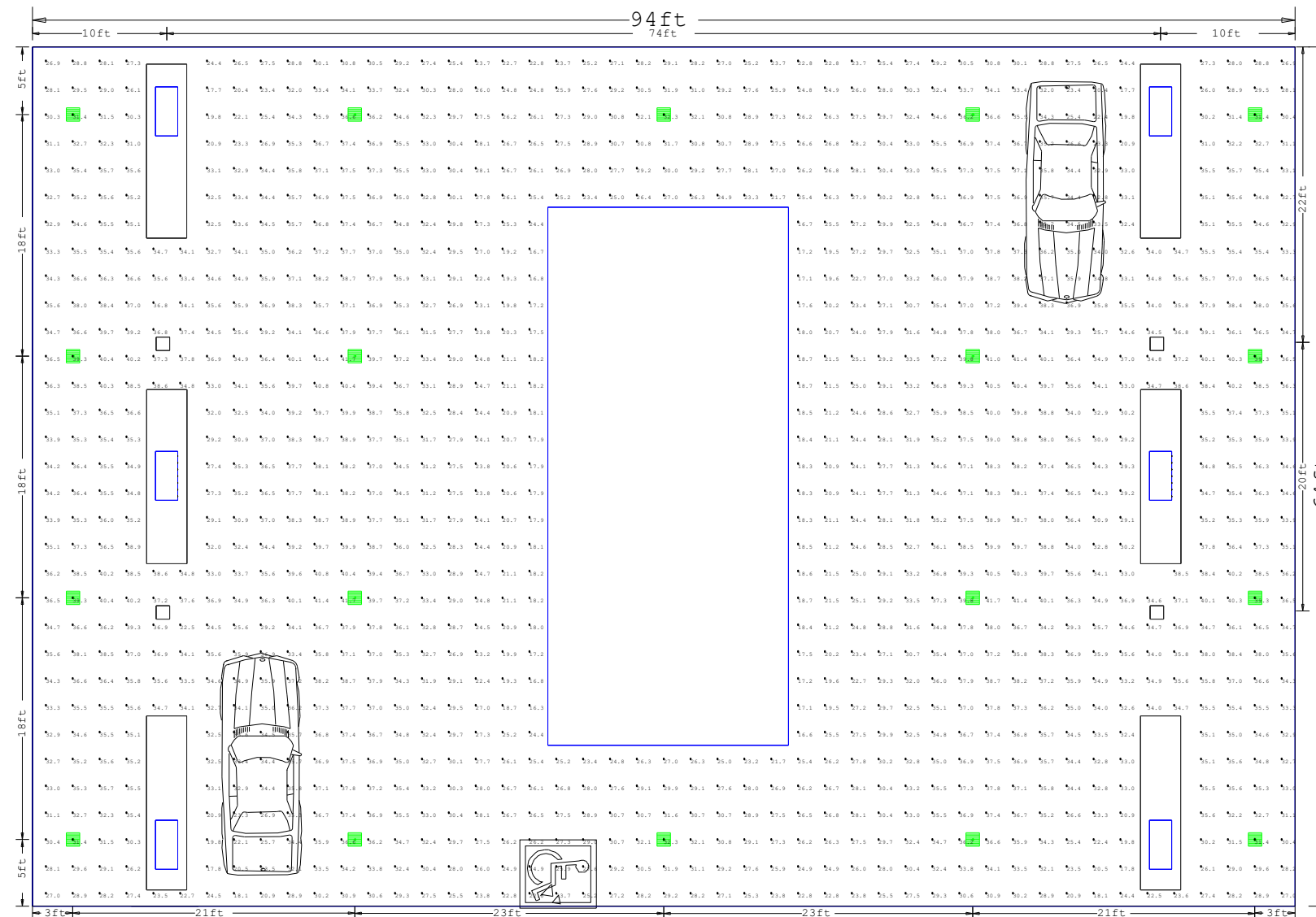

Industries™