

# Canopy Style: 3+2+3 w/ Kiosk

Canopy Size: 78' x 92'

Initial Levels at grade and vertically on pumps.

## (20) SCM-LED-15L-SC-50

Fixture Lumens: 15,631

Fixture Watts: 111.1

Lumens/Watt: 141

Mounting Height: 15'

## Calculation Summary

Canopy Average: 31.59

Pump Average Inner: 13.94

Pump Average Outer: 22.26

Transition Average: N/A

Total Watts: 2222

Watts/sq.ft.: 0.31

Lumens/sq.ft. : 44

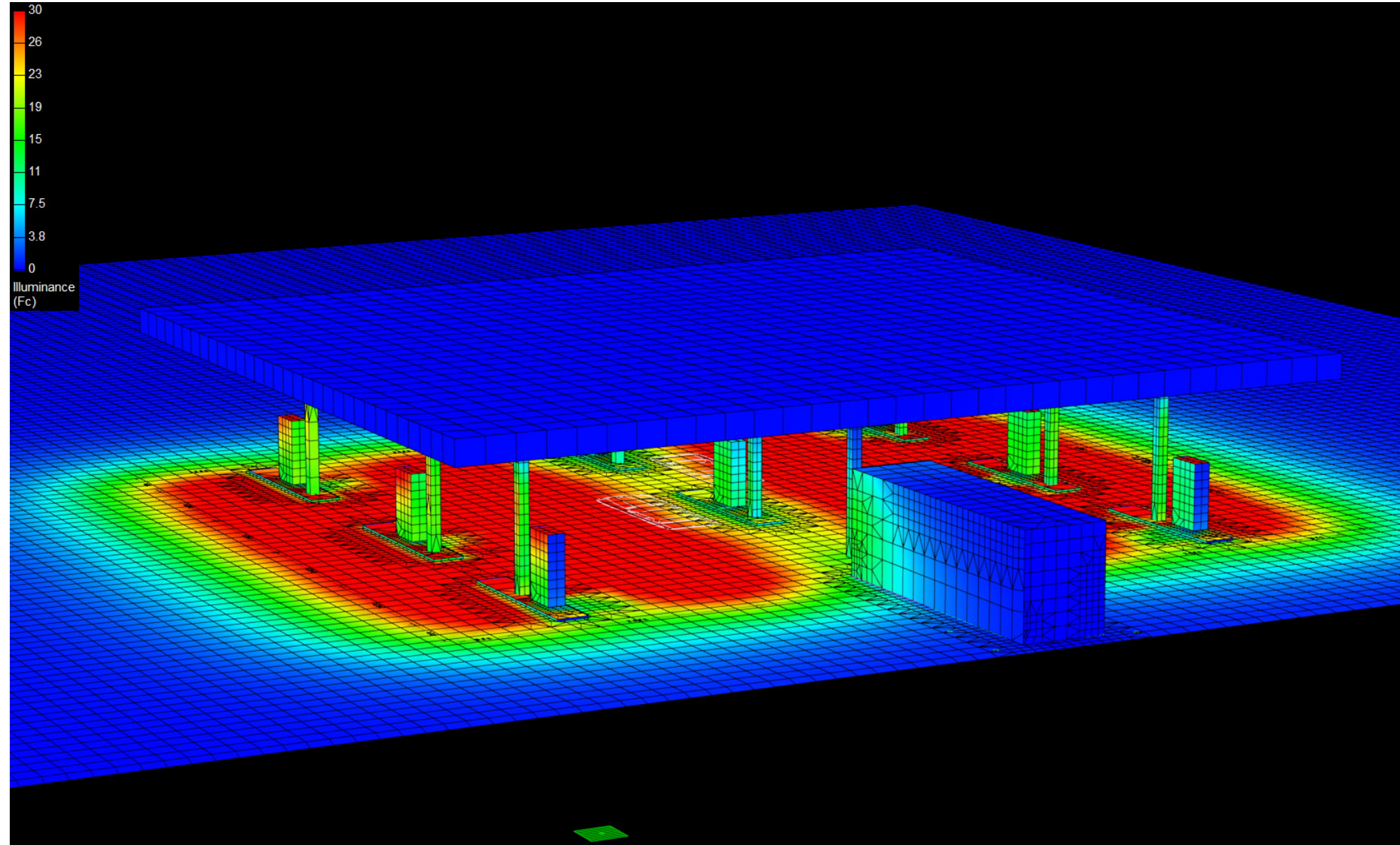

# Canopy Style: 3+2+3 w/ Kiosk

Canopy Size: 78' x 92'

Initial Levels at grade and vertically on pumps.

## (20) SCM-LED-15L-SC-50

Fixture Lumens: 15,631

Fixture Watts: 111.1

Lumens/Watt: 141

Mounting Height: 15'

## Calculation Summary

Canopy Average: 31.59

Pump Average Inner: 13.94

Pump Average Outer: 22.26

Transition Average: N/A

Total Watts: 2222

Watts/sq.ft.: 0.31

Lumens/sq.ft. : 44

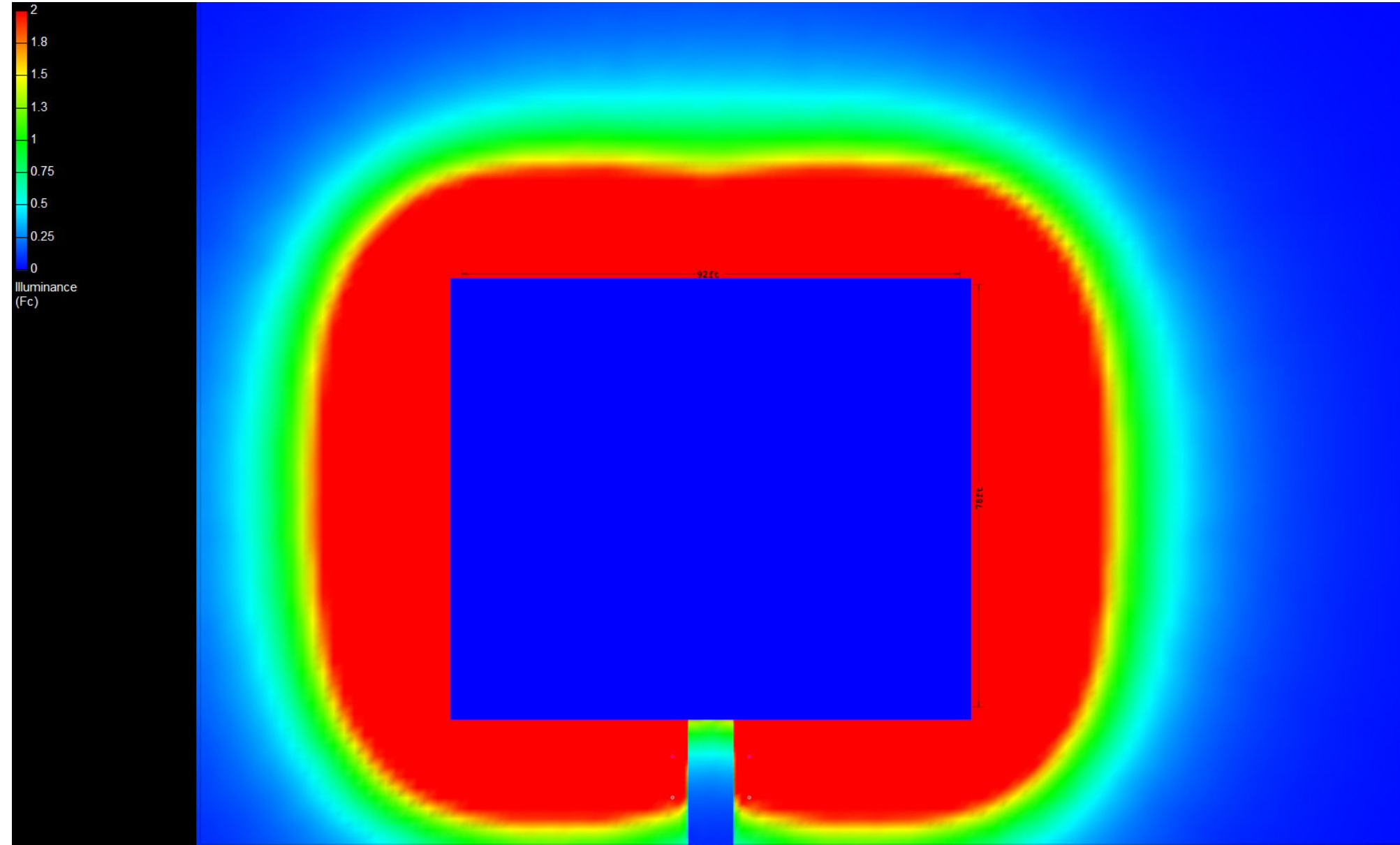

# Canopy Style: 3+2+3 w/ Kiosk

Canopy Size: 78' x 92'

Initial Levels at grade and vertically on pumps.

## (20) SCM-LED-15L-SC-50

Fixture Lumens: 15,631

Fixture Watts: 111.1

Lumens/Watt: 141

Mounting Height: 15'

## Calculation Summary

Canopy Average: 31.59

Pump Average Inner: 13.94

Pump Average Outer: 22.26

Transition Average: N/A

Total Watts: 2222

Watts/sq.ft.: 0.31

Lumens/sq.ft. : 44



SCM

