

Canopy Style: 3+2+3 w/ Kiosk

Canopy Size: 78' x 92'

Initial Levels at grade and vertically on pumps.

(30) SCM-LED-08L-SC-50

Fixture Lumens: 7,983

Fixture Watts: 85.4

Lumens/Watt: 144

Mounting Height: 15'

Calculation Summary

Canopy Average: 24.52

Pump Average Inner: 15.22

Pump Average Outer: 11.35

Transition Average: N/A

Total Watts: 1662

Watts/sq.ft.: 0.23

Lumens/sq.ft. : 33.3

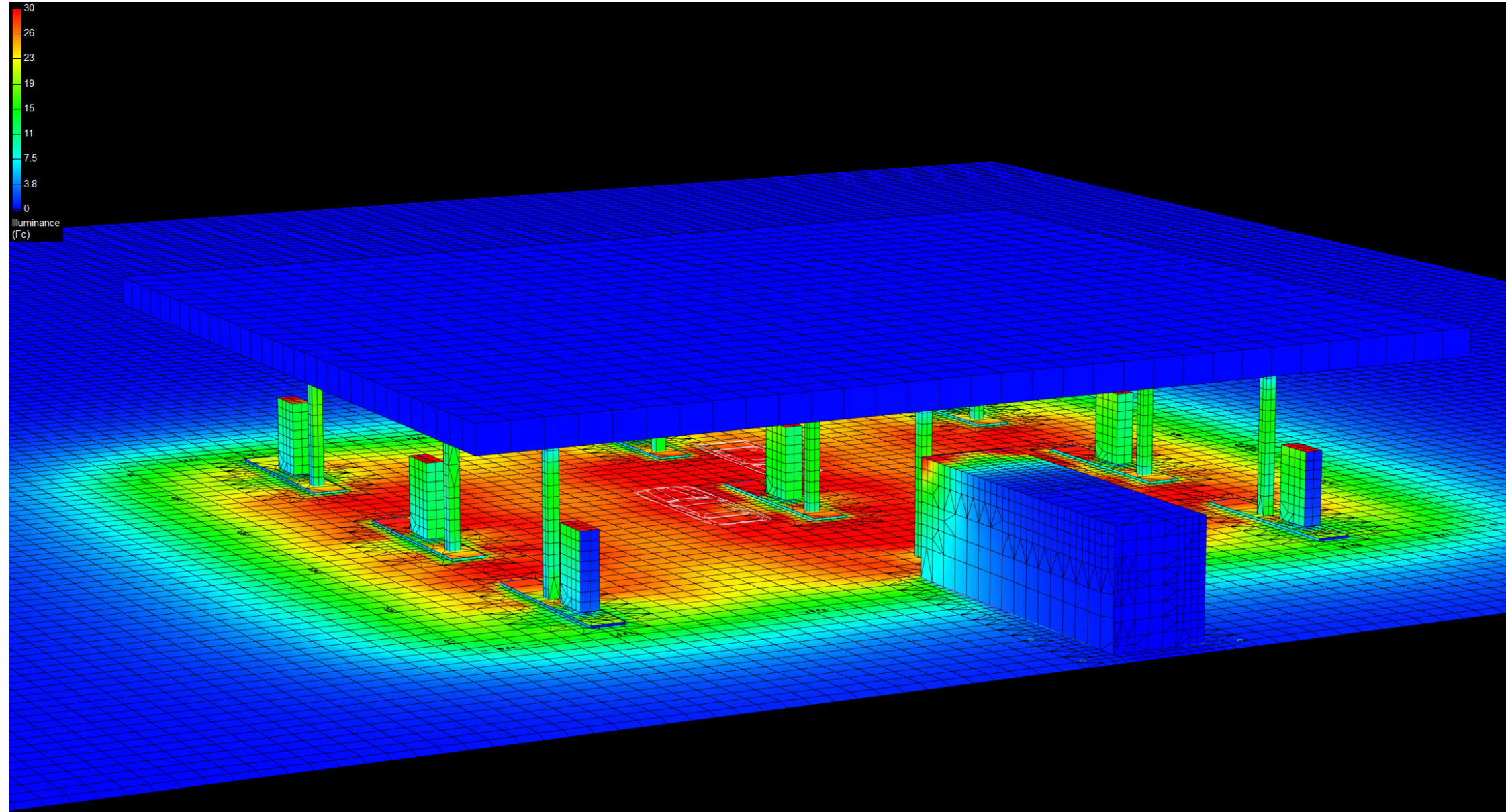

Canopy Style: 3+2+3 w/ Kiosk

Canopy Size: 78' x 92'

Initial Levels at grade and vertically on pumps.

(30) SCM-LED-08L-SC-50

Fixture Lumens: 7,983

Fixture Watts: 85.4

Lumens/Watt: 144

Mounting Height: 15'

Calculation Summary

Canopy Average: 24.52

Pump Average Inner: 15.22

Pump Average Outer: 11.35

Transition Average: N/A

Total Watts: 1662

Watts/sq.ft.: 0.23

Lumens/sq.ft. : 33.3

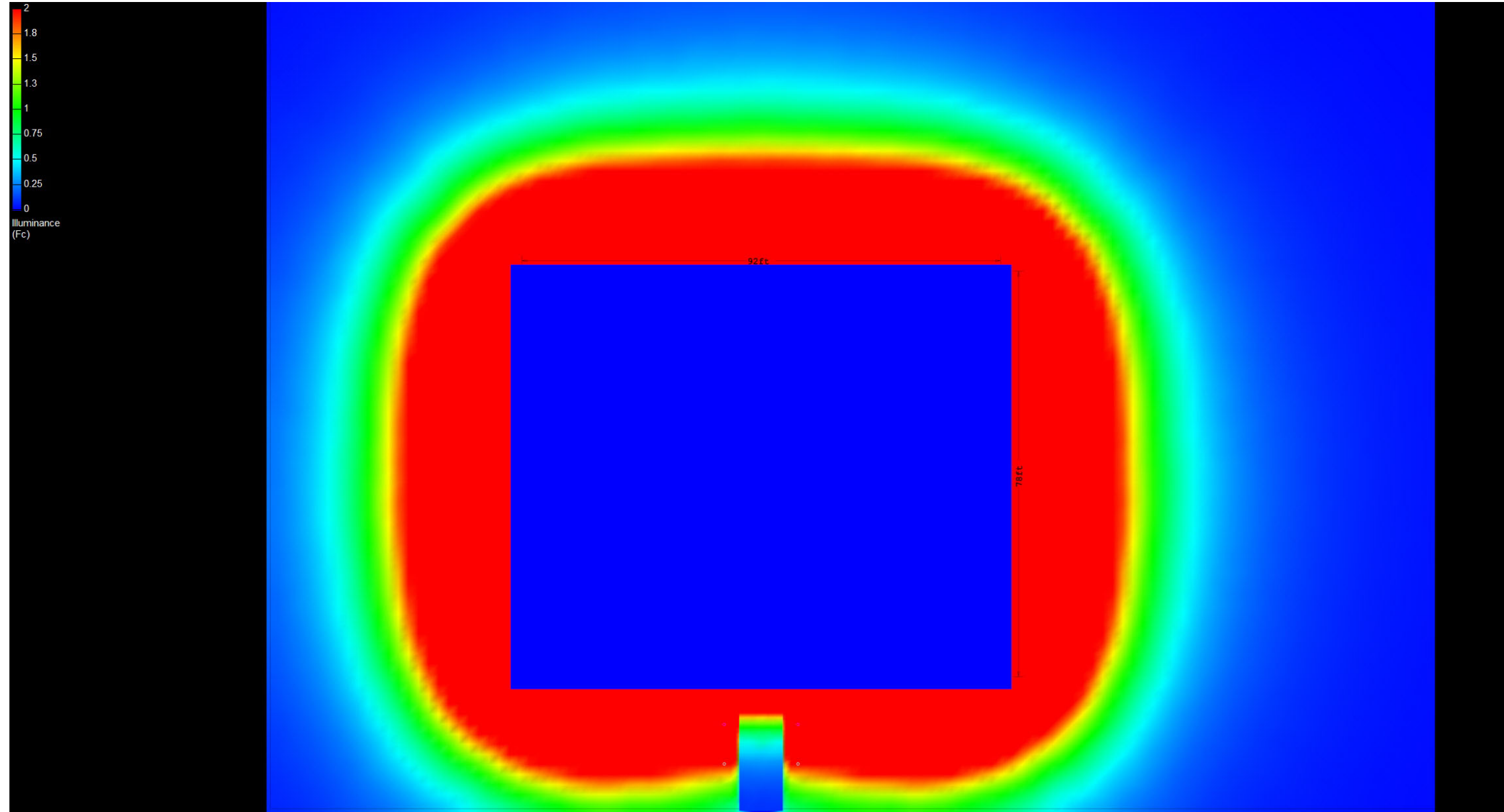

Canopy Style: 3+2+3 w/ Kiosk

Canopy Size: 78' x 92'

Initial Levels at grade and vertically on pumps.

(30) SCM-LED-08L-SC-50

Fixture Lumens: 7,983

Fixture Watts: 85.4

Lumens/Watt: 144

Mounting Height: 15'

Calculation Summary

Canopy Average: 24.52

Pump Average Inner: 15.22

Pump Average Outer: 11.35

Transition Average: N/A

Total Watts: 1662

Watts/sq.ft.: 0.23

Lumens/sq.ft. : 33.3



SCM

