

Canopy Style: 2+2+1+2+2 w/ Kiosk

Canopy Size: 43' x 160'

Initial Levels at grade and vertically on pumps.

(30) SCM-LED-20L-SC-50

Fixture Lumens: 19,989

Fixture Watts: 145.5

Lumens/Watt: 137

Mounting Height: 15'

Calculation Summary

Canopy Average: 57.41

Pump Average Inner: 32.24

Pump Average Outer: 25.02

Transition Average: N/A

Total Watts: 4365

Watts/sq.ft.: 0.64

Lumens/sq.ft. : 87

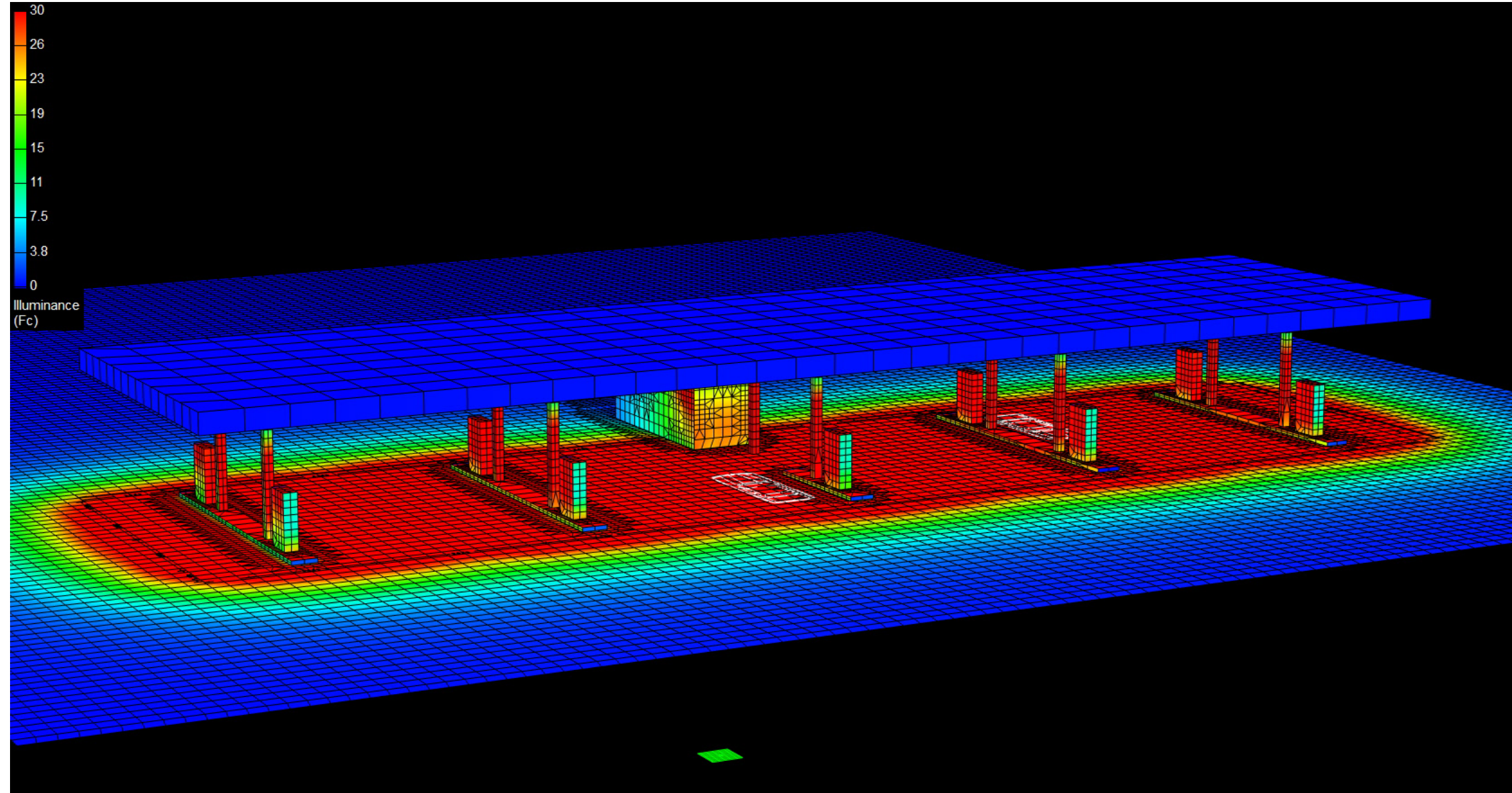

Canopy Style: 2+2+1+2+2 w/ Kiosk

Canopy Size: 43' x 160'

Initial Levels at grade and vertically on pumps.

(30) SCM-LED-20L-SC-50

Fixture Lumens: 19,989

Fixture Watts: 145.5

Lumens/Watt: 137

Mounting Height: 15'

Calculation Summary

Canopy Average: 57.41

Pump Average Inner: 32.24

Pump Average Outer: 25.02

Transition Average: N/A

Total Watts: 4365

Watts/sq.ft.: 0.64

Lumens/sq.ft. : 87

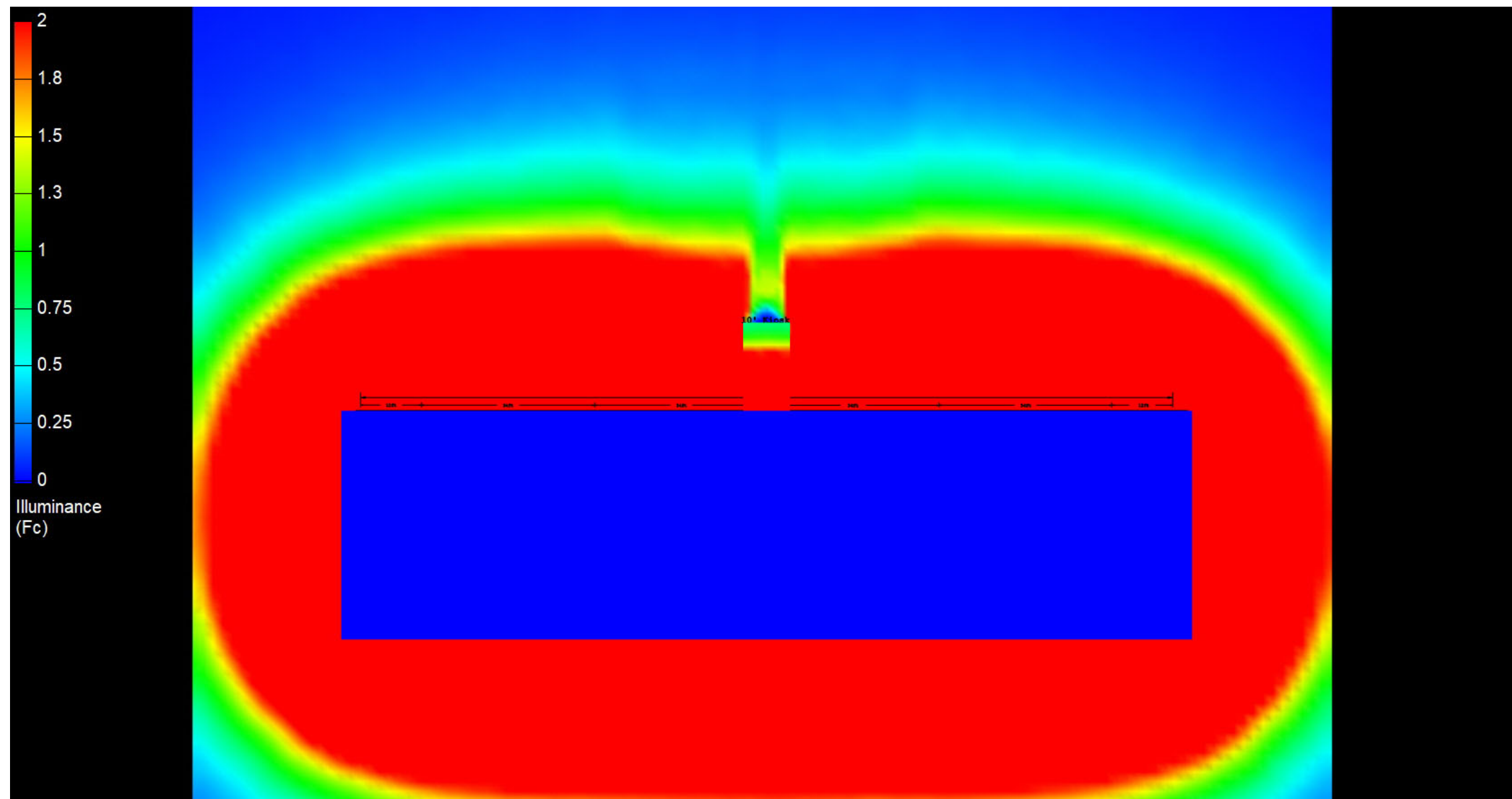

Canopy Style: 2+2+1+2+2 w/ Kiosk

Canopy Size: 43' x 160'

Initial Levels at grade and vertically on pumps.

(30) SCM-LED-20L-SC-50

Fixture Lumens: 19,989

Fixture Watts: 145.5

Lumens/Watt: 137

Mounting Height: 15'

Calculation Summary

Canopy Average: 57.41

Pump Average Inner: 32.24

Pump Average Outer: 25.02

Transition Average: N/A

Total Watts: 4365

Watts/sq.ft.: 0.64

Lumens/sq.ft. : 87

