

Canopy Style: 2+2+1+2+2 w/ Kiosk

Canopy Size: 43' x 160'

Initial Levels at grade and vertically on pumps.

(30) SCM-LED-18L-SC-50

Fixture Lumens: 15,631

Fixture Watts: 111.1

Lumens/Watt: 141

Mounting Height: 15'

Calculation Summary

Canopy Average: 45.99

Pump Average Inner: 24.98

Pump Average Outer: 20.31

Transition Average: N/A

Total Watts: 3333

Watts/sq.ft.: 0.49

Lumens/sq.ft. : 68.2

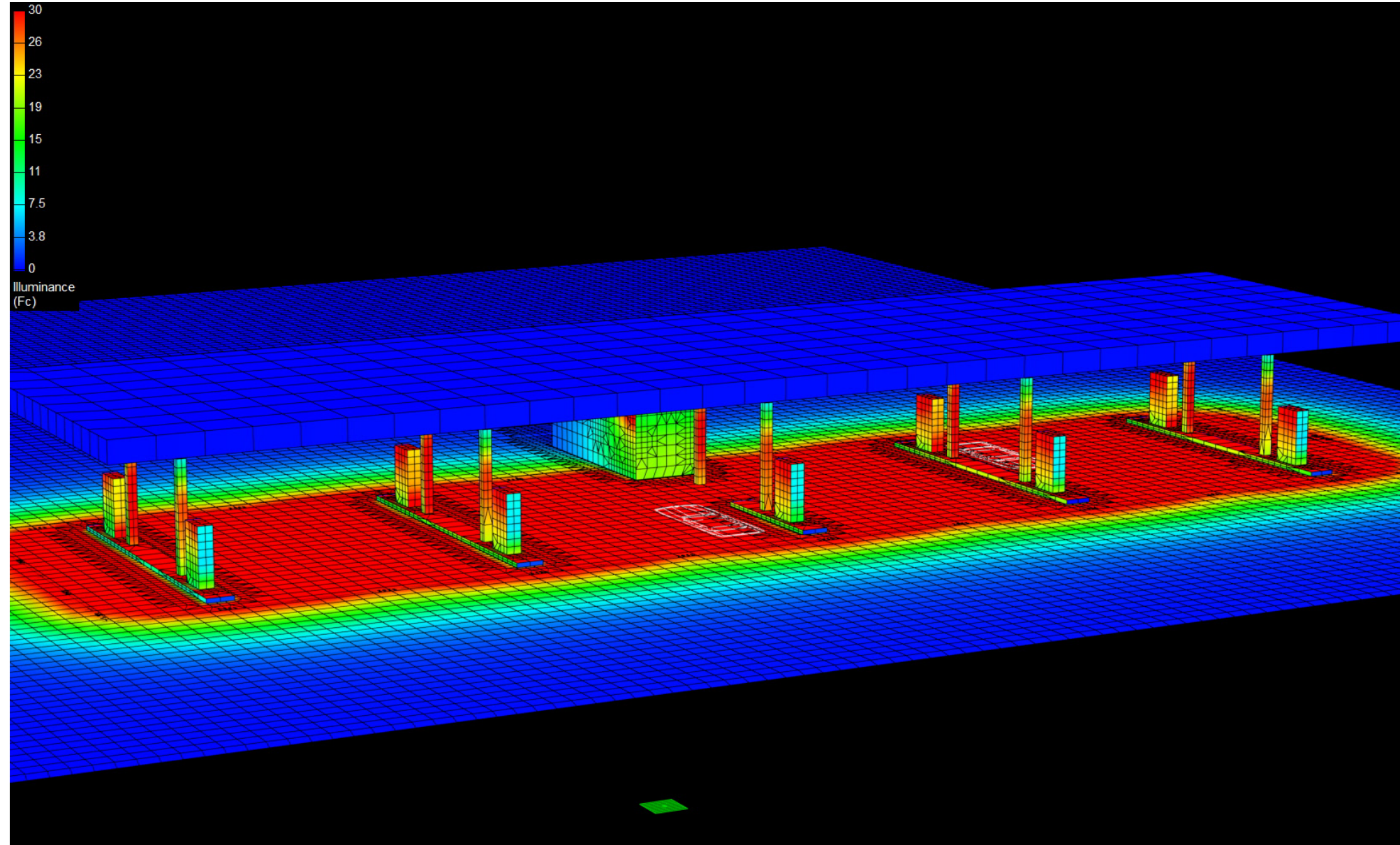

Canopy Style: 2+2+1+2+2 w/ Kiosk

Canopy Size: 43' x 160'

Initial Levels at grade and vertically on pumps.

(30) SCM-LED-18L-SC-50

Fixture Lumens: 15,631

Fixture Watts: 111.1

Lumens/Watt: 141

Mounting Height: 15'

Calculation Summary

Canopy Average: 45.99

Pump Average Inner: 24.98

Pump Average Outer: 20.31

Transition Average: N/A

Total Watts: 3333

Watts/sq.ft.: 0.49

Lumens/sq.ft. : 68.2

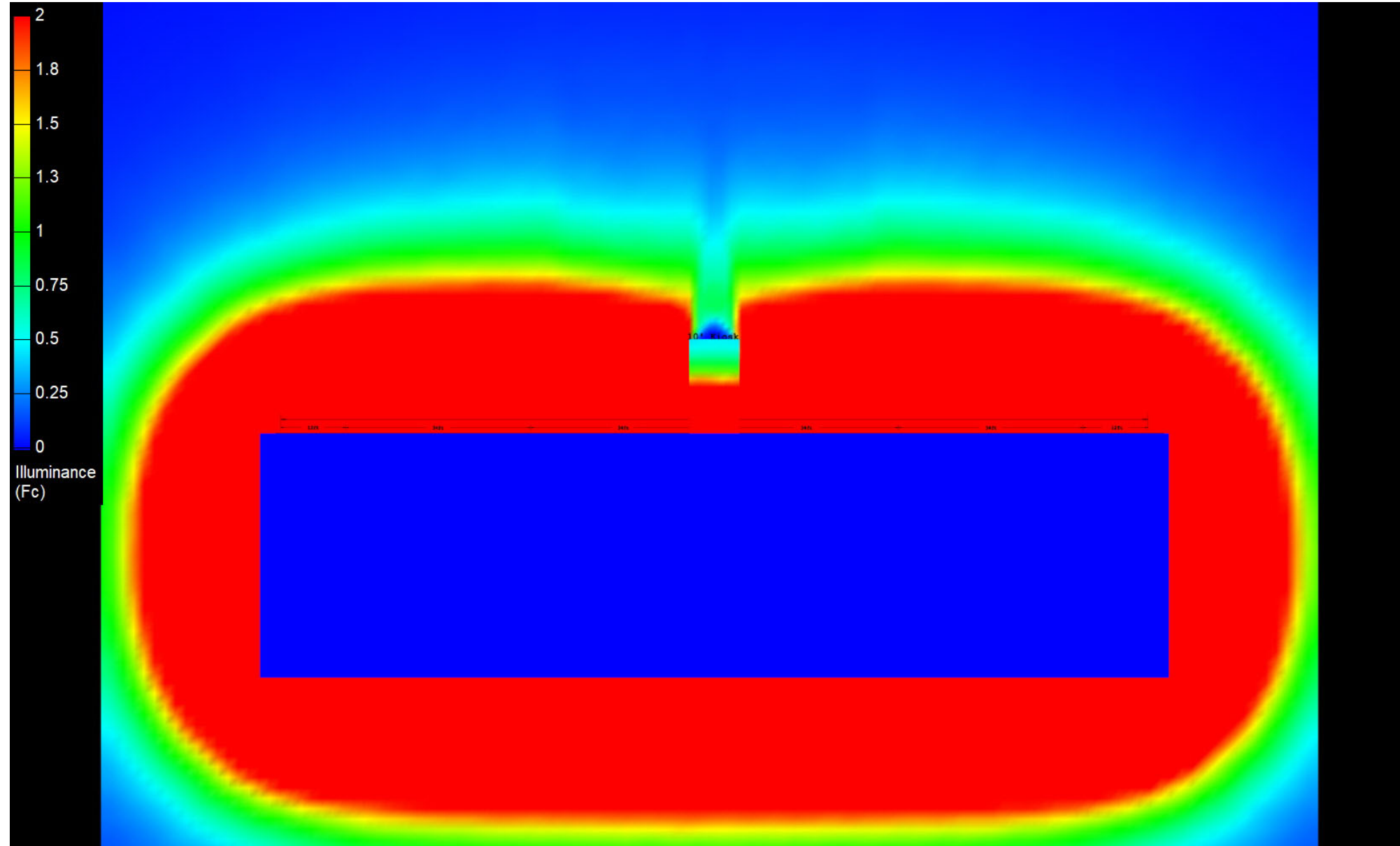

Canopy Style: 2+2+1+2+2 w/ Kiosk

Canopy Size: 43' x 160'

Initial Levels at grade and vertically on pumps.

(30) SCM-LED-18L-SC-50

Fixture Lumens: 15,631

Fixture Watts: 111.1

Lumens/Watt: 141

Mounting Height: 15'

Calculation Summary

Canopy Average: 45.99

Pump Average Inner: 24.98

Pump Average Outer: 20.31

Transition Average: N/A

Total Watts: 3333

Watts/sq.ft.: 0.49

Lumens/sq.ft. : 68.2

