

Canopy Style: 2+2+1+2+2 w/ Kiosk

Canopy Size: 43' x 160'

Initial Levels at grade and vertically on pumps.

(30) SCM-LED-08L-SC-50

Fixture Lumens: 7,983

Fixture Watts: 55.4

Lumens/Watt: 144

Mounting Height: 15'

Calculation Summary

Canopy Average: 23.05

Pump Average Inner: 12.80

Pump Average Outer: 10.06

Transition Average: N/A

Total Watts: 1662

Watts/sq.ft.: 0.24

Lumens/sq.ft. : 34.8

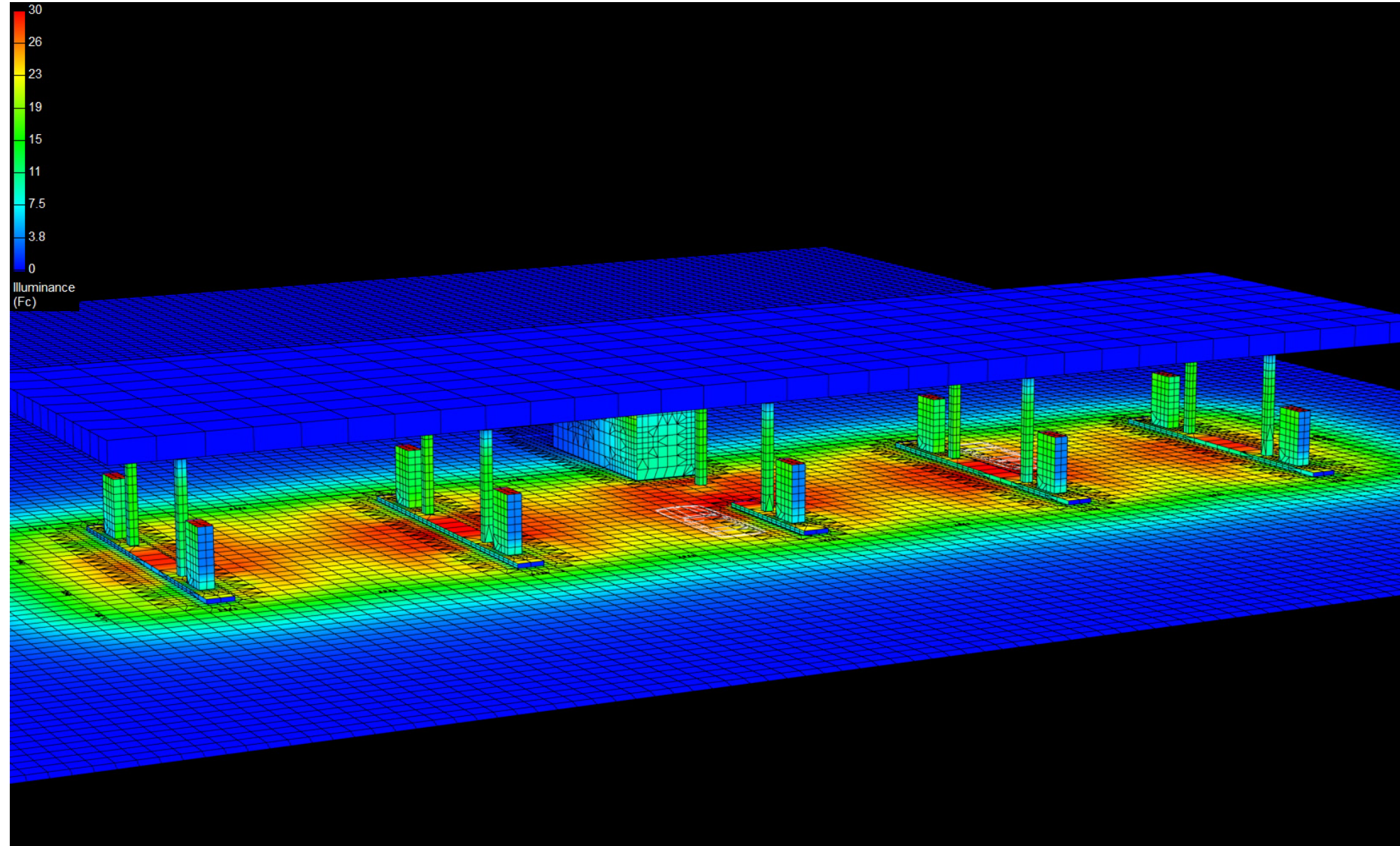

Canopy Style: 2+2+1+2+2 w/ Kiosk

Canopy Size: 43' x 160'

Initial Levels at grade and vertically on pumps.

(30) SCM-LED-08L-SC-50

Fixture Lumens: 7,983

Fixture Watts: 55.4

Lumens/Watt: 144

Mounting Height: 15'

Calculation Summary

Canopy Average: 23.05

Pump Average Inner: 12.80

Pump Average Outer: 10.06

Transition Average: N/A

Total Watts: 1662

Watts/sq.ft.: 0.24

Lumens/sq.ft. : 34.8

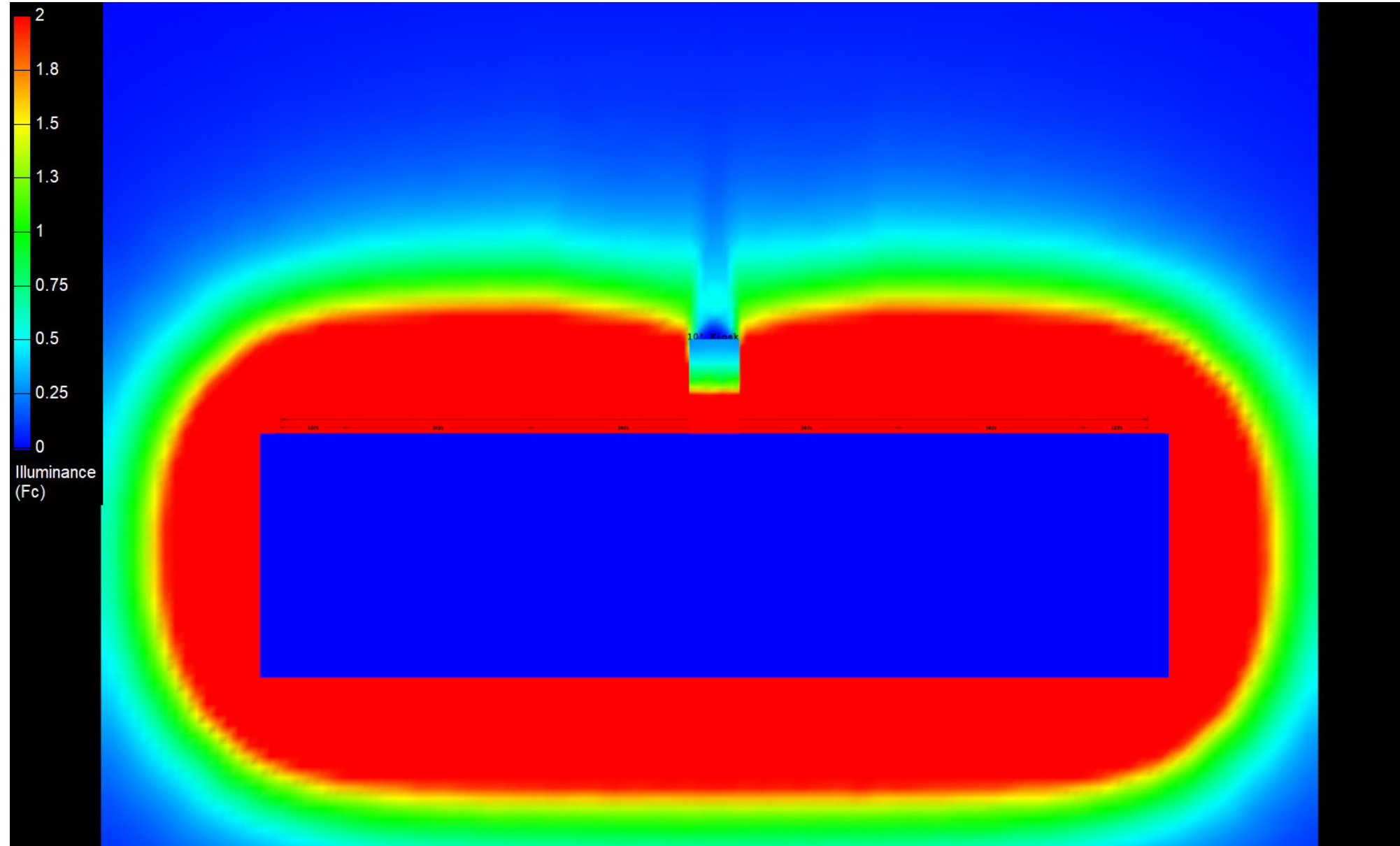

Canopy Style: 2+2+1+2+2 w/ Kiosk

Canopy Size: 43' x 160'

Initial Levels at grade and vertically on pumps.

(30) SCM-LED-08L-SC-50

Fixture Lumens: 7,983

Fixture Watts: 55.4

Lumens/Watt: 144

Mounting Height: 15'

Calculation Summary

Canopy Average: 23.05

Pump Average Inner: 12.80

Pump Average Outer: 10.06

Transition Average: N/A

Total Watts: 1662

Watts/sq.ft.: 0.24

Lumens/sq.ft. : 34.8

