

Canopy Style: 3+2+3 w/ Kiosk

Canopy Size: 78' x 92'

Initial Levels at grade and vertically on pumps.

(20) CRUS-SC-HO-50

Fixture Lumens: 19,071

Fixture Watts: 125

Lumens/Watt: 153

Mounting Height: 15'

Calculation Summary

Canopy Average: 37.88

Pump Average Inner: 17.90

Pump Average Outer: 26.34

Transition Average: N/A

Total Watts: 2500

Watts/sq.ft.: 0.35

Lumens/sq.ft. : 53.1

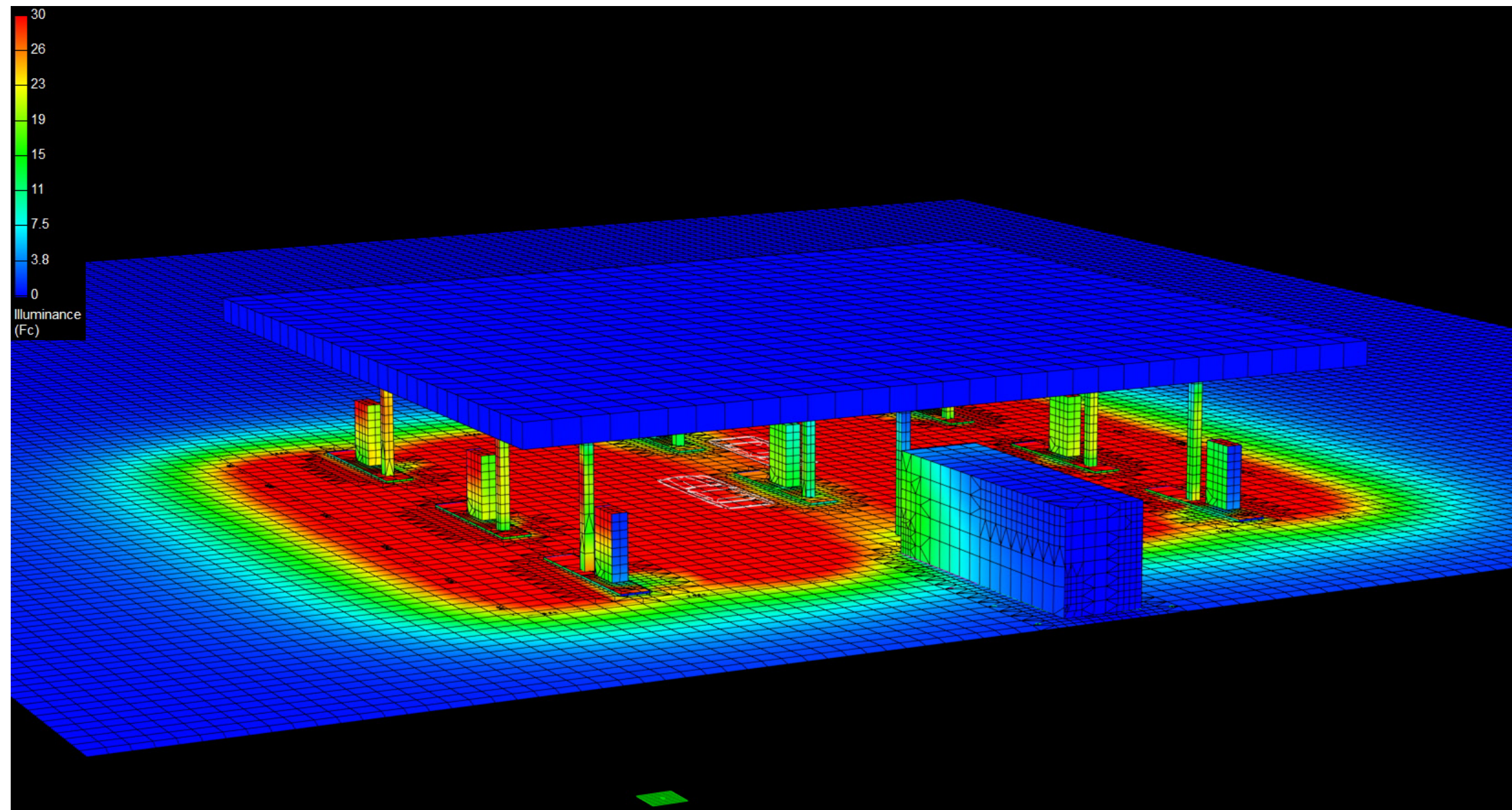

Canopy Style: 3+2+3 w/ Kiosk

Canopy Size: 78' x 92'

Initial Levels at grade and vertically on pumps.

(20) CRUS-SC-HO-50

Fixture Lumens: 19,071

Fixture Watts: 125

Lumens/Watt: 153

Mounting Height: 15'

Calculation Summary

Canopy Average: 37.88

Pump Average Inner: 17.90

Pump Average Outer: 26.34

Transition Average: N/A

Total Watts: 2500

Watts/sq.ft.: 0.35

Lumens/sq.ft. : 53.1

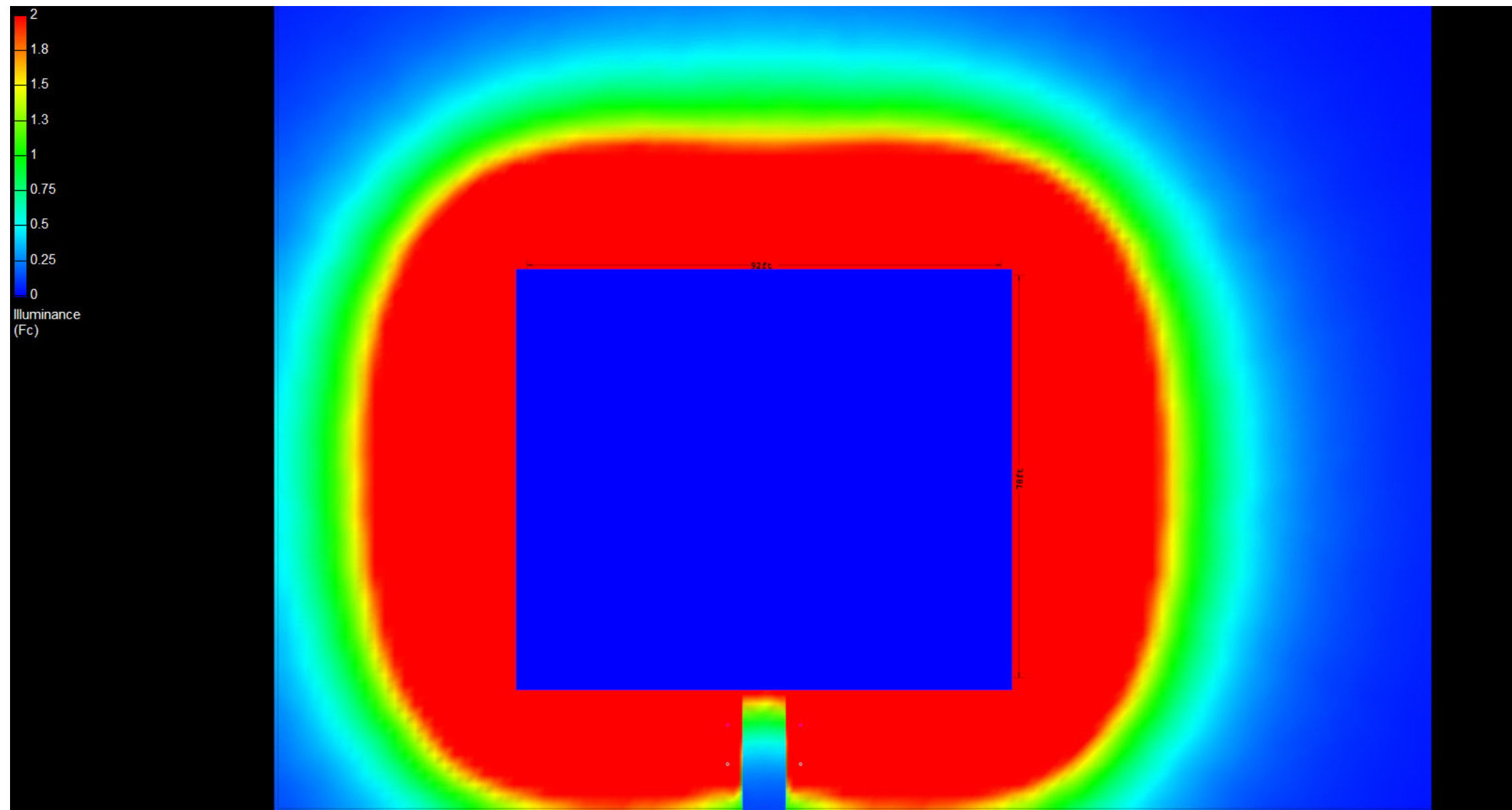

Canopy Style: 3+2+3 w/ Kiosk

Canopy Size: 78' x 92'

Initial Levels at grade and vertically on pumps.

(20) CRUS-SC-HO-50

Fixture Lumens: 19,071

Fixture Watts: 125

Lumens/Watt: 153

Mounting Height: 15'

Calculation Summary

Canopy Average: 37.88

Pump Average Inner: 17.90

Pump Average Outer: 26.34

Transition Average: N/A

Total Watts: 2500

Watts/sq.ft.: 0.35

Lumens/sq.ft. : 53.1

