

# Canopy Style: 2+2+1+2+2 w/ Kiosk

Canopy Size: 43' x 160'

Initial Levels at grade and vertically on pumps.

## (30) CRUS-SC-VLW-50

Fixture Lumens: 9,634

Fixture Watts: 60

Lumens/Watt: 156

Mounting Height: 15'

## Calculation Summary

Canopy Average: 26.74

Pump Average Inner: 15.13

Pump Average Outer: 11.66

Transition Average: N/A

Total Watts: 1800

Watts/sq.ft.: 0.26

Lumens/sq.ft. : 40.8

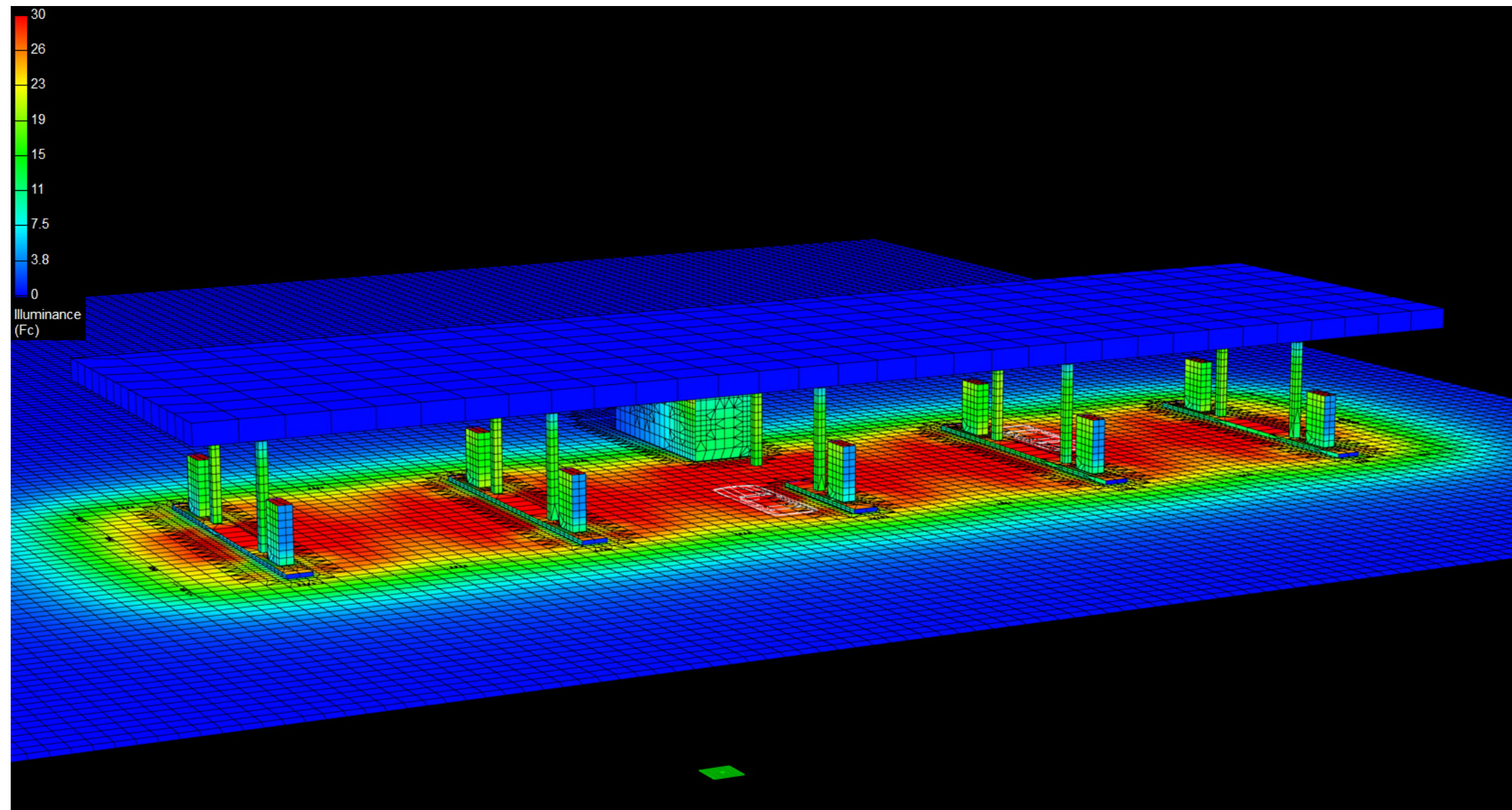

# Canopy Style: 2+2+1+2+2 w/ Kiosk

Canopy Size: 43' x 160'

Initial Levels at grade and vertically on pumps.

## (30) CRUS-SC-VLW-50

Fixture Lumens: 9,634

Fixture Watts: 60

Lumens/Watt: 156

Mounting Height: 15'

## Calculation Summary

Canopy Average: 26.74

Pump Average Inner: 15.13

Pump Average Outer: 11.66

Transition Average: N/A

Total Watts: 1800

Watts/sq.ft.: 0.26

Lumens/sq.ft. : 40.8

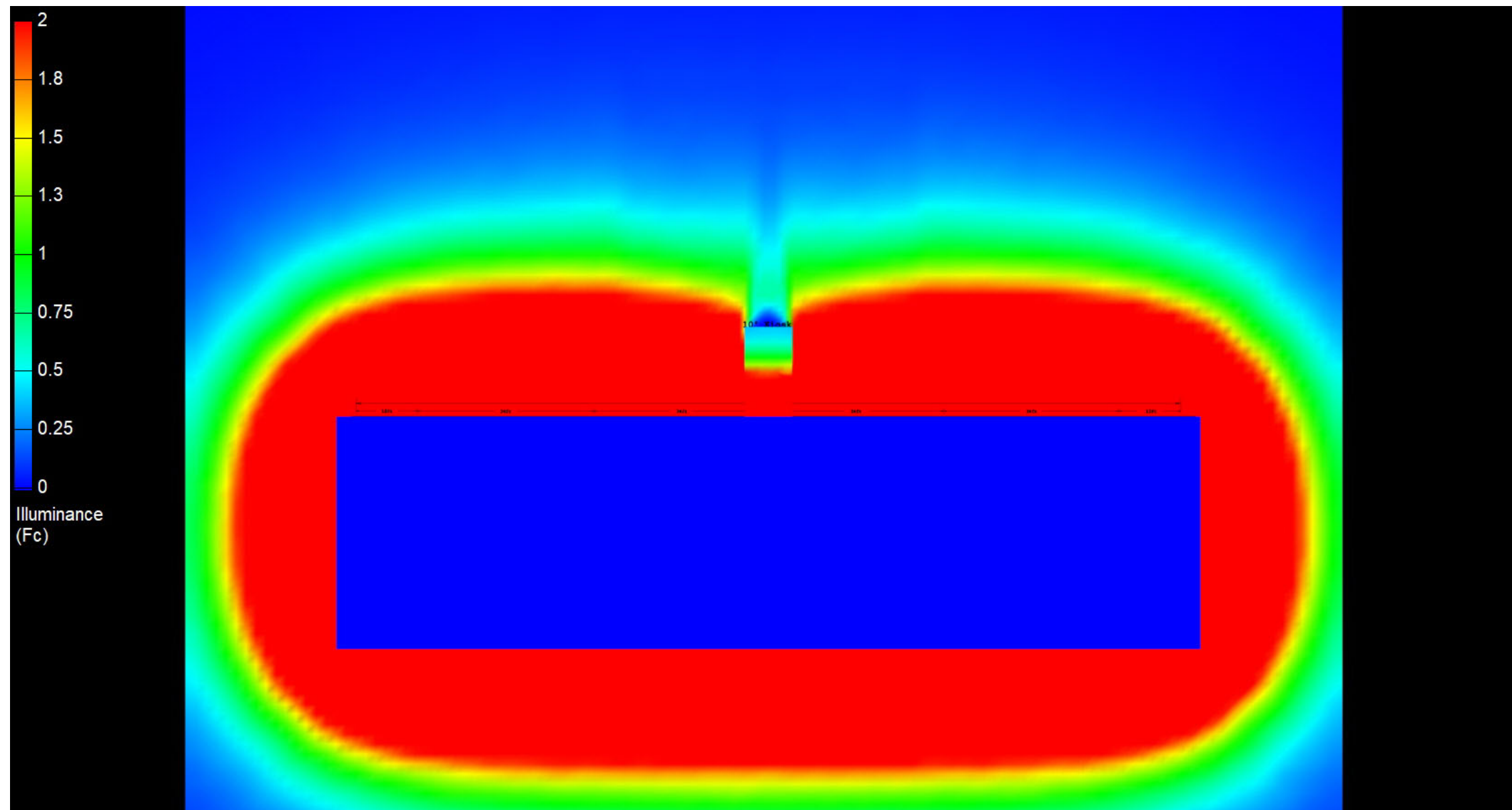

# Canopy Style: 2+2+1+2+2 w/ Kiosk

Canopy Size: 43' x 160'

Initial Levels at grade and vertically on pumps.

## (30) CRUS-SC-VLW-50

Fixture Lumens: 9,634

Fixture Watts: 60

Lumens/Watt: 156

Mounting Height: 15'

## Calculation Summary

Canopy Average: 26.74

Pump Average Inner: 15.13

Pump Average Outer: 11.66

Transition Average: N/A

Total Watts: 1800

Watts/sq.ft.: 0.26

Lumens/sq.ft. : 40.8

