

Canopy Style: 2+2+1+2+2 w/ Kiosk

Canopy Size: 43' x 160'

Initial Levels at grade and vertically on pumps.

(30) CRUS-SC-VHO-50

Fixture Lumens: 22,696

Fixture Watts: 152

Lumens/Watt: 149

Mounting Height: 15'

Calculation Summary

Canopy Average: 64.89

Pump Average Inner: 36.66

Pump Average Outer: 28.40

Transition Average: N/A

Total Watts: 4560

Watts/sq.ft.: 0.66

Lumens/sq.ft. : 99

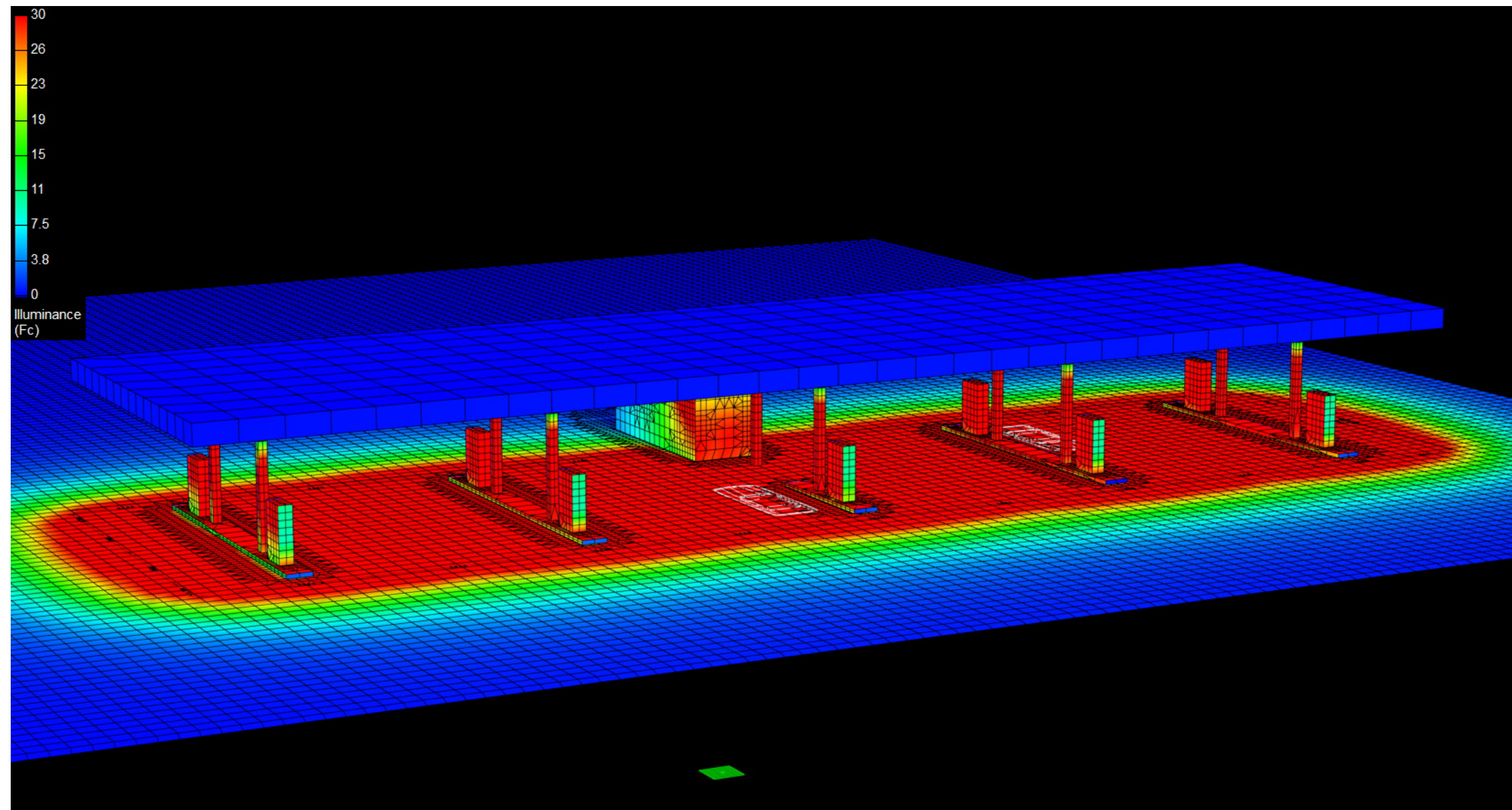

Canopy Style: 2+2+1+2+2 w/ Kiosk

Canopy Size: 43' x 160'

Initial Levels at grade and vertically on pumps.

(30) CRUS-SC-VHO-50

Fixture Lumens: 22,696

Fixture Watts: 152

Lumens/Watt: 149

Mounting Height: 15'

Calculation Summary

Canopy Average: 64.89

Pump Average Inner: 36.66

Pump Average Outer: 28.40

Transition Average: N/A

Total Watts: 4560

Watts/sq.ft.: 0.66

Lumens/sq.ft. : 99

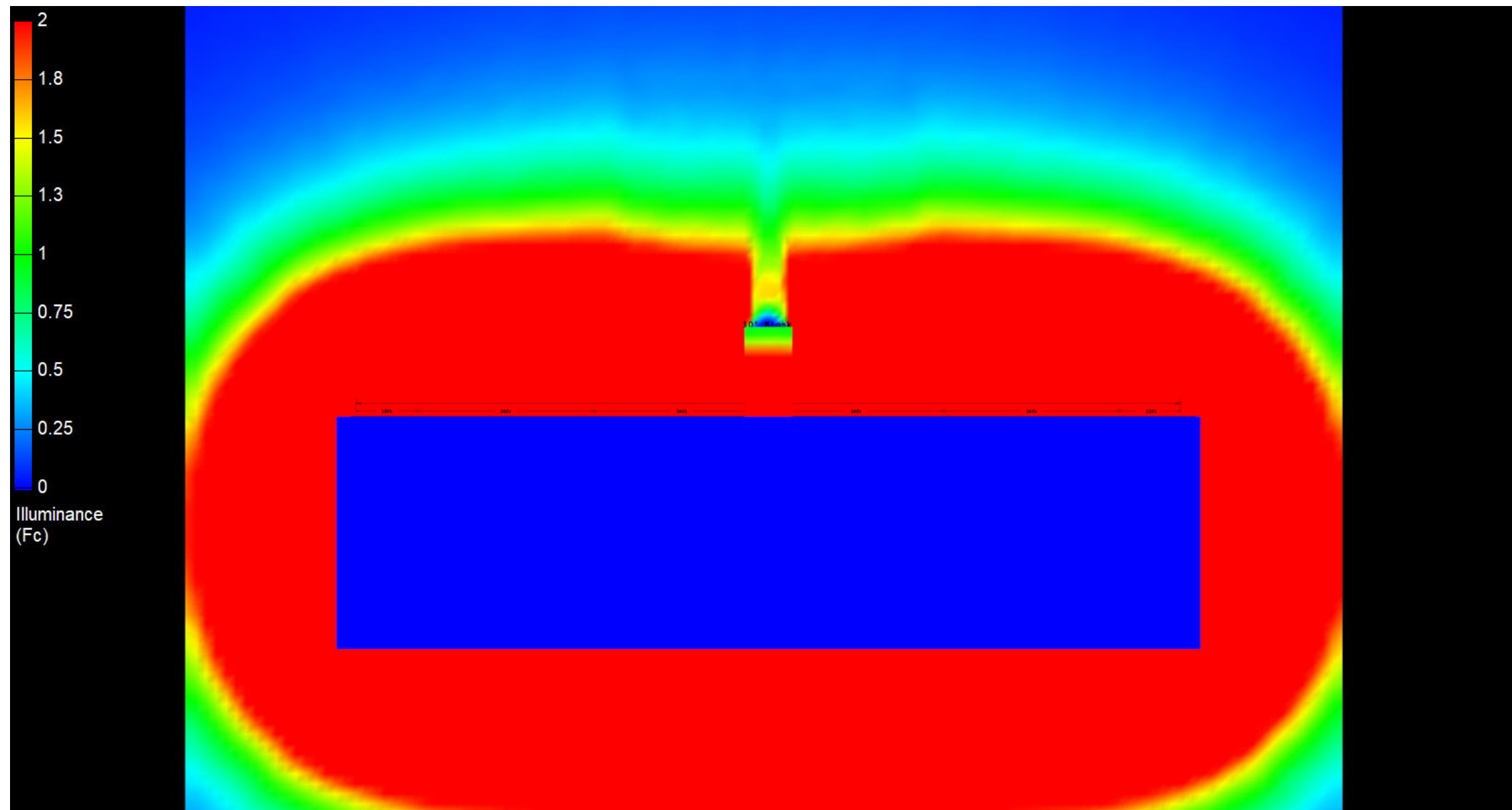

Canopy Style: 2+2+1+2+2 w/ Kiosk

Canopy Size: 43' x 160'

Initial Levels at grade and vertically on pumps.

(30) CRUS-SC-VHO-50

Fixture Lumens: 22,696

Fixture Watts: 152

Lumens/Watt: 149

Mounting Height: 15'

Calculation Summary

Canopy Average: 64.89

Pump Average Inner: 36.66

Pump Average Outer: 28.40

Transition Average: N/A

Total Watts: 4560

Watts/sq.ft.: 0.66

Lumens/sq.ft. : 99

