

Canopy Style: 2+2+1+2+2 w/ Kiosk

Canopy Size: 43' x 160'

Initial Levels at grade and vertically on pumps.

(30) CRUS-SC-LW-50

Fixture Lumens: 11,148

Fixture Watts: 73

Lumens/Watt: 153

Mounting Height: 15'

Calculation Summary

Canopy Average: 31.83

Pump Average Inner: 18.00

Pump Average Outer: 13.88

Transition Average: N/A

Total Watts: 2190

Watts/sq.ft.: 0.32

Lumens/sq.ft. : 48.6

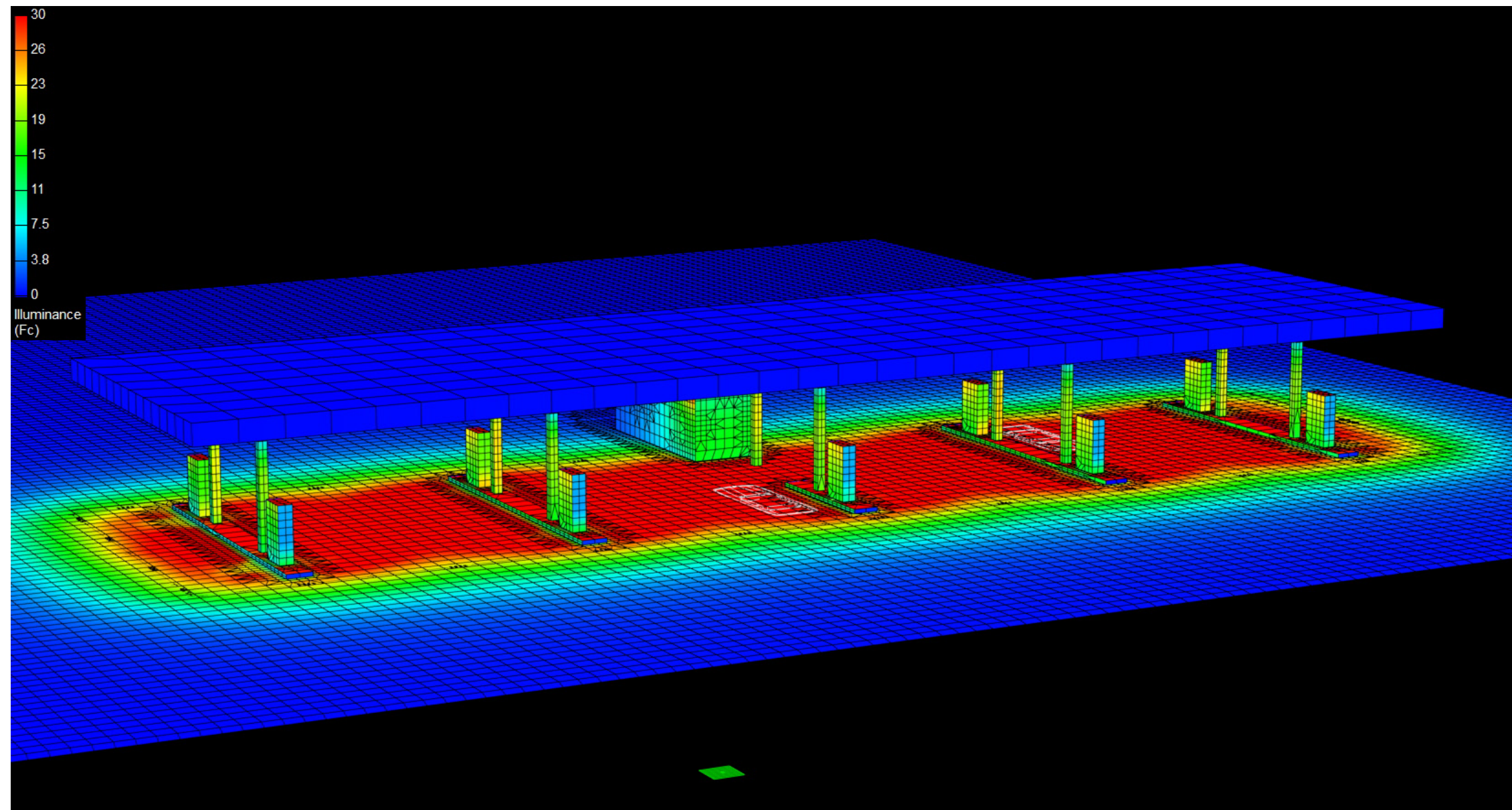

Canopy Style: 2+2+1+2+2 w/ Kiosk

Canopy Size: 43' x 160'

Initial Levels at grade and vertically on pumps.

(30) CRUS-SC-LW-50

Fixture Lumens: 11,148

Fixture Watts: 73

Lumens/Watt: 153

Mounting Height: 15'

Calculation Summary

Canopy Average: 31.83

Pump Average Inner: 18.00

Pump Average Outer: 13.88

Transition Average: N/A

Total Watts: 2190

Watts/sq.ft.: 0.32

Lumens/sq.ft. : 48.6

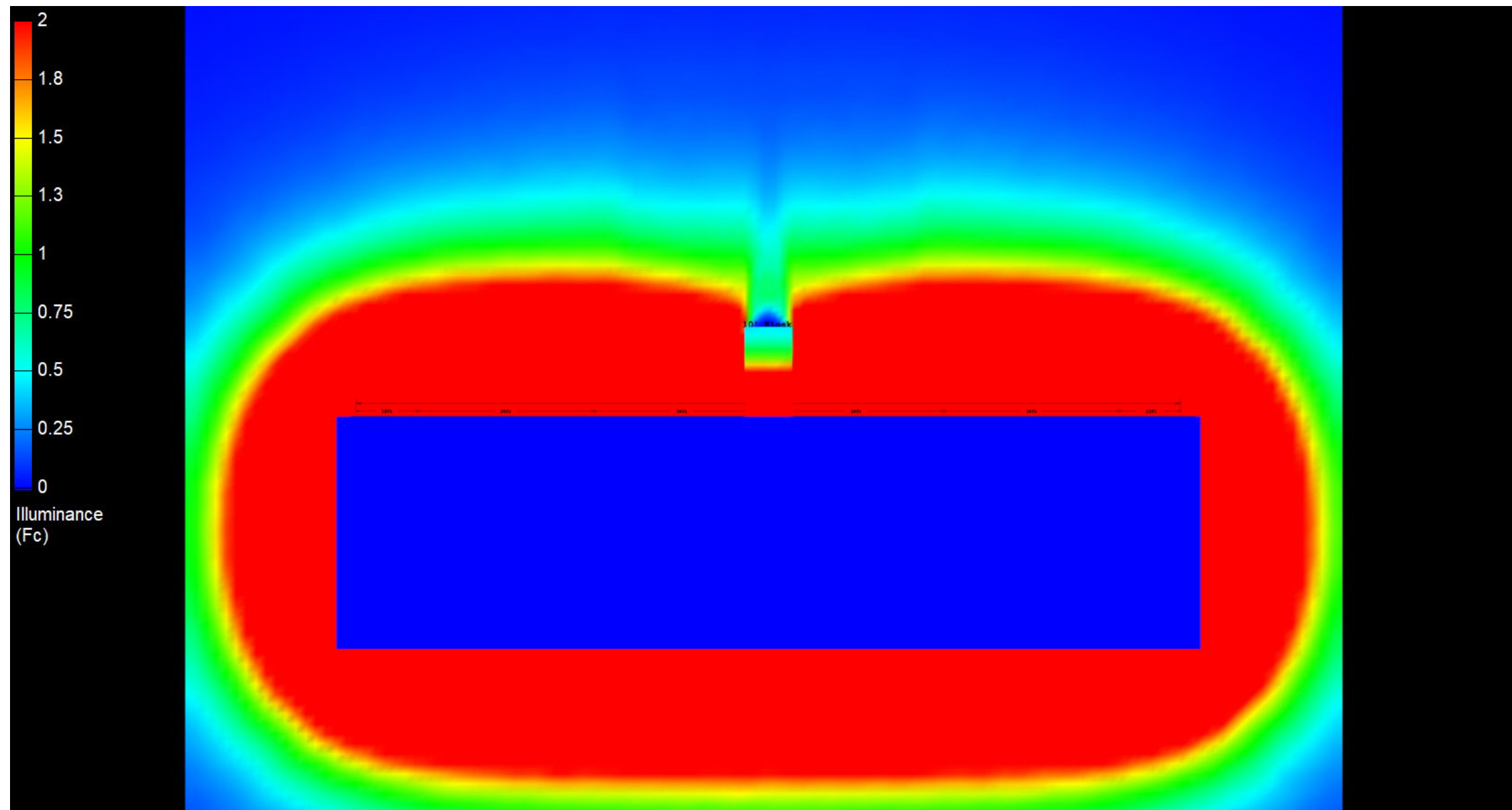

Canopy Style: 2+2+1+2+2 w/ Kiosk

Canopy Size: 43' x 160'

Initial Levels at grade and vertically on pumps.

(30) CRUS-SC-LW-50

Fixture Lumens: 11,148

Fixture Watts: 73

Lumens/Watt: 153

Mounting Height: 15'

Calculation Summary

Canopy Average: 31.83

Pump Average Inner: 18.00

Pump Average Outer: 13.88

Transition Average: N/A

Total Watts: 2190

Watts/sq.ft.: 0.32

Lumens/sq.ft. : 48.6

