



Walkway Canopy (WCP) LED Light Fixture



The LSI WCP Walkway Canopy fixture is designed to optimize LED life and light output. The WCP housing is hinged for quick and easy mounting and installation. It uses high-brightness, high-LED count technology, so more usable light output is produced while eliminating glare. Wireless controls are available via the LSI AirLink™ solution enabled by Synapse®. Manufactured in USA.

- Easy-access & install via hinged housing
- Performance options range from 3,000 to 10,000 lumens
- 3000K, 4000K and 5000K color temperatures available
- Low-profile design
- High-impact, scratch-resistant lens
- 5-Day Quick Ship
- LSI AirLink™ solution enabled by Synapse®



Walkway Canopy (WCP) LED Light Fixture

Easy Install



Step 1
Attach top housing to either mounting box or conduit hinges

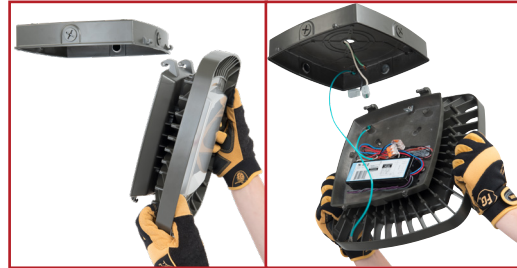

Step 2
Hang bottom housing to the top by connecting the hinges



Step 3
Wire fixture using provided quick connect connectors



Step 4
Simply close fixture and tighten two screws

Dimensions

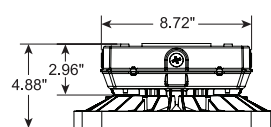
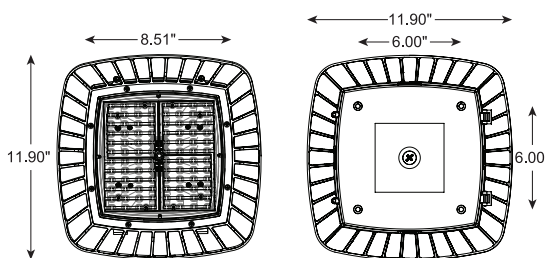

Standard Housing
(no battery backup)

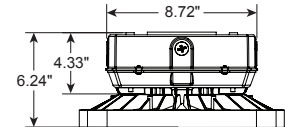

Deeper Housing
(required for battery backup)

*Assembled in USA by a USA workforce of USA and foreign parts using state-of-the-art equipment at our award-winning manufacturing facility.