

# ADVANTAGE ROUND HIGH BAY

## Installation Guide



SAVE THESE INSTRUCTIONS



## BEFORE YOU BEGIN

Read and follow all safety instructions

### **⚠ WARNING**

#### **RISK OF FIRE, EXPLOSION AND ELECTRICAL SHOCK**

- This product should be installed, inspected and maintained by a qualified electrician only, in accordance with the NEC (national Electric code) and all local codes.
- Turn off electrical power before inspection, installation or removal.
- Use only UL (or other NRTL) approved wire for input/output connections.
- Minimum size 18 AWG or 14 AWG for continuous runs.
- Make sure the supply voltage is the same as the rated voltage of the luminaire.
- Do not install in a hazardous atmosphere, except where the ambient temperature does not exceed the rated operating temperature of the fixture.
- Keep tightly closed when in operation.

### Prepare Electrical Wiring



#### Electrical Requirements

The LED driver must be supplied with the voltage specified on the product label and connected to an individual, properly grounded branch circuit protected by a 20-ampere circuit breaker. Use min. 75°C supply.



#### Grounding Instructions

The grounding and bonding of the overall system shall be done in accordance with NEC Article 600 and local codes.

# ADVANTAGE ROUND HIGH BAY

## Installation Guide



### Tools Required:

Wire Strippers  
Wire Cutters  
#2 Phillips Screwdriver

1. Before starting, ensure that the supply power is shut off.
2. Unpack the fixture and ensure that there are no damaged or missing parts.
3. FIXTURE MOUNTING:

Mount the fixture from one of the options:

- a. Hook – Install the hook to the fixture and tighten the provided screw. Remove the locking screw from the fixture's hook and mount on a chain, cable or eye bolt (supplied by others). Secure it by reinstalling the locking screw once the fixture is attached. (Fig 1)
- b. Eye Bolt (check the accessories table) – Install the eye bolt to the fixture and tighten the provided screw. Use a support chain or cable with a carabiner, S hook, eye hook or spring clip (supplied by others) and attach to the fixture's eye bolt. (Fig 2)
- c. Pendant Adaptor (check the accessories table) – Install the adaptor to the fixture and tighten the provided screw. Use a ceiling mounted  $\frac{3}{4}$ " NPT conduit (supplied by others) and attach to the fixture's pendant adaptor. Secure with the included screw. (Fig 3)
- d. Surface Bracket (check the accessories table) – Mount the surface bracket to the junction box using the provided screws. Install the fixture to the bracket and tighten the provided screw. (Fig 4)

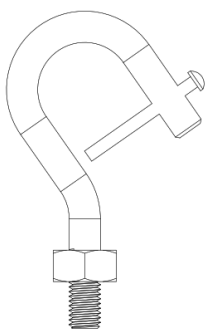

HOOK  
Fig 1

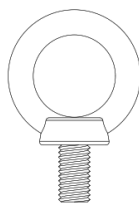

RING BOLT  
Fig 2

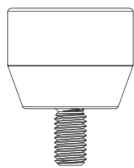

PENDANT ADAPTOR  
Fig 3

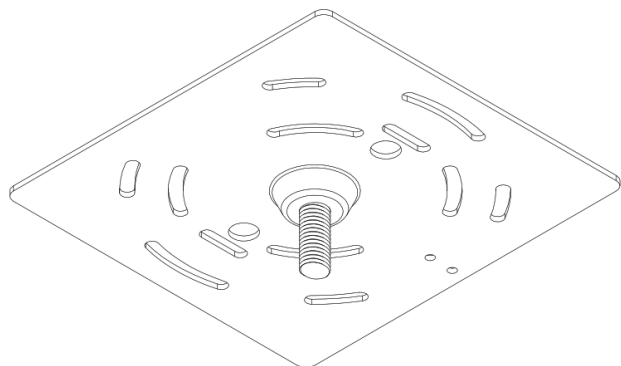

SURFACE MOUNT KIT  
Fig 4

**IMPORTANT:** The mounting surface and hardware must be rated to support the weight of the fixture.

# ADVANTAGE ROUND HIGH BAY

## Installation Guide



### 4. CCT AND WATTAGE ADJUSTIBILITY:

To adjust the wattage and CCT, remove the plug located on the side. Adjust the switch as required. Replace the plug once done (Fig 5).

### 5. OPTIONAL SENSOR:

To install the optional 'Plug & Play' sensor (check accessory table), remove the sensor plug located at the bottom of the fixture. Thread the sensor and connect the sensor via the 3.5mm jack (Fig 6).

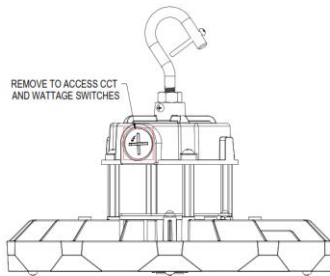

Fig 5

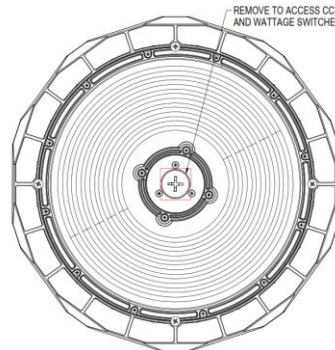

Fig 6

### 6. OPTIONAL REFRACTOR

#### a. ARB 9: Loosen the screws on the fixture as shown in Fig 7.

Place the adaptor (check accessory table) keyhole slots onto the screw and turn the adaptor clockwise to engage the screws into the keyhole slot (Fig 7).

Tighten the screw to lock the adaptor in place.

Loosen the screws on the adaptor as shown in Fig 7.

Place the reflector (check accessory table) keyhole slots onto the screw and turn the reflector clockwise to engage the screws into the keyhole slot (Fig 7).

Tighten the screws to lock the reflector in place.

#### b. ARB 12: Loosen the screws on the fixture as shown in Fig 8.

Place the reflector (check accessory table) keyhole slots onto the screw and turn the reflector clockwise to engage the screws into the keyhole slot (Fig 8).

Tighten the screws to lock the reflector in place.

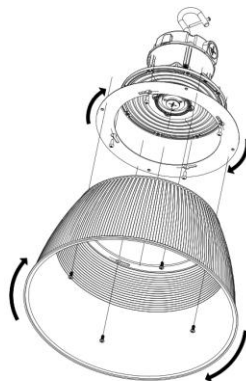

ARB 9  
Fig 7

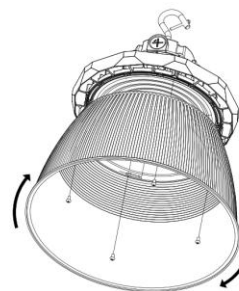

ARB 12  
Fig 8

# ADVANTAGE ROUND HIGH BAY

## Installation Guide



### 7. Optional EM:

Mount the EM and fixture from one of the options:

- a. Hook – Install the hook to the EM and tighten the provided screw. Remove the locking screw from the EM’s hook and mount on a chain, cable or eye bolt (supplied by others). Secure it by reinstalling the locking screw once the EM and fixture is attached.
  - b. Eye Bolt (check the accessories table) – Install the eye bolt to the EM and tighten the provided screw. Use a support chain or cable with a carabiner, S hook, eye hook or spring clip (supplied by others) and attach to the EM’s eye bolt.
8. Once mounted, run the fixture/EM cord to the junction box and connect to the AC branch circuit using wiring nuts according to the wiring diagram (Fig 9/10)
  9. Restore power and ensure the fixture functions properly.

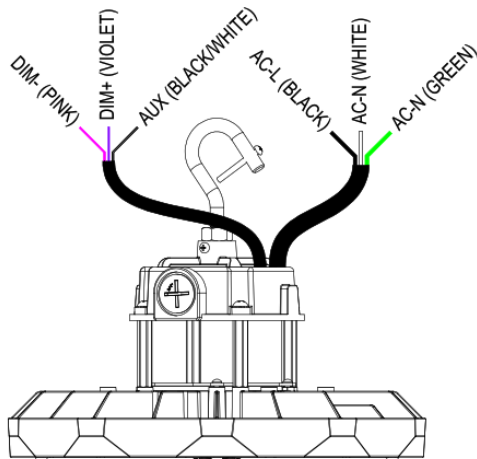

STANDARD  
Fig 9

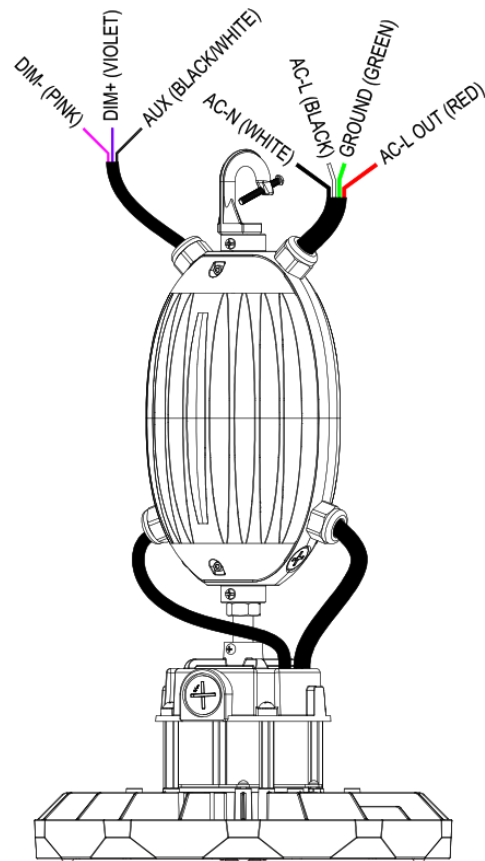

WITH EM  
Fig 10