



Catalog #: _____ Project: _____

Prepared By: _____ Date: _____ Type: _____

Slice Wall Sconce (XLCW)

Outdoor Wall Sconce



OVERVIEW

Lumen Range	3,000 - 5,000
Wattage Range	41 - 56
Efficacy Range (LPW)	85 - 94
Weight lbs(kg)	10 (4.5)

QUICK LINKS

[Ordering Guide](#)[Performance](#)[Photometrics](#)[Dimensions](#)

FEATURES & SPECIFICATIONS

Construction

- Fabricated aluminum housing with distinctive rectangular shape.
- Mounting hardware is stainless steel or electro-zinc plated.
- Supply conductors sealed with molded EPDM bushing.
- Fixtures are finished with LSI's DuraGrip® polyester powder coat finishing process. The DuraGrip finish withstands extreme weather changes without cracking or peeling. Other standard LSI finishes available. Consult factory.
- Shipping weight: 10 lbs in carton.

Optical System

- Clear tempered optical-grade flat glass lens sealed to the aluminum optic housing creates an IP65 rated optical assembly
- Pressure stabilizing breather allows super-tight protection while preventing cycling from building up internal pressures and vacuums that stress optical unit seals.
- Zero uplight.
- Available in 5000K and 4000K color temperatures per ANSI C78.377. Minimum CRI of 70.

Electrical

- DIM - 0-10 volt dimming enabled with LSI wireless controls.
- Standard Universal Voltage (120-277 Vac) Input 50/60 Hz.
- Operating temperature: -40°C to +50°C (-40°F to +122°F)
- Two-stage surge protection (including separate surge protection built into electronic driver) meets IEEE C62.41.2-2002, Location Category C.
- Prewired leads extended out the back of the unit through a rubber grommet eliminating the need to open the fixture to make wiring connections.

Installation

- Galvanized-steel universal wall mounting plate easily mounts directly to 4" octagonal or square junction box.
- EPDM gasket is supplied to be installed between mounting plate and junction box, sealing junction box from entrance of water.
- The galvanized-steel universal plate allows the fixture to be suspended while making wire connections.

Warranty

- LSI luminaires carry a 5-year limited warranty. Refer to <https://www.lsiindustries.com/resources/terms-and-warranty.aspx> for more information.

Listings

- Listed to UL 1598 and UL 8750.
- Meets Buy American Act requirements.
- Suitable for wet locations.
- IP65 rated optical chamber





Slice Wall Sconce (XLCW)

ORDERING GUIDE

[Back to Quick Links](#)TYPICAL ORDER EXAMPLE: **XLCW FT LED HO CW UE BRZ PCI120**

Prefix	Distribution	LED Technology	Output	Color Temperature	Voltage	Finish	Options
XLCW - Slice Wall Sconce	FT - Type 4 Forward Throw S - Symmetrical	LED	SS - Super Saver (3,000 lms) HO - Super Saver (5,000 lms)	CW - 5,000K CCT - 70 CRI NW - 4,000K CCT - 70 CRI ¹	UE - Universal Voltage (120-277V)	BLK - Black BRZ - Dark Bronze WHT - White	(Blank) - None Wireless Controls System DIM - 0-10v Dimming leads extended to housing exterior PCI120 - 120V PCI208-277 - 208 - 277V

ACCESSORY ORDERING INFORMATION

Description	Order Number
XLCW SW BLK - Surface Wiring Box (available in black only)	356915BLK
10' Linear Bird Spike Kit (3' Recommended per Luminaire)	751632

PERFORMANCE

[Back to Quick Links](#)

DELIVERED LUMENS*									
Lumen Package	Distribution	CRI	4000K CCT			5000K CCT			Wattage
			Delivered Lumens	Efficacy	BUG Rating	Delivered Lumens	Efficacy	BUG Rating	
SS	FT	65	3379	85	B1-U0-G1	3759	91	B1-U0-G1	41
	S		3512	85	B2-U0-G1	3805	92	B2-U0-G1	
HO	FT		4621	85	B1-U0-G1	5113	91	B1-U0-G1	56
	S		4856	87	B2-U0-G1	5251	94	B2-U0-G1	

*LEDs are frequently updated therefore values are nominal.

ELECTRICAL DATA*				
Output	120V	208V	240V	277V
SS	0.34	0.20	0.17	0.15
HO	0.47	0.27	0.23	0.20

*Electrical data at 25C (77F). Actual wattage may differ by +/-10%.





Slice Wall Sconce (XLCW)

PRODUCT DIMENSIONS

[Back to Quick Links](#)

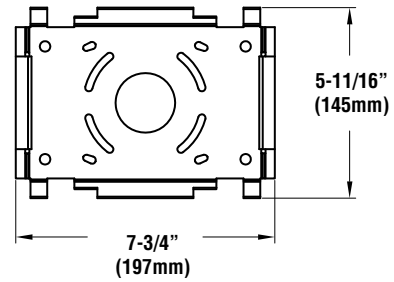
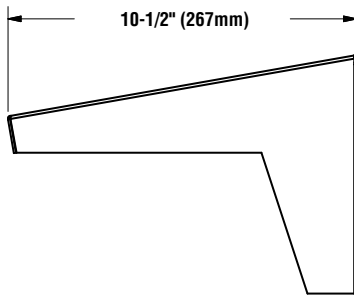
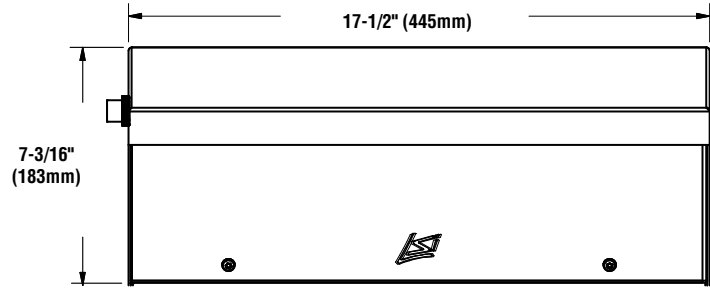
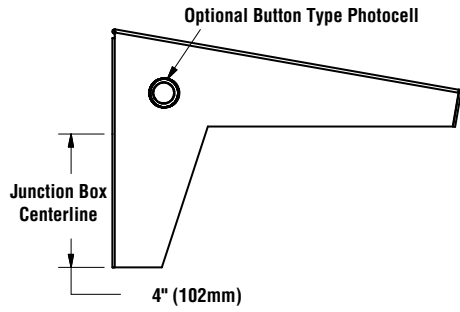

Universal Mounting Plate

